

FOR CONTINUATION REFER L_1006

FOR CONTINUATION REFER L_1006

VHR 1500

VICTORIAN ARTS CENTRE
THEATRES BUILDING

VHR 2378

FORWARD SURGE

VHR 1500

VICTORIAN ARTS CENTRE
HAMER HALL

VHR 2359

ST KILDA ROAD

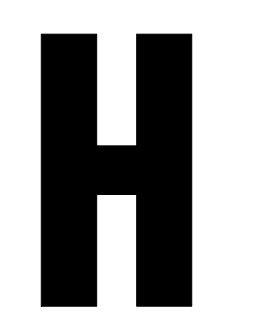
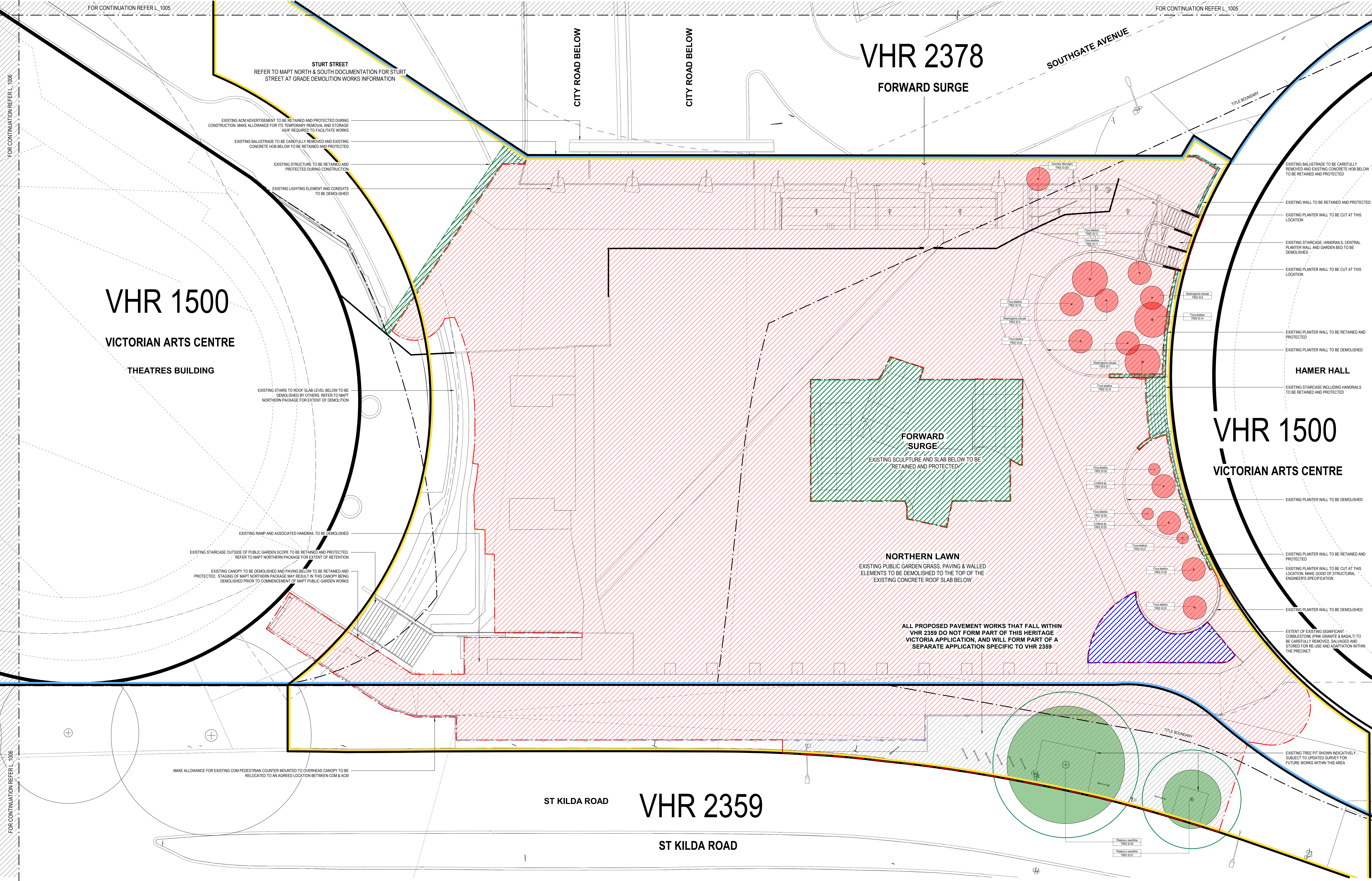

LEAD CONSULTANT
Hassell
Hassell LTD ABN 24 007 711 435
61 Little Collins Street
Melbourne VIC 3000 Australia
T +61 3 8102 3000
melbourne@hassell.com.au
Architect Directors VIC:
Mark Loughran 15052
Brendan Kelly 23624
Liz Westgate 00113

CONSULTANT TEAM
SO-IL **WSP** **Super Bloom** **PHILIP CHUN** **VIPAC**
NORTHROP **WATERPROOFING** **PURCELL** **MGAC**
G & M Connellan Consultants **JAMES HITCHMOUGH** **Nigel Dunnett**

CLIENT
DEVELOPMENT VICTORIA

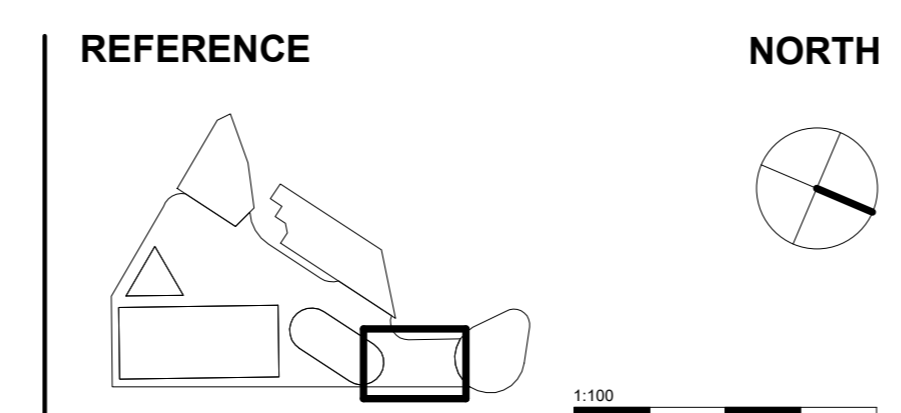

NOTES

1. Do not scale drawing. Written dimensions govern
2. All dimensions are in millimeters unless noted otherwise
3. All dimensions shall be verified on site before proceeding with the work. Hassell shall be notified in writing of any discrepancies.
4. This drawing must be read in conjunction with all relevant contracts, specifications and drawings.

This drawing is an uncontrolled copy. Unless noted otherwise
© Copyright of this drawing is vested in Hassell Ltd.

REV	DESCRIPTION	DATE
A	FOR COORDINATION	09/02/2024
B	FOR COORDINATION	01/03/2024
C	DRAFT DETAIL DESIGN	30/04/2024
D	DETAIL DESIGN	06/06/2024
E	FOR HERITAGE APPROVAL	15/07/2024
F	FOR HERITAGE APPROVAL	13/09/2024

CLIENT
DEVELOPMENT VICTORIA

PROJECT
LAAK BOORNAP PUBLIC GARDEN
MELBOURNE ARTS PRECINCT
TRANSFORMATION

STATUS
DETAIL DESIGN

DRAWING TITLE
ZONE 07 - EXISTING, DEMOLITION,
SALVAGED AND RE-USE PLAN

REVIEWED
SQ

APPROVED
BD

DRAWING NO.
L_1007

SCALE @ A0
1 : 100

PROJECT NO.
013922

REV NO.
F

WORKS WITHIN THIS AREA ARE
SUBJECT TO A FUTURE HERITAGE
APPLICATION AND DOES NOT FORM
PART OF THIS HERITAGE APPLICATION

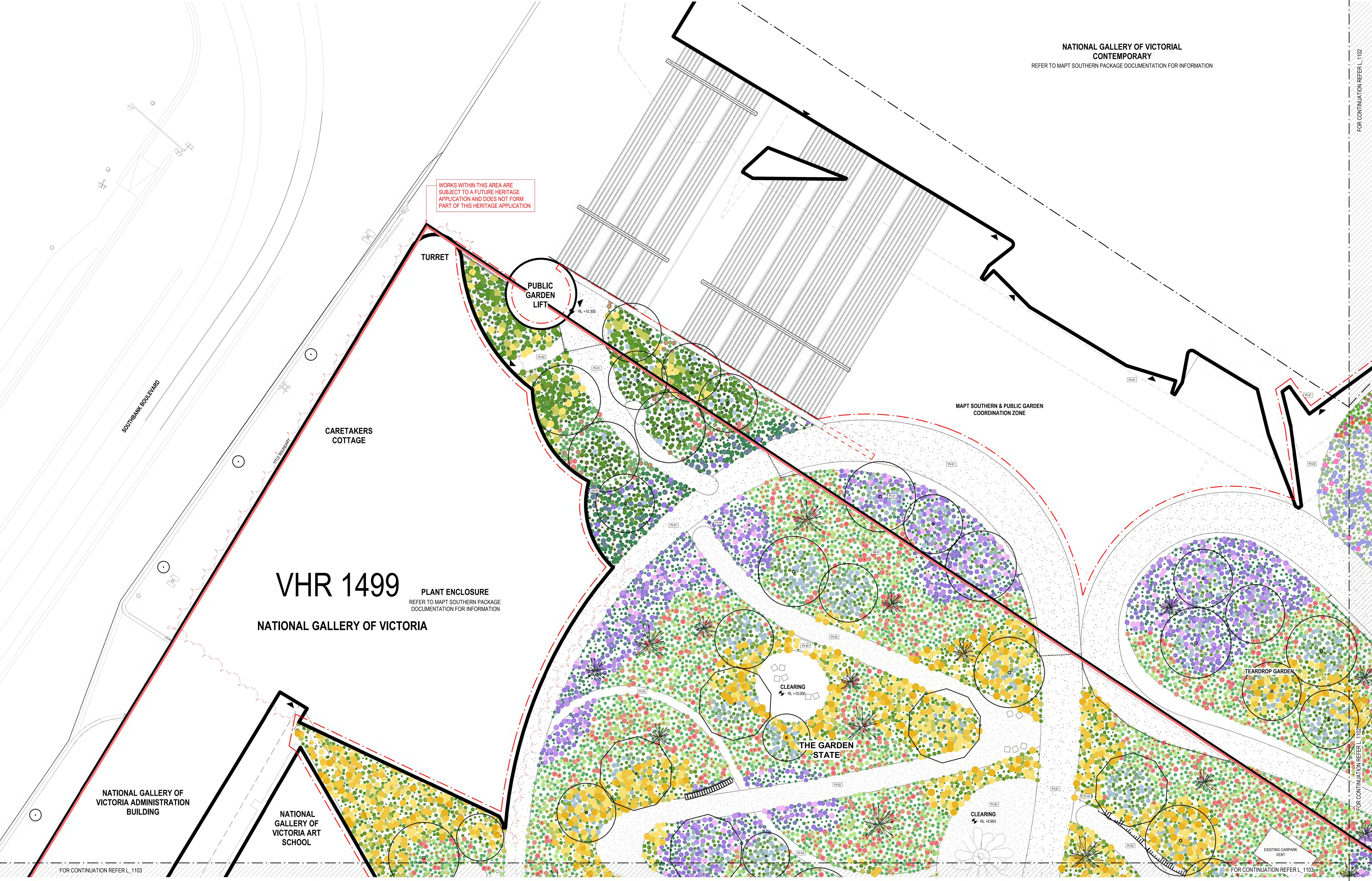

VHR 1499
NATIONAL GALLERY OF VICTORIA
PLANT ENCLOSURE
REFER TO MAPT SOUTHERN PACKAGE
DOCUMENTATION FOR INFORMATION

NATIONAL GALLERY OF
VICTORIA ADMINISTRATION
BUILDING

NATIONAL
GALLERY OF
VICTORIA ART
SCHOOL

MAPT SOUTHERN & PUBLIC GARDEN
COORDINATION ZONE

CLEARING
RL +10.000

THE GARDEN
STATE

TEARDROP GARDEN

CLEARING
RL +9.993

EXISTING CARPARK
VENT

FOR CONTINUATION REFER L_1103

FOR CONTINUATION REFER L_1103

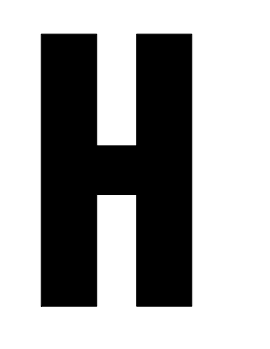

LEAD CONSULTANT
Hassell
Hassell LTD ABN 24 007 711 435
61 Little Collins Street
Melbourne VIC 3000 Australia
T +61 3 8102 3000
melbourne@hassell.com.au
Architect Directors VIC:
Mark Loughran 16202
Brendan Kelly 23624
Liz Westgarth 00113

CONSULTANT TEAM
SO-IL **wsp** **Super Bloom** **PHILIP CHUN** **VIPAC**
NORTHROP **WATERPROOFING** **STEWARTSON WINNERS** **PURCELL** **MGAC**
G & M Connellan Consultants **JAMES HITCCHOUGH** **Nigel Dunnett**

CLIENT
DEVELOPMENT VICTORIA

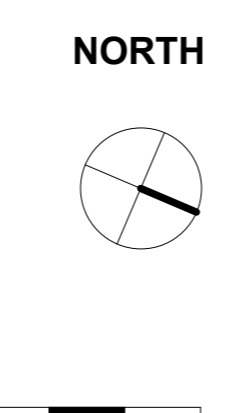
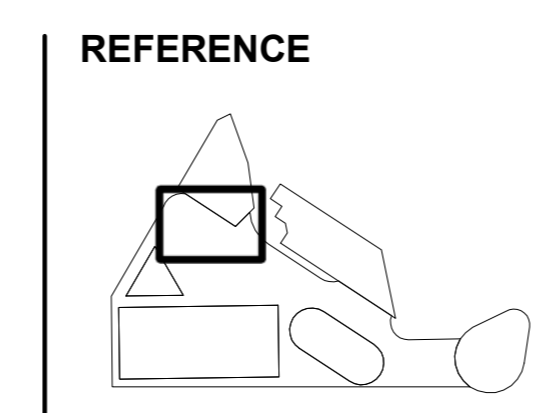

NOTES
1. Do not scale drawing. Written dimensions govern
2. All dimensions are in millimeters unless noted otherwise
3. All dimensions shall be verified on site before proceeding with the work. Hassell shall be notified in writing of any discrepancies.
4. This drawing must be read in conjunction with all relevant contracts, specifications and drawings
This drawing is an uncontrolled copy. Unless noted otherwise
© Copyright of this drawing is vested in Hassell Ltd.

REV	DESCRIPTION	DATE
A	FOR COORDINATION	09/02/2024
B	FOR COORDINATION	01/03/2024
C	DRAFT DETAIL DESIGN	30/04/2024
D	DETAIL DESIGN	06/06/2024
E	FOR HERITAGE APPROVAL	15/07/2024
F	FOR HERITAGE APPROVAL	13/09/2024

CLIENT
DEVELOPMENT VICTORIA
PROJECT
LAAK BOORNAP PUBLIC GARDEN
MELBOURNE ARTS PRECINCT
TRANSFORMATION

STATUS
DETAIL DESIGN
DRAWING TITLE
ZONE 01 - GENERAL ARRANGEMENT
PLAN

REVIEWED
SQ
APPROVED
BD
DRAWING NO.
L_1101
SCALE @ A0
1 : 100
PROJECT NO.
013922
REV NO.
F

FOR CONTINUATION REFER L_1101

FOR CONTINUATION REFER L_1101

FOR CONTINUATION REFER L_1104

FOR CONTINUATION REFER L_1104

NATIONAL GALLERY OF VICTORIAL CONTEMPORARY
REFER TO MAP1 SOUTH PACKAGE DOCUMENTATION FOR INFORMATION

KANARAH STREET (BELOW)

FAWING STREET

PRIMROSE POTTER AUSTRALIAN BALLET CENTRE

VHR 1499

NATIONAL GALLERY OF VICTORIA

WATER FEATURE

FLOWERING SLOPES

TEARDROP

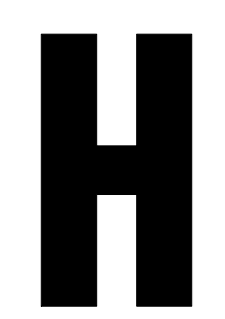

LEAD CONSULTANT

Hassell

Hassell LTD ABN 24 007 711 435
61 Little Collins Street
Melbourne Vic 3000 Australia
T +61 3 8102 3000
melbourne@hassell.com.au
Architect Directors VIC:
Alan Loughran 15022
Brendan Kelly 23045
Liz Westgarth 00113

CONSULTANT TEAM

SO-IL WSP Super Bloom PHILIP CHUN VIPAC

NORTHROP WATERPROOFING STEPHEN WILKINSON PURCELL MGAC

G & M Connellan Consultants JAMES HITCHMOUGH Nigel Dunnett

CLIENT



REFERENCE

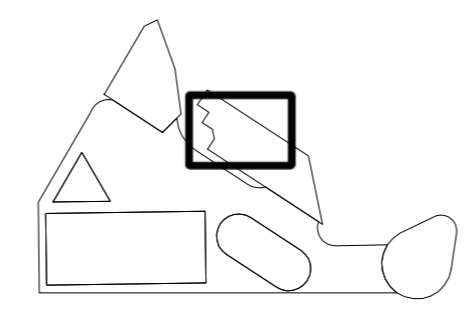

NORTH

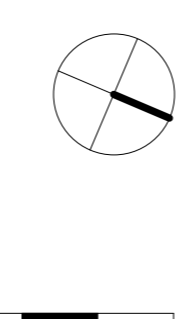

NOTES

1. Do not scale drawing. Written dimensions govern
 2. All dimensions are in millimeters unless noted otherwise
 3. All dimensions shall be verified on site before proceeding with the work. Hassell shall be notified in writing of any discrepancies.
 4. This drawing must be read in conjunction with all relevant contracts, specifications and drawings.
- This drawing is an uncontrolled copy. Unless noted otherwise
© Copyright of this drawing is vested in Hassell Ltd.

REV DESCRIPTION

A	FOR COORDINATION
B	FOR COORDINATION
C	DRAFT DETAIL DESIGN
D	DETAIL DESIGN
E	FOR HERITAGE APPROVAL
F	FOR HERITAGE APPROVAL

DATE

09/02/2024
01/03/2024
30/04/2024
06/06/2024
15/07/2024
13/09/2024

CLIENT
DEVELOPMENT VICTORIA

PROJECT
LAAK BOORNDAP PUBLIC GARDEN
MELBOURNE ARTS PRECINCT
TRANSFORMATION

STATUS
DETAIL DESIGN

DRAWING TITLE
ZONE 02 - GENERAL ARRANGEMENT
PLAN

REVIEWED
SQ

APPROVED
BD

DRAWING NO.
L_1102

SCALE @ A0
1 : 100

PROJECT NO.
013922

REV NO.
F

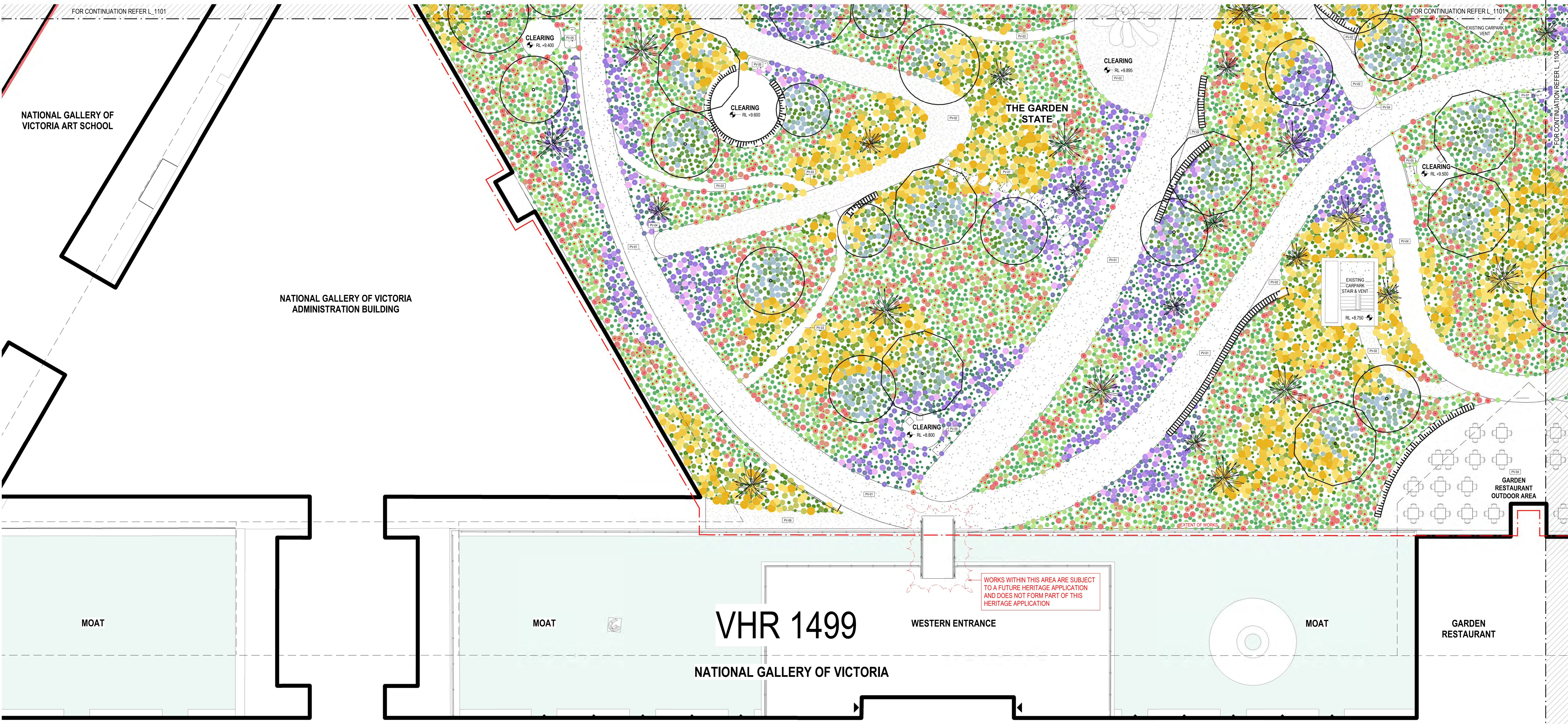

VHR 1499

WORKS WITHIN THIS AREA ARE SUBJECT TO A FUTURE HERITAGE APPLICATION AND DOES NOT FORM PART OF THIS HERITAGE APPLICATION

NATIONAL GALLERY OF VICTORIA INTERNATIONAL

NATIONAL GALLERY OF VICTORIA ART SCHOOL

NATIONAL GALLERY OF VICTORIA ADMINISTRATION BUILDING

THE GARDEN STATE

GARDEN RESTAURANT OUTDOOR AREA

MOAT

MOAT

WESTERN ENTRANCE

MOAT

GARDEN RESTAURANT

NATIONAL GALLERY OF VICTORIA

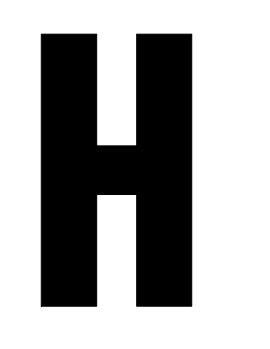

LEAD CONSULTANT

Hassell

Hassell LTD ABN 24 007 711 435
61 Little Collins Street
Melbourne VIC 3000 Australia
T +61 3 8102 3000
melbourne@hassell.com.au
Architect Directors VIC:
Mark Loughran 19202
Brendan Kelly 20602
Liz Westgate 00113

CONSULTANT TEAM

SO-IL **wsp** **Super Bloom** **PHILIP CHUN** **VIPAC**

NORTHROP **WATERPROOFING** **STEWART WARRING** **PURCELL** **MGAC**

G & M Connellan Consultants **JAMES HITCHMOUGH** **Nigel Dunnett**

CLIENT

DEVELOPMENT VICTORIA

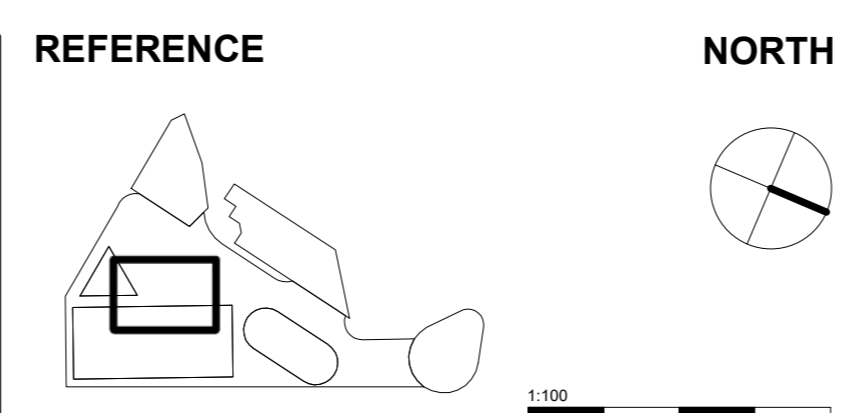

NOTES

1. Do not scale drawing. Written dimensions govern
2. All dimensions are in millimeters unless noted otherwise
3. All dimensions shall be verified on site before proceeding with the work. Hassell shall be notified in writing of any discrepancies.
4. This drawing must be read in conjunction with all relevant contracts, specifications and drawings.

This drawing is an uncontrolled copy. Unless noted otherwise
© Copyright of this drawing is vested in Hassell Ltd.

REV	DESCRIPTION	DATE
A	FOR COORDINATION	09/02/2024
B	FOR COORDINATION	01/03/2024
C	DRAFT DETAIL DESIGN	30/04/2024
D	DETAIL DESIGN	08/06/2024
E	FOR HERITAGE APPROVAL	15/07/2024
F	FOR HERITAGE APPROVAL	13/09/2024

CLIENT
DEVELOPMENT VICTORIA

PROJECT
LAAK BOORNAP PUBLIC GARDEN
MELBOURNE ARTS PRECINCT
TRANSFORMATION

STATUS
DETAIL DESIGN

DRAWING TITLE
ZONE 03 - GENERAL ARRANGEMENT
PLAN

REVIEWED
SQ

APPROVED
BD

DRAWING NO.
L_1103

SCALE @ A0
1 : 100

PROJECT NO.
013922

REV NO.
F

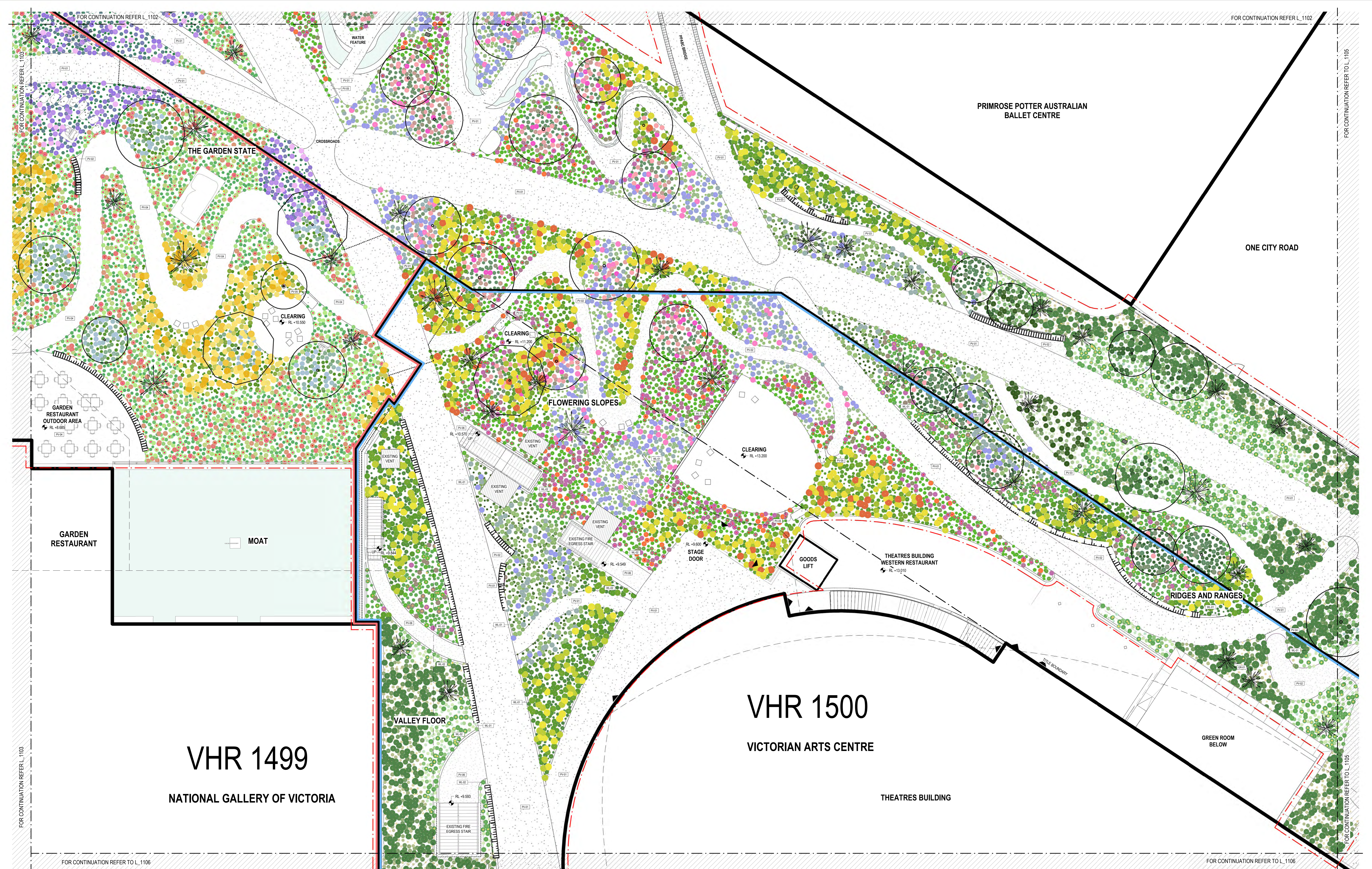



LEAD CONSULTANT



Hassell LTD ABN 24 007 711 435
61 Little Collins Street
Melbourne VIC 3000 Australia
T +61 3 8102 3000
melbourne@hassell.com.au
Architect Directors VIC
Mark Loughran 15252
Brendan Kelly 23524
Liz Westgarth 00113

CONSULTANT TEAM









G & M Connellan Consultants
JAMES HITCHMOUGH
Nigel Dunnett

CLIENT

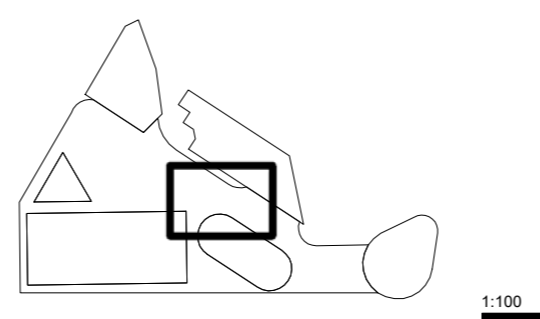

DEVELOPMENT VICTORIA

REFERENCE



NORTH

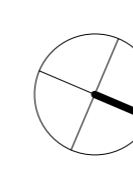

NOTES

1. Do not scale drawing. Written dimensions govern
2. All dimensions are in millimeters unless noted otherwise
3. All dimensions shall be verified on site before proceeding with the work. Hassell shall be notified in writing of any discrepancies.
4. This drawing must be read in conjunction with all relevant contracts, specifications and drawings.

This drawing is an uncontrolled copy. Unless noted otherwise
© Copyright of this drawing is vested in Hassell Ltd.

REV	DESCRIPTION	DATE
A	FOR COORDINATION	01/03/2024
B	DRAFT DETAIL DESIGN	30/04/2024
C	DETAIL DESIGN	06/06/2024
D	FOR HERITAGE APPROVAL	15/07/2024
E	FOR HERITAGE APPROVAL	13/09/2024

CLIENT
DEVELOPMENT VICTORIA

PROJECT
LAAK BOORNAP PUBLIC GARDEN
MELBOURNE ARTS PRECINCT
TRANSFORMATION

STATUS
DETAIL DESIGN

DRAWING TITLE
ZONE 04 - GENERAL ARRANGEMENT
PLAN

REVIEWED
SQ

APPROVED
BD

DRAWING NO.
L_1104

SCALE @ A0
1 : 100

PROJECT NO.
013922

REV NO.
E

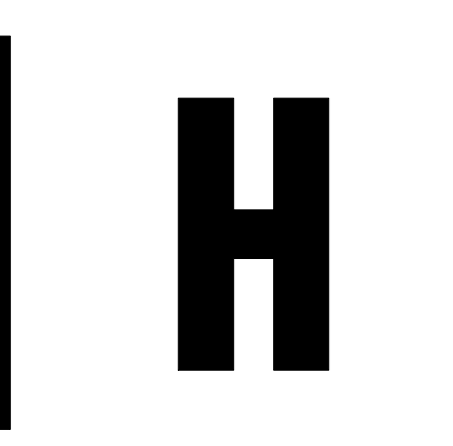
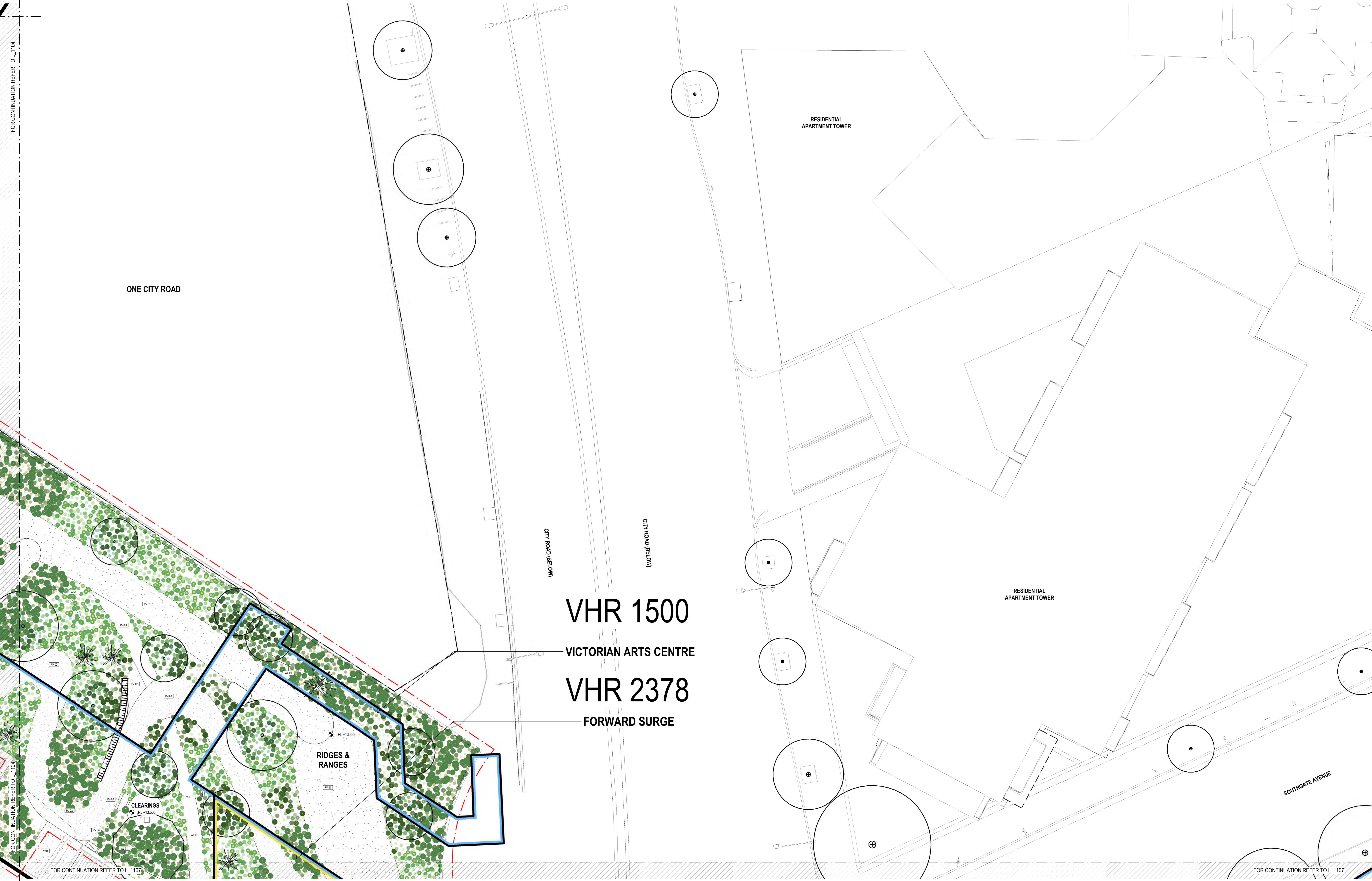

LEAD CONSULTANT

Hassell

Hassell LTD ABN 24 007 711 435
61 Little Collins Street
Melbourne Vic 3000 Australia
T +61 3 8102 3000
melbourne@hassell.com.au
Architect Directors VIC:
Mark Loughran 18222
Brenden Kelly 20550
Liz Weingarth 00113

CONSULTANT TEAM

SO-IL **wsp** **Super Bloom** **PHILIP CHUN** **VIPAC**

NORTHROP **WATERPROOFING** **STEWARTSON WARRING** **PURCELL** **MGAC**

G & M Connellan Consultants **JAMES HITCHMOUGH** **Nigel Dunnett**

CLIENT

DEVELOPMENT VICTORIA

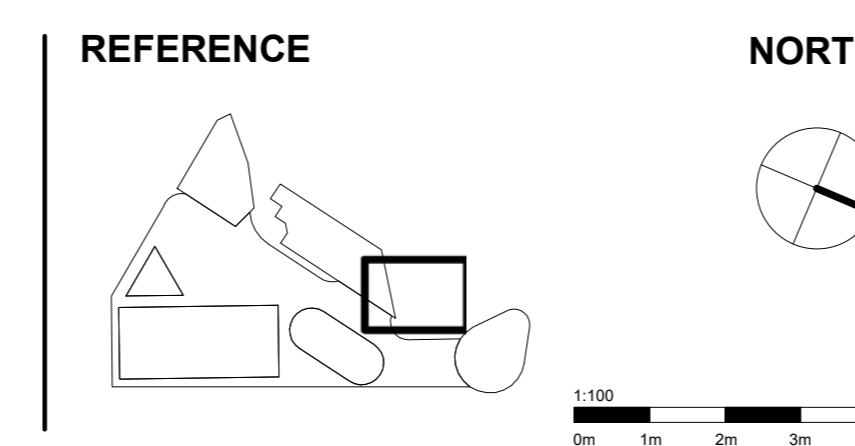

NOTES

1. Do not scale drawing. Written dimensions govern
2. All dimensions are in millimeters unless noted otherwise
3. All dimensions shall be verified on site before proceeding with the work. Hassell shall be notified in writing of any discrepancies.
4. This drawing must be read in conjunction with all relevant contracts, specifications and drawings.

This drawing is an uncontrolled copy. Unless noted otherwise
© Copyright of this drawing is vested in Hassell Ltd.

REV	DESCRIPTION	DATE
A	FOR COORDINATION	09/02/2024
B	FOR COORDINATION	01/03/2024
C	DRAFT DETAIL DESIGN	30/04/2024
D	DETAIL DESIGN	08/06/2024
E	FOR HERITAGE APPROVAL	15/07/2024
F	FOR HERITAGE APPROVAL	13/09/2024

CLIENT
DEVELOPMENT VICTORIA

PROJECT
LAAK BOORNAP PUBLIC GARDEN
MELBOURNE ARTS PRECINCT
TRANSFORMATION

STATUS
DETAIL DESIGN

DRAWING TITLE
ZONE 05 - GENERAL ARRANGEMENT
PLAN

REVIEWED
SQ

APPROVED
BD

DRAWING NO.
L_1105

SCALE @ A0
1 : 100

PROJECT NO.
013922

REV NO.
F

VHR 1499

NATIONAL GALLERY OF VICTORIA

VHR 1500

VICTORIAN ARTS CENTRE

THEATRES BUILDING

MOUSEHOLE ENTRANCE

VALLEY FLOOR

NAUTILUS

MOAT

VHR 2359

ST KILDA ROAD

ST KILDA ROAD

TITLE BOUNDARY

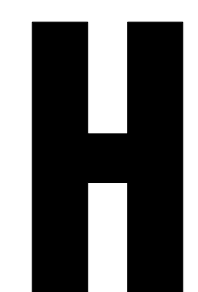

LEAD CONSULTANT

Hassell

Hassell LTD ABN 24 007 711 435
61 Little Collins Street
Melbourne Vic 3000 Australia
T +61 3 8102 3000
melbourne@hassell.com.au
Architect Directors VIC:
Mark Loughran 18202
Brendan Kelly 20560
Liz Westgarth 00113

CONSULTANT TEAM



CLIENT



REFERENCE

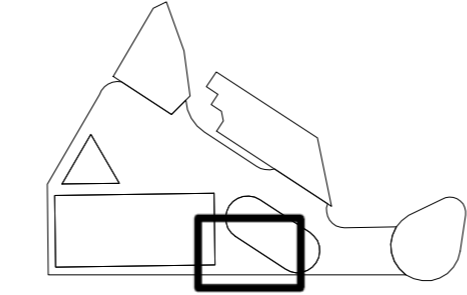

NORTH

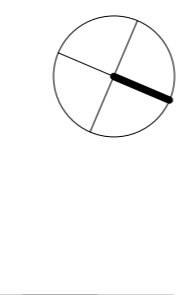

NOTES

1. Do not scale drawing. Written dimensions govern
 2. All dimensions are in millimeters unless noted otherwise
 3. All dimensions shall be verified on site before proceeding with the work. Hassell shall be notified in writing of any discrepancies.
 4. This drawing must be read in conjunction with all relevant contracts, specifications and drawings.
- This drawing is an uncontrolled copy. Unless noted otherwise
© Copyright of this drawing is vested in Hassell Ltd.

REV DESCRIPTION

A	FOR COORDINATION	09/02/2024
B	FOR COORDINATION	01/03/2024
C	DRAFT DETAIL DESIGN	30/04/2024
D	DETAIL DESIGN	08/06/2024
E	FOR HERITAGE APPROVAL	15/07/2024
F	FOR HERITAGE APPROVAL	13/09/2024

DATE

09/02/2024
01/03/2024
30/04/2024
08/06/2024
15/07/2024
13/09/2024

CLIENT

DEVELOPMENT VICTORIA

PROJECT
LAAK BOORNAP PUBLIC GARDEN
MELBOURNE ARTS PRECINCT
TRANSFORMATION

STATUS

DETAIL DESIGN

DRAWING TITLE
ZONE 06 - GENERAL ARRANGEMENT
PLAN

REVIEWED

SQ

APPROVED
BD

DRAWING NO.
L_1106

SCALE @ A0

1 : 100

PROJECT NO.
013922

REV NO.
F

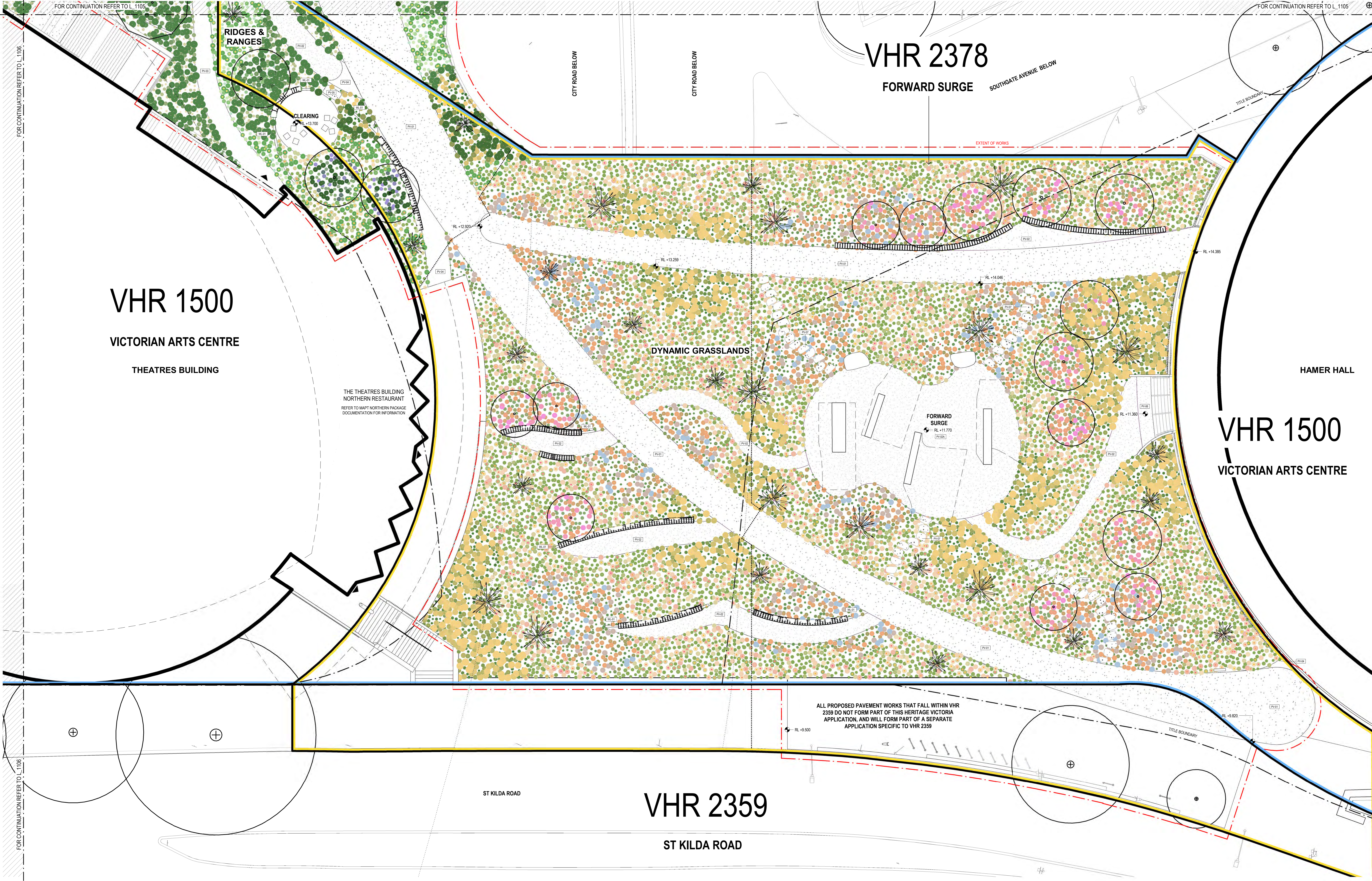

VHR 1500
VICTORIAN ARTS CENTRE
THEATRES BUILDING

VHR 2378
FORWARD SURGE

VHR 1500
VICTORIAN ARTS CENTRE

VHR 2359
ST KILDA ROAD

ALL PROPOSED PAVEMENT WORKS THAT FALL WITHIN VHR 2359 DO NOT FORM PART OF THIS HERITAGE VICTORIA APPLICATION, AND WILL FORM PART OF A SEPARATE APPLICATION SPECIFIC TO VHR 2359

THE THEATRES BUILDING
NORTHERN RESTAURANT
REFER TO MAPT NORTHERN PACKAGE
DOCUMENTATION FOR INFORMATION

FOR CONTINUATION REFER TO L_1106

FOR CONTINUATION REFER TO L_1105

FOR CONTINUATION REFER TO L_1106

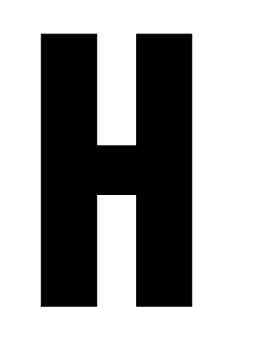

LEAD CONSULTANT
Hassell
Hassell LTD ABN 24 007 711 435
61 Little Collins Street
Melbourne Vic 3000 Australia
T +61 3 8102 3000
melbourne@hassell.com.au
Architect Directors VIC:
Mark Loughran 16252
Brendan Kelly 23624
Liz Weisgang 00113

CONSULTANT TEAM
SO-IL **wsp** **Super Bloom** **PHILIP CHUN** **VIPAC**
NORTHROP **WATERPROOFING** **PURCELL** **MGAC**
G & M Connellan Consultants **JAMES HITCMOUGH** **Nigel Dunnett**

CLIENT
DEVELOPMENT VICTORIA

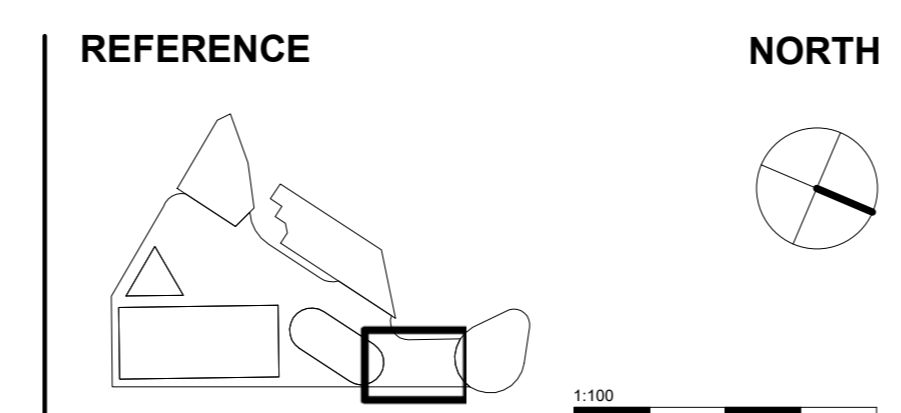

NOTES

1. Do not scale drawing. Written dimensions govern
2. All dimensions are in millimeters unless noted otherwise
3. All dimensions shall be verified on site before proceeding with the work. Hassell shall be notified in writing of any discrepancies.
4. This drawing must be read in conjunction with all relevant contracts, specifications and drawings.

This drawing is an uncontrolled copy. Unless noted otherwise © Copyright of this drawing is vested in Hassell Ltd.

REV	DESCRIPTION	DATE
A	FOR COORDINATION	01/03/2024
B	DRAFT DETAIL DESIGN	30/04/2024
C	DETAIL DESIGN	06/06/2024
D	FOR HERITAGE APPROVAL	15/07/2024
E	FOR HERITAGE APPROVAL	13/09/2024

CLIENT
DEVELOPMENT VICTORIA
PROJECT
LAK BOORNAP PUBLIC GARDEN
MELBOURNE ARTS PRECINCT
TRANSFORMATION

STATUS
DETAIL DESIGN
DRAWING TITLE
ZONE 07 - GENERAL ARRANGEMENT
PLAN

REVIEWED
SQ
APPROVED
BD
DRAWING NO.
L_1107
SCALE @ A0
1 : 100
PROJECT NO.
013922
REV NO.
E