

# LAAK BOORNDAP PUBLIC GARDEN MELBOURNE ARTS PRECINCT TRANSFORMATION



ARTIST IMPRESSION: VIEW FROM SOUTHERN AREA OF THE GARDEN LOOKING NORTH TOWARDS THE THEATRES BUILDING

DRAWING LIST				
SHEET NUMBER	SHEET NAME	CURRENT REVISION	CURRENT REVISION DATE	DESCRIPTION
L_0000	COVER SHEET & DRAWING INDEX	E	13/09/2024	FOR HERITAGE APPROVAL
L_0002	LEGEND & GENERAL NOTES	F	13/09/2024	FOR HERITAGE APPROVAL
L_0100	PRECINCT PLAN	F	13/09/2024	FOR HERITAGE APPROVAL
L_3101	KEY PLAN	F	13/09/2024	FOR HERITAGE APPROVAL
L_1001	ZONE 01 - EXISTING, DEMOLITION, SALVAGED AND RE-USE PLAN	F	13/09/2024	FOR HERITAGE APPROVAL
L_1002	ZONE 02 - EXISTING, DEMOLITION, SALVAGED AND RE-USE PLAN	E	15/07/2024	FOR HERITAGE APPROVAL
L_1003	ZONE 03 - EXISTING, DEMOLITION, SALVAGED AND RE-USE PLAN	F	13/09/2024	FOR HERITAGE APPROVAL
L_1004	ZONE 04 - EXISTING, DEMOLITION, SALVAGED AND RE-USE PLAN	F	13/09/2024	FOR HERITAGE APPROVAL
L_1005	ZONE 05 - EXISTING, DEMOLITION, SALVAGED AND RE-USE PLAN	E	15/07/2024	FOR HERITAGE APPROVAL
L_1006	ZONE 06 - EXISTING, DEMOLITION, SALVAGED AND RE-USE PLAN	F	13/09/2024	FOR HERITAGE APPROVAL
L_1007	ZONE 07 - EXISTING, DEMOLITION, SALVAGED AND RE-USE PLAN	F	13/09/2024	FOR HERITAGE APPROVAL
L_1101	ZONE 01 - GENERAL ARRANGEMENT PLAN	F	13/09/2024	FOR HERITAGE APPROVAL
L_1102	ZONE 02 - GENERAL ARRANGEMENT PLAN	F	13/09/2024	FOR HERITAGE APPROVAL
L_1103	ZONE 03 - GENERAL ARRANGEMENT PLAN	F	13/09/2024	FOR HERITAGE APPROVAL
L_1104	ZONE 04 - GENERAL ARRANGEMENT PLAN	E	13/09/2024	FOR HERITAGE APPROVAL
L_1105	ZONE 05 - GENERAL ARRANGEMENT PLAN	F	13/09/2024	FOR HERITAGE APPROVAL
L_1106	ZONE 06 - GENERAL ARRANGEMENT PLAN	F	13/09/2024	FOR HERITAGE APPROVAL
L_1107	ZONE 07 - GENERAL ARRANGEMENT PLAN	E	13/09/2024	FOR HERITAGE APPROVAL
L_2001	INTERFACE AXONOMETRICS - DYNAMIC GRASSLANDS	D	15/07/2024	FOR HERITAGE APPROVAL
L_2002	INTERFACE AXONOMETRICS - RIDGES AND RANGES	D	15/07/2024	FOR HERITAGE APPROVAL
L_2003	INTERFACE AXONOMETRICS - FLOWERING SLOPES	D	15/07/2024	FOR HERITAGE APPROVAL
L_2004	INTERFACE AXONOMETRICS - VALLEY FLOOR	E	13/09/2024	FOR HERITAGE APPROVAL
L_3101	INTERFACE SECTIONS	A	15/07/2024	FOR HERITAGE APPROVAL
L_3102	INTERFACE SECTIONS	A	15/07/2024	FOR HERITAGE APPROVAL
L_3103	INTERFACE SECTIONS	A	15/07/2024	FOR HERITAGE APPROVAL

<p><b>Hassell</b> Hassell LTD ABN 24 007 711 435 61 Little Collins Street Melbourne VIC 3000 Australia T +61 3 8102 3000 melbourne@hassell.com.au Architect Directors VIC: Mark Loughnan 16502 Brendan Kelly 20500 Liz Weingarth 00113</p>	<p><b>LEAD CONSULTANT</b></p>	<p><b>CONSULTANT TEAM</b></p>	<p><b>CLIENT</b></p>	<p><b>REFERENCE</b></p>	<p><b>NORTH</b></p>	<p><b>NOTES</b></p> <ol style="list-style-type: none"> <li>Do not scale drawing. Written dimensions govern</li> <li>All dimensions are in millimeters unless noted otherwise</li> <li>All dimensions shall be verified on site before proceeding with the work. Hassell shall be notified in writing of any discrepancies.</li> <li>This drawing must be read in conjunction with all relevant contracts, specifications and drawings.</li> </ol> <p>This drawing is an uncontrolled copy. Unless noted otherwise © Copyright of this drawing is vested in Hassell Ltd.</p>	<p><b>REV DESCRIPTION</b></p> <table border="1"> <tr><td>A</td><td>FOR COORDINATION</td><td>09/02/2024</td></tr> <tr><td>B</td><td>DRAFT DETAIL DESIGN</td><td>20/04/2024</td></tr> <tr><td>C</td><td>DETAIL DESIGN</td><td>06/06/2024</td></tr> <tr><td>D</td><td>FOR HERITAGE APPROVAL</td><td>15/07/2024</td></tr> <tr><td>E</td><td>FOR HERITAGE APPROVAL</td><td>13/09/2024</td></tr> </table>	A	FOR COORDINATION	09/02/2024	B	DRAFT DETAIL DESIGN	20/04/2024	C	DETAIL DESIGN	06/06/2024	D	FOR HERITAGE APPROVAL	15/07/2024	E	FOR HERITAGE APPROVAL	13/09/2024	<p><b>DATE</b></p> <p>09/02/2024 20/04/2024 06/06/2024 15/07/2024 13/09/2024</p>	<p><b>CLIENT</b></p> <p>DEVELOPMENT VICTORIA</p>	<p><b>STATUS</b></p> <p>DETAIL DESIGN</p>	<p><b>PROJECT</b></p> <p>LAAK BOORNDAP PUBLIC GARDEN MELBOURNE ARTS PRECINCT TRANSFORMATION</p>	<p><b>DRAWING TITLE</b></p> <p>COVER SHEET &amp; DRAWING INDEX</p>	<p><b>REVIEWED</b></p> <p>SQ</p>	<p><b>SCALE @ A0</b></p> <p>N/A</p>
	A	FOR COORDINATION	09/02/2024																										
B	DRAFT DETAIL DESIGN	20/04/2024																											
C	DETAIL DESIGN	06/06/2024																											
D	FOR HERITAGE APPROVAL	15/07/2024																											
E	FOR HERITAGE APPROVAL	13/09/2024																											
									<p><b>APPROVED</b></p> <p>BD</p>	<p><b>PROJECT NO.</b></p> <p>013922</p>	<p><b>DRAWING NO.</b></p> <p>L_0000</p>	<p><b>REV NO.</b></p> <p>E</p>																	



**GENERAL NOTES**

- ALL DRAWINGS TO BE PRINTED IN COLOUR.
- DETAIL SURVEY BACKGROUND AND EXISTING INFORMATION AS PROVIDED BY OTHERS.
- UNLESS NOTED OTHERWISE, PAVING LEVELS TO MATCH AND TIE IN TO EXISTING PAVING LEVELS AT ALL INTERFACES.
- UNLESS NOTED OTHERWISE ACCORDANCE:
  - ALL DIMENSIONS ARE IN MILLIMETRES
  - ALL REDUCED LEVELS ARE IN METRES
  - ALL LEVELS ARE TO AUSTRALIAN HEIGHT DATUM (AHD)
- DIMENSIONS SHALL NOT BE SCALED FROM DRAWINGS.
- TO DETERMINE THE FULL EXTENT OF WORK, THESE DRAWINGS SHALL BE READ IN CONJUNCTION WITH THE SPECIFICATION, CONSULTANTS DRAWINGS AND OTHER CONTRACT AND RELEVANT DOCUMENTS.

**DEMOLITION NOTES**

- ALL AREAS DEMOLISHED TO BE MADE GOOD TO ALLOW FOR INSTALLATION OF NEW MATERIALS AND TIE IN WORKS.
- THE ASSESSMENT OF THE EXISTING SITE ELEMENTS WITHIN THIS DOCUMENTATION PACKAGE IS CONSIDERED UNDER THE FOLLOWING CATEGORISATIONS:
- DEMOLITION** - I.E. ITEMS OR ASPECTS TO BE CAREFULLY AND PERMANENTLY REMOVED.
  - SALVAGE** - I.E. ITEMS TO BE CAREFULLY REMOVED, PROTECTED AND SECURELY STORED AHEAD OF REINSTATEMENT/RECONSTRUCTION.
  - CONSERVATION** - I.E. ORIGINAL (SIGNIFICANT) ITEMS TO BE PRESERVED, REPAIRED, RESTORED OR MISSING SIGNIFICANT ITEMS TO BE REINSTATED, NON-ORIGINAL ITEMS TO BE MAINTAINED AND RENEWED.
  - ADAPTATION AND REFURBISHMENT** - I.E. ALTERATION OR MODIFICATIONS TO EXISTING ELEMENTS, OR REPLACEMENT OF EXISTING INFRASTRUCTURE TO ENABLE CONTINUED OR COMPATIBLE CONTEMPORARY USE, INCLUDING COMPLIANCE UPGRADES.
  - MAINTENANCE AND REPAIRS** - I.E. INSPECTION AND PROTECTIVE CARE OF EXISTING ELEMENTS TO PRESERVE THEIR INTEGRITY AND PROLONG THEIR SERVICE LIKE AHEAD OF POSSIBLE REPAIR WHICH MAY INVOLVE RESTORATION OR RECONSTRUCTION.
  - NEW WORKS** - I.E. INTRODUCTION OF NEW ELEMENTS TO IMPROVE AMENITY OR FUNCTIONS TO ENABLE COMPATIBLE CONTEMPORARY USE, INCLUDING COMPLIANCE UPGRADES.
  - REINSTATEMENT** - I.E. CURRENT OR EXISTING ITEMS OF VARIOUS FABRIC GRADING OF SIGNIFICANCE TO BE RECONSTRUCTED OR REINSTATED FOLLOWING THE COMPLETION OF AGREED TEMPORARY PERIOD.

**SALVAGE AND RE-USE**

- WHERE NOMINATED, ELEMENTS TO BE SALVAGED FOR RE-USE WITHIN THE PROJECT SHALL BE CAREFULLY REMOVED AND STORED SAFELY ON SITE UNTIL THE ELEMENT IS READY FOR RE-INSTALLATION / RE-USE.
- WHERE NOMINATED, ELEMENTS TO BE SALVAGED AND RETURNED TO PRINCIPAL OR ASSET OWNER SHALL BE CAREFULLY REMOVED AND STORED SAFELY ON SITE UNTIL THE ELEMENT CAN BE RETURNED TO ASSET OWNER, CONTRACTOR TO ALLOW FOR STAGING OF REMOVAL AND STORAGE IN CONJUNCTION WITH ASSET OWNERS.
- WHERE NOMINATED, ELEMENTS TO BE SALVAGED FOR RE-USE OUTSIDE THE PROJECT SITE, SHALL BE CAREFULLY REMOVED AND TRANSPORTED TO NOMINATED LOCATION. CONTRACTOR TO ALLOW FOR STAGING AND PROGRAMMING OF DELIVERY TO NOMINATED LOCATION.

**TREE PROTECTION & REMOVAL**

FOR WORKS WITHIN EXISTING TREES TPZ, ARBORIST SUPERVISION IS REQUIRED TO AS IDENTIFIED WITHIN THE AGS ARBORICULTURAL IMPACT ASSESSMENT (AIA)

**TREE PROTECTION IN ACCORDANCE TO AS 4370**

- PROTECT ALL EXISTING TREES SCHEDULED FOR RETENTION FROM DAMAGE, INCLUDING TREES ON THE SITE AND ON ADJACENT PROPERTY.
- CARE FOR AND MAINTAIN ALL EXISTING TREES IN HEALTHY CONDITION DURING THE CONSTRUCTION PERIOD, INCLUDING ADEQUATE REGULAR WATERING.
- REFER TO PRINCIPAL ENGAGED ARBORIST (AGS) 'WATCH AND ACT' METHODOLOGY FOR ALL TREE REMOVAL TO THE NCV GARDENS.

**TREE TRANSPLANTATION**

- 1 NO. TREE IS NOMINATED FOR TRANSPLANTATION, AND REINSTALLATION WITHIN THE PROJECT SITE.
- TREE SPECIES - *Diospyros nana* - PERSIMMON
- PROPOSED TREE IS NOMINATED ON THE 1000 SERIES - EXISTING AND DEMOLITION PLANS.
- THE REVISED LOCATION IS NOMINATED ON THE 1100 SERIES - GENERAL ARRANGEMENT PLANS.
- THE EXISTING TREE TO BE TRANSPLANTED SHALL BE REMOVED AND MAINTAINED BY PRINCIPAL ENGAGED SPECIALIST CONSULTANT.
- THE SPECIALIST CONSULTANT SHALL BE ENGAGED BY THE PRINCIPAL.

**LIGHTING**

- LIGHTING IS PROPOSED AS PART OF THE PUBLIC GARDEN PROJECT WORKS.
- THE LIGHTING APPROACH PROPOSES A SERIES OF LAYERS:
  - PRIMARY PATHWAY POST - TOP LIGHTING
  - SECONDARY PATHWAY - BOLLARD LIGHTING
  - GARDEN LIGHTING WITHIN THE PLANTING
  - FEATURE LIGHTING FOR TREES, SCULPTURE AND ARTWORK
  - SAFETY LIGHTING WITHIN HANDRAILS
- THE LIGHTING DESIGN IS NOT SHOWN WITHIN THIS DOCUMENTATION PACKAGE.

**ABBREVIATIONS**

CDS	CHECK ON SITE
CRIT	CRITICAL
DIA	DIAMETER
EQ	EQUAL
GPO	GENERAL PURPOSE (POWER) OUTLET
NOM	NOMINAL
NTS	NOT TO SCALE
TBC	TO BE CONFIRMED
TRIP	TYPICAL
UNO	UNLESS NOTED OTHERWISE

**LEGEND**

**GENERAL**

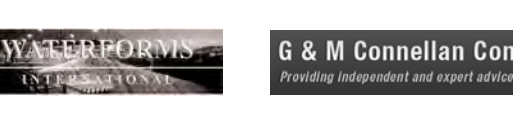
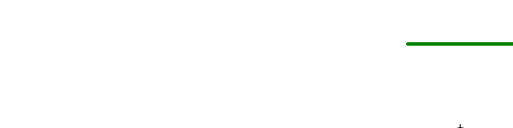
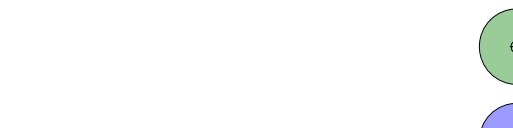
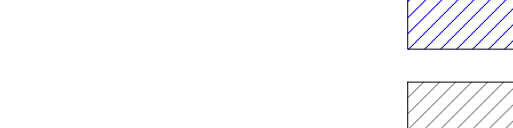
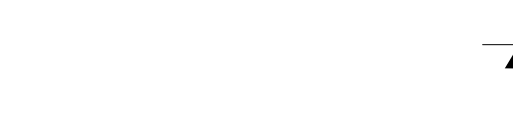
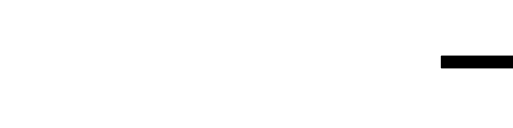
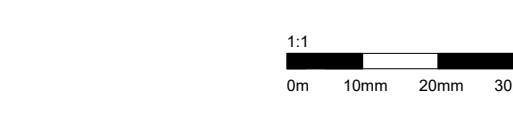
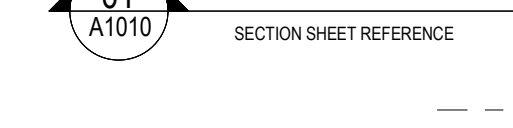
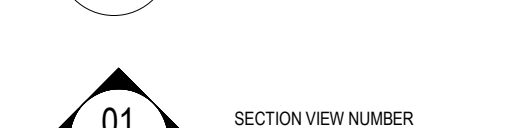

**GENERAL ARRANGEMENT**

**PAVING**

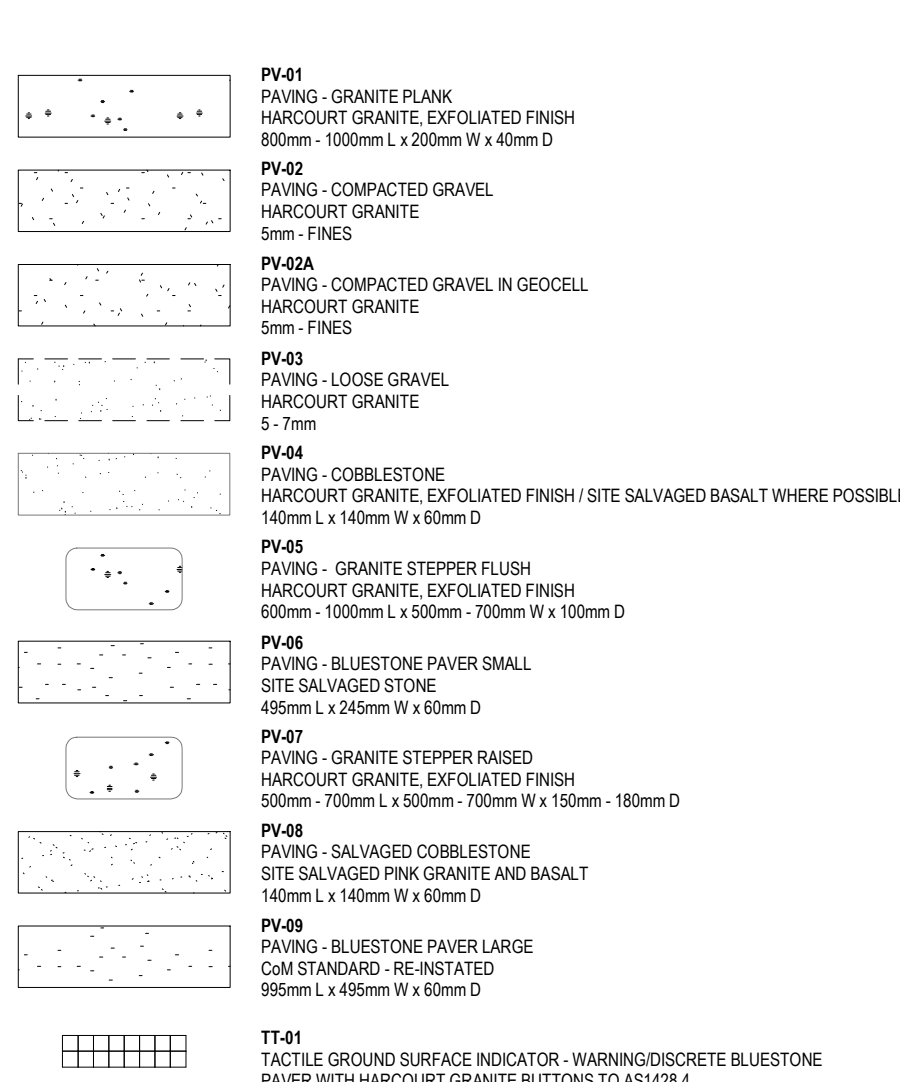

**WALL / EDGE**

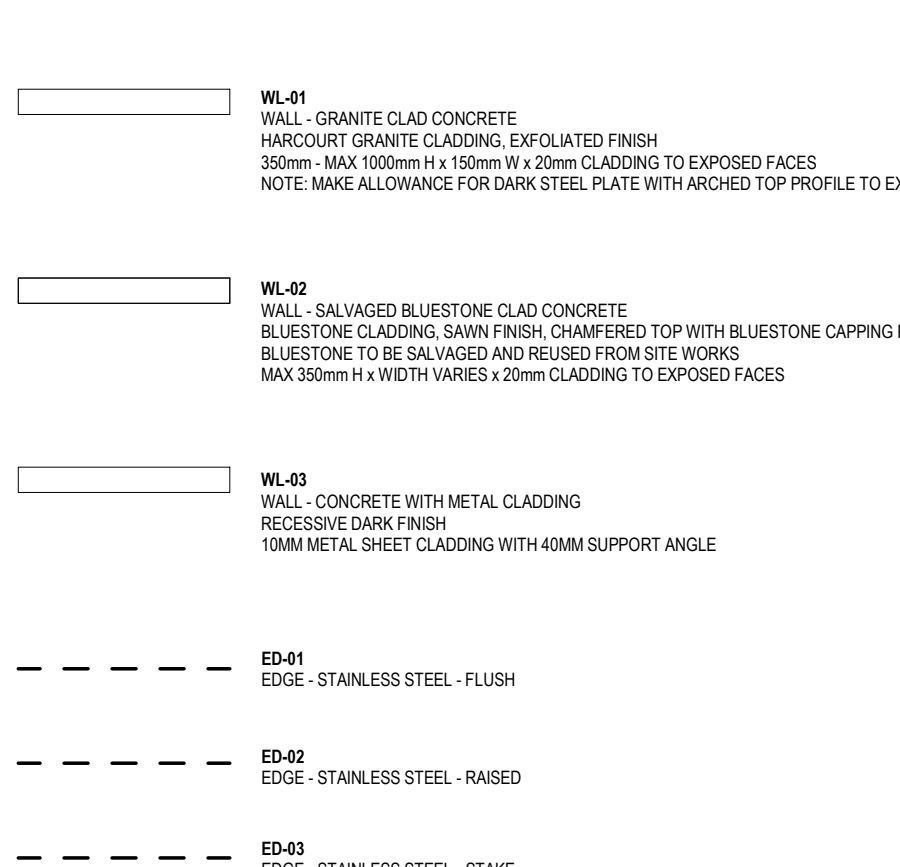

**RAILINGS AND WESTERN EDGE**

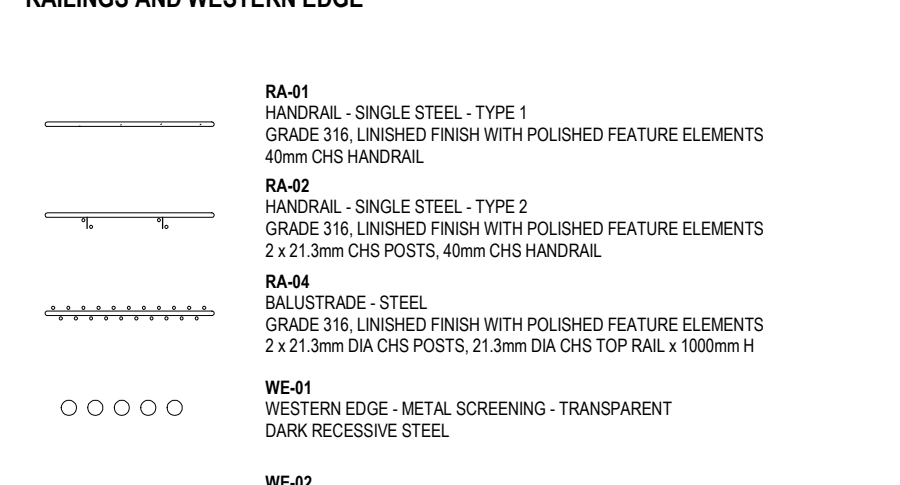

**SEATING**

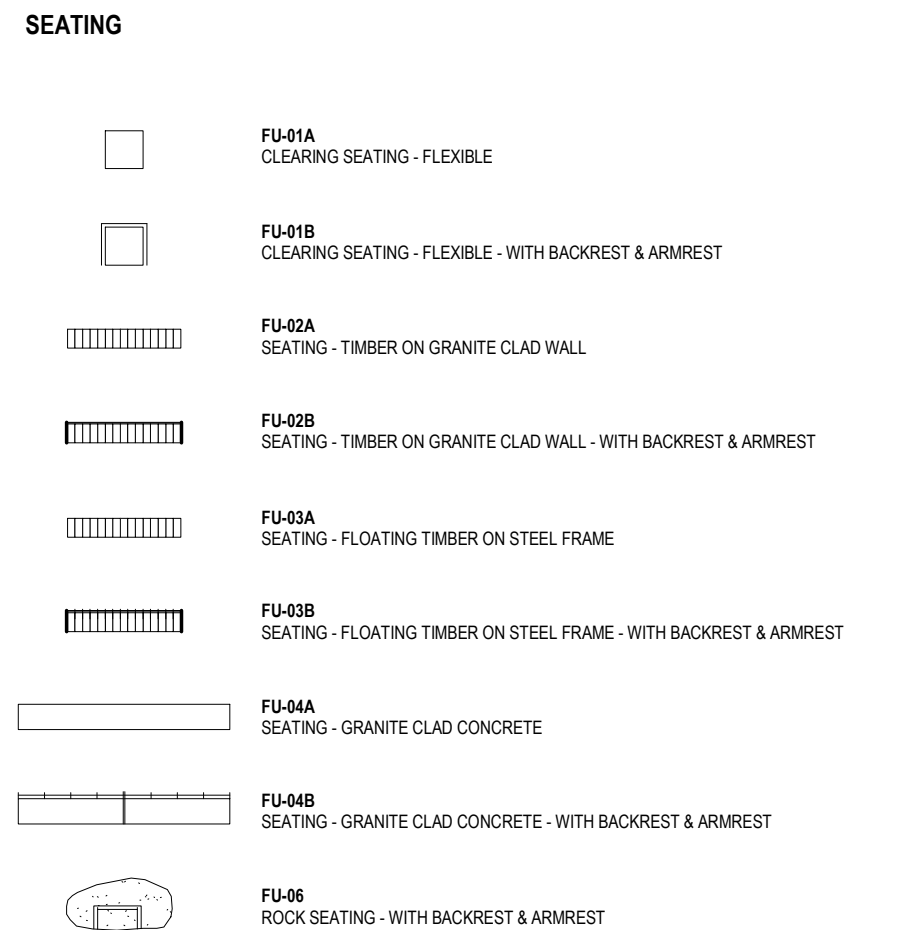

**FIXTURES & FITTINGS**

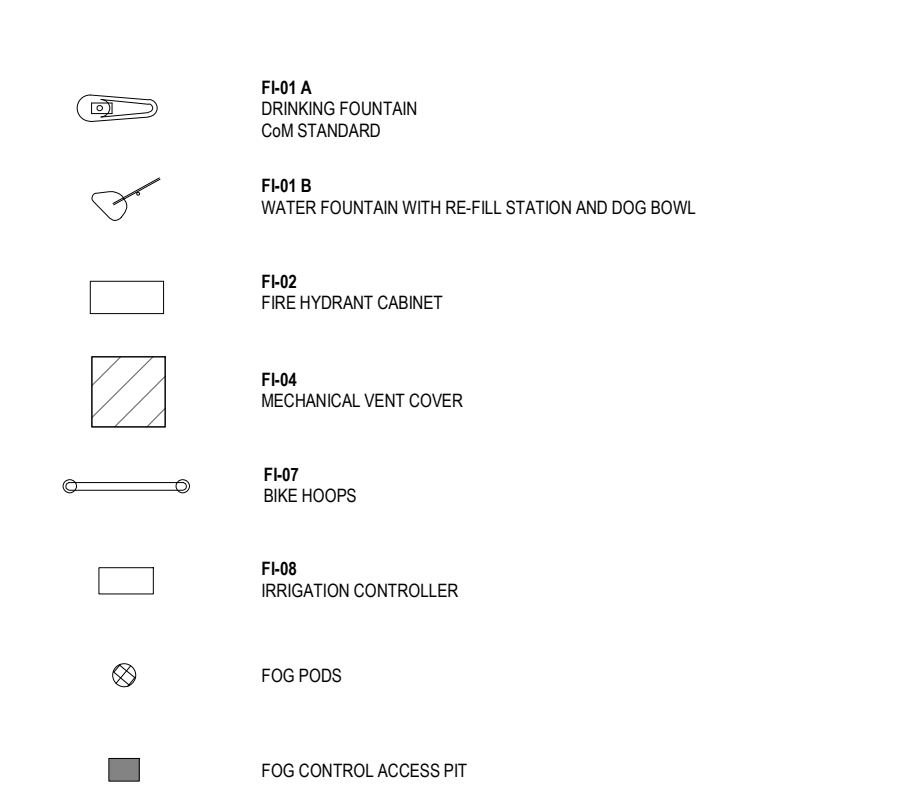

**ARTWORK & SCULPTURES**

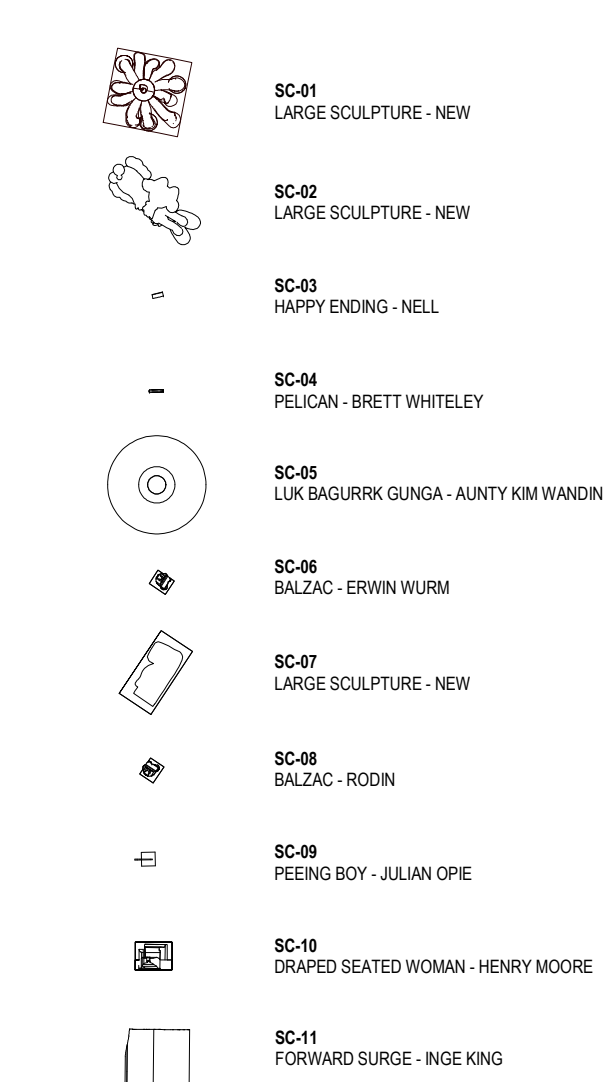

**UTILITIES AND SERVICES (BY OTHERS)**

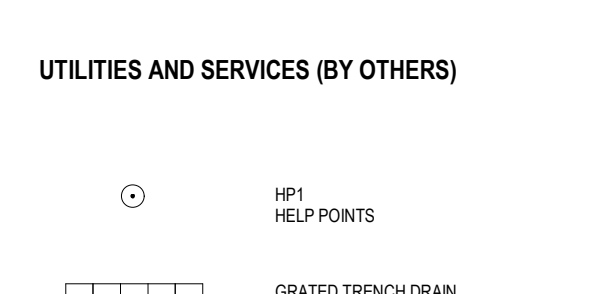

**WAYFINDING (BY OTHERS)**

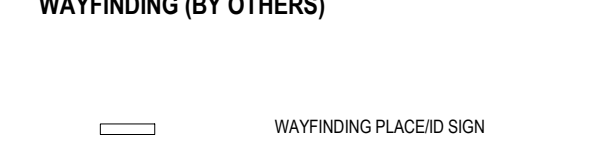

**TREES**

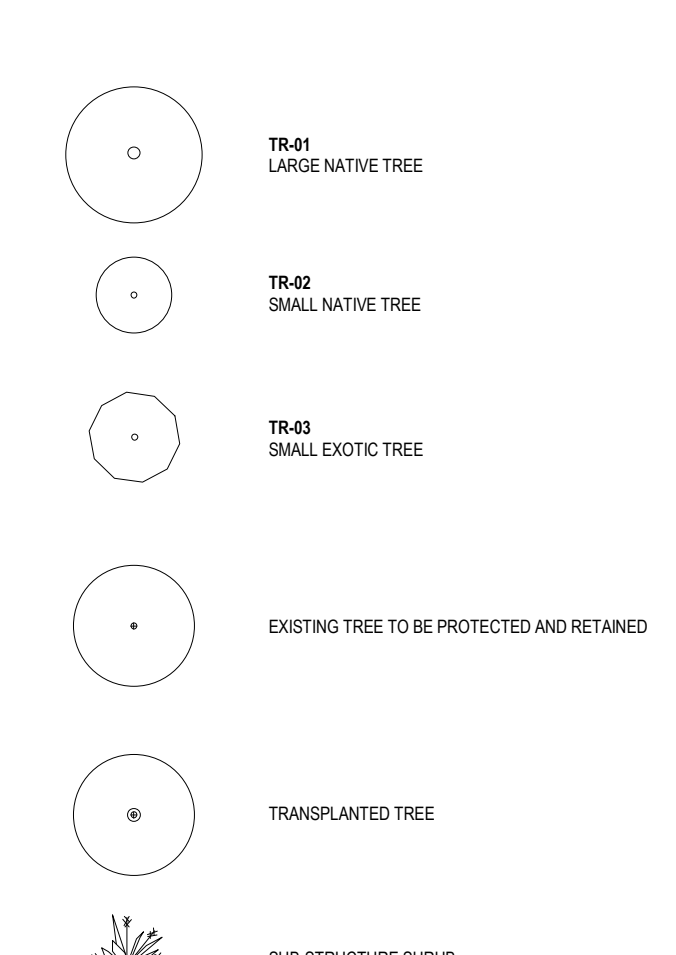

**SOFT LANDSCAPE GARDEN TYPOLOGY PLANT MIXES**

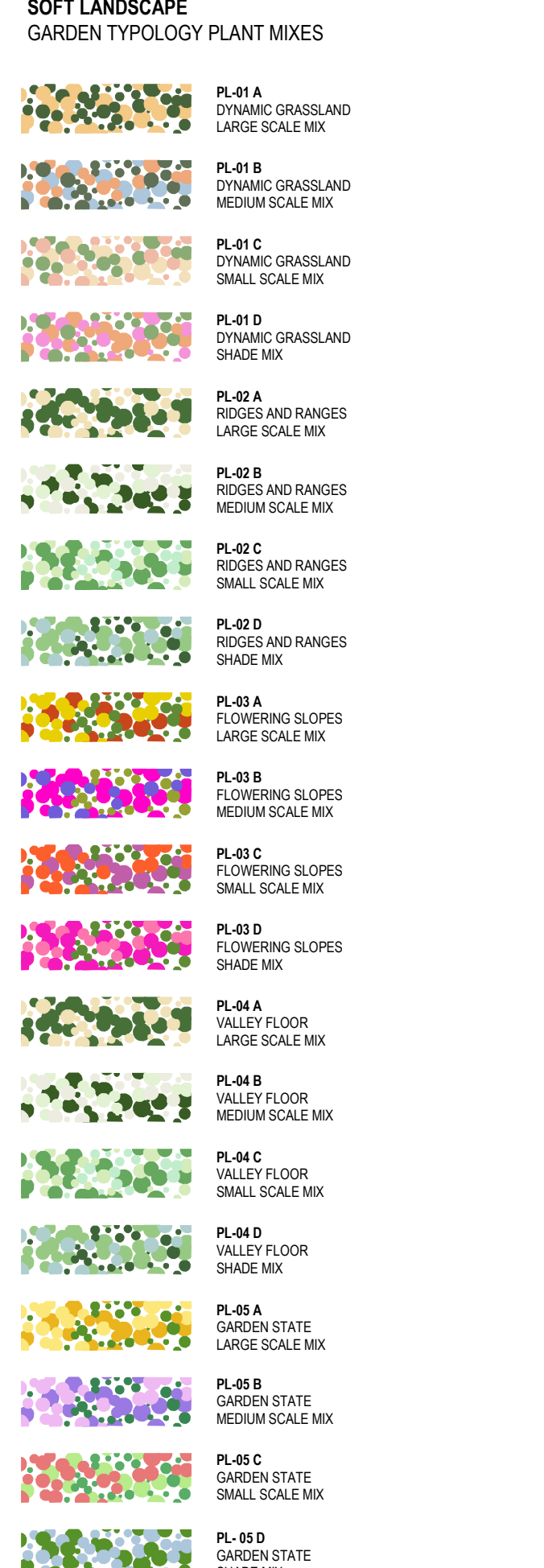

**SURFACE AREA**

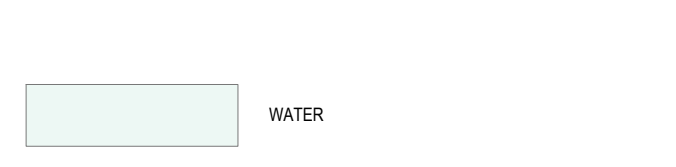

**LEAD CONSULTANT**

**CONSULTANT TEAM**

**CLIENT**

**REFERENCE**

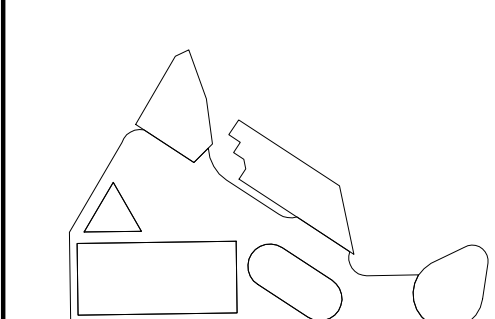

**NORTH**



**NOTES**

- Do not scale drawing. Written dimensions govern.
  - All dimensions are in millimeters unless noted otherwise.
  - All dimensions shall be verified on site before proceeding with the work. Hassell shall be notified in writing of any discrepancies.
  - This drawing must be read in conjunction with all relevant contracts, specifications and drawings.
- This drawing is an uncontrolled copy. Unless noted otherwise © Copyright of this drawing is vested in Hassell Ltd.

**REV DESCRIPTION**

A	FOR APPROVAL
B	FOR COORDINATION
C	DRAFT DETAIL DESIGN
D	DETAIL DESIGN
E	FOR HERITAGE APPROVAL
F	FOR HERITAGE APPROVAL

**DATE**

01/06/2023
09/02/2024
30/04/2024
06/06/2024
15/07/2024
13/09/2024

**CLIENT DEVELOPMENT VICTORIA**

**PROJECT**  
LAAK BOORDNAP PUBLIC GARDEN MELBOURNE ARTS PRECINCT TRANSFORMATION

**STATUS**

DETAIL DESIGN

**DRAWING TITLE**

LEGEND & GENERAL NOTES

**REVIEWED**

SQ

**APPROVED**

BD

**DRAWING NO.**

L\_0002

**SCALE @ A0**

As indicated

**PROJECT NO.**

013922

**REV NO.**

F



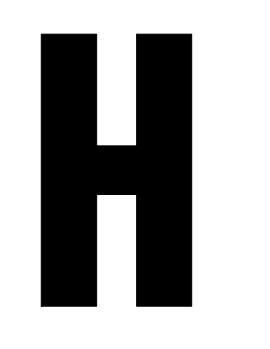

**LEAD CONSULTANT**  
**Hassell**  
 Hassell LTD ABN 24 007 711 435  
 61 Little Collins Street  
 Melbourne VIC 3000 Australia  
 T +61 3 8102 3000  
 melbourne@hassell.com.au  
 Architect Directors VIC:  
 Mark Loughran 15022  
 Brenden Kelly 23040  
 Liz Weingart 00113

**CONSULTANT TEAM**

**SO-IL** **WSP** **Super Bloom** **PHILIP CHUN** **VIPAC**  
**NORTHROP** **WATERPROOFING** **PURCELL** **MGAC**

**G & M Connellan Consultants** **JAMES HITCUMOUGH** **Nigel Dunnett**

**CLIENT**  
**DEVELOPMENT VICTORIA**

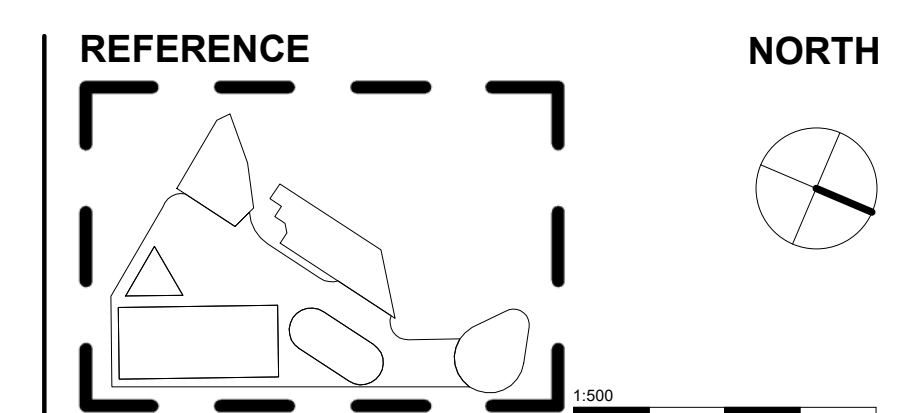

**NOTES**

1. Do not scale drawing. Written dimensions govern
2. All dimensions are in millimeters unless noted otherwise
3. All dimensions shall be verified on site before proceeding with the work. Hassell shall be notified in writing of any discrepancies.
4. This drawing must be read in conjunction with all relevant contracts, specifications and drawings.

This drawing is an uncontrolled copy. Unless noted otherwise  
 © Copyright of this drawing is vested in Hassell Ltd.

REV	DESCRIPTION	DATE
A	FOR COORDINATION	09/02/2024
B	FOR COORDINATION	01/03/2024
C	DRAFT DETAIL DESIGN	30/04/2024
D	DETAIL DESIGN	08/06/2024
E	FOR HERITAGE APPROVAL	15/07/2024
F	FOR HERITAGE APPROVAL	13/09/2024

**CLIENT**  
 DEVELOPMENT VICTORIA

**PROJECT**  
 LAAK BOORNAP PUBLIC GARDEN  
 MELBOURNE ARTS PRECINCT  
 TRANSFORMATION

**STATUS**  
 DETAIL DESIGN

**DRAWING TITLE**  
 PRECINCT PLAN

**REVIEWED**  
 SQ

**APPROVED**  
 BD

**DRAWING NO.**  
 L\_0100

**SCALE @ A0**  
 1 : 500

**PROJECT NO.**  
 013922

**REV NO.**  
 F



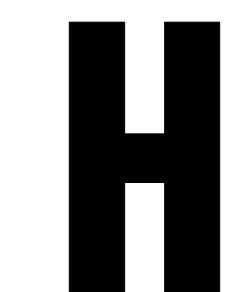
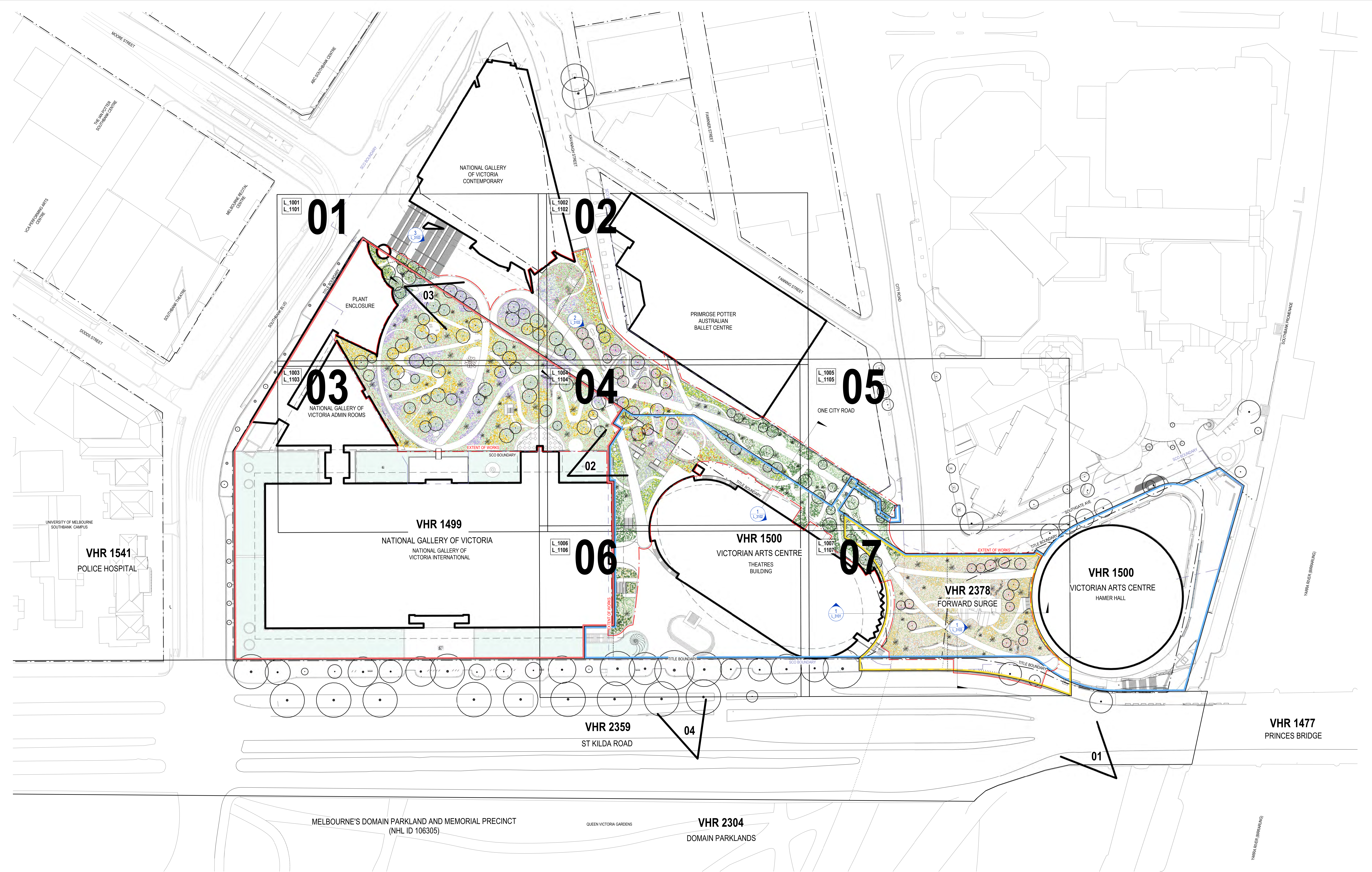

**LEAD CONSULTANT**

**Hassell**

Hassell LTD ABN 24 007 711 435  
 61 Little Collins Street  
 Melbourne Vic 3000 Australia  
 T +61 3 8102 3000  
 melbourne@hassell.com.au  
 Architects Directors VIC  
 Mark Loughran 15022  
 Brenden Kelly 23562  
 Liz Weingarth 00113

**CONSULTANT TEAM**



**CLIENT**



**REFERENCE**

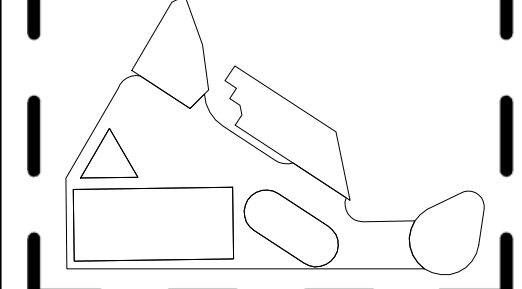

**NORTH**

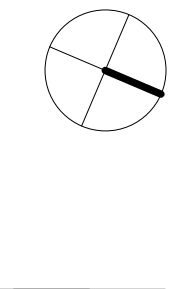

**NOTES**

1. Do not scale drawing. Written dimensions govern
  2. All dimensions are in millimeters unless noted otherwise
  3. All dimensions shall be verified on site before proceeding with the work. Hassell shall be notified in writing of any discrepancies.
  4. This drawing must be read in conjunction with all relevant contracts, specifications and drawings.
- This drawing is an uncontrolled copy. Unless noted otherwise  
 © Copyright of this drawing is vested in Hassell Ltd.

**REV DESCRIPTION**

A	FOR COORDINATION
B	FOR COORDINATION
C	DRAFT DETAIL DESIGN
D	DETAIL DESIGN
E	FOR HERITAGE APPROVAL
F	FOR HERITAGE APPROVAL

**DATE**

09/02/2024
01/03/2024
30/04/2024
08/06/2024
15/07/2024
13/09/2024

**CLIENT**

DEVELOPMENT VICTORIA

**PROJECT**  
 LAAK BOORNAP PUBLIC GARDEN  
 MELBOURNE ARTS PRECINCT  
 TRANSFORMATION

**STATUS**

DETAIL DESIGN

**DRAWING TITLE**

KEY PLAN

**REVIEWED**

SQ

**APPROVED**

BD

**DRAWING NO.**  
 L\_0101

**SCALE @ A0**

1 : 500

**PROJECT NO.**

013922

**REV NO.**

F



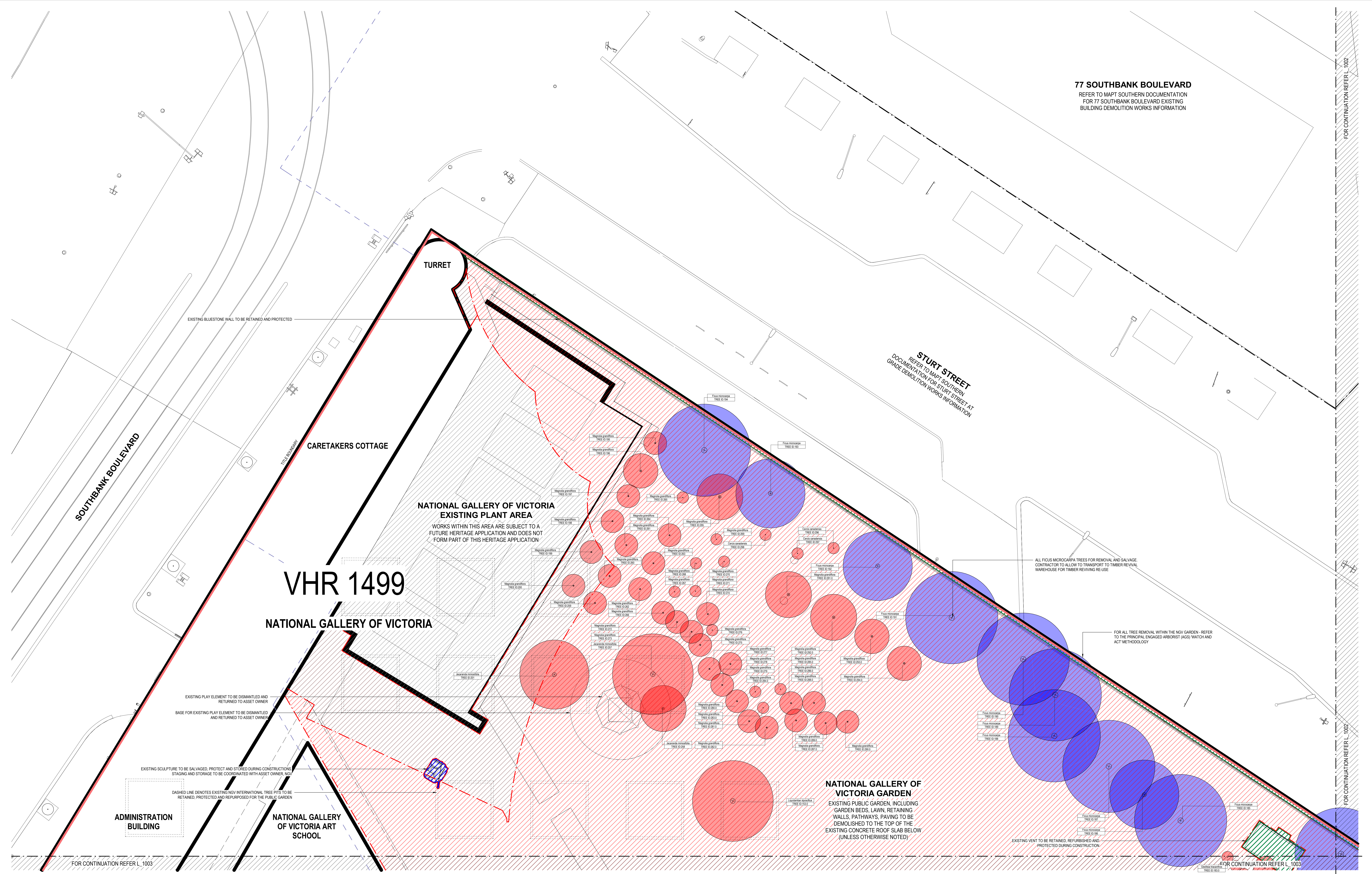

FOR CONTINUATION REFER L\_1002

FOR CONTINUATION REFER L\_1002

FOR CONTINUATION REFER L\_1003

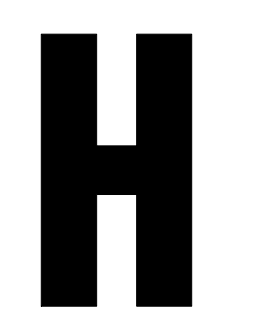

**LEAD CONSULTANT**

**Hassell**

Hassell LTD ABN 24 007 711 435  
61 Little Collins Street  
Melbourne VIC 3000 Australia  
T +61 3 8102 3000  
melbourne@hassell.com.au  
Architect Directors VIC:  
Mark Loughran 15252  
Brendan Kelly 20562  
Liz Westgate 00113

**CONSULTANT TEAM**

**SO-IL** **WSP** **Super Bloom** **PHILIP CHUN** **VIPAC**

**NORTHROP** **WATERPROOFING** **PURCELL** **MGAC**

**G & M Connellan Consultants** **JAMES HITCMOUGH** **Nigel Dunnett**

**CLIENT**

**DEVELOPMENT VICTORIA**

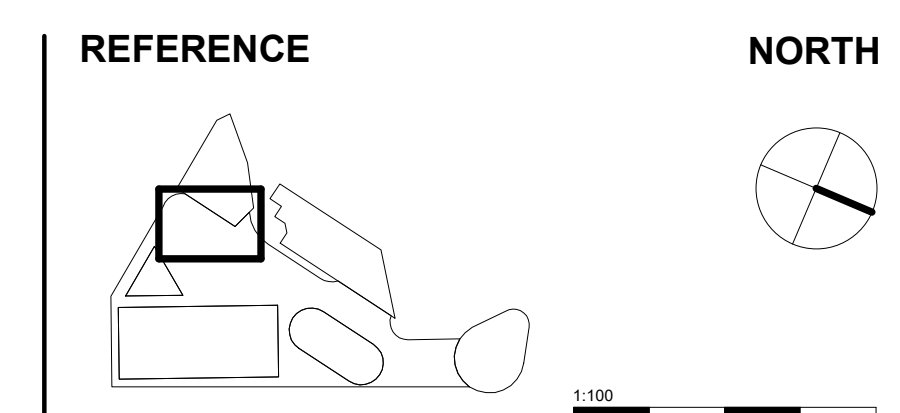

**NOTES**

1. Do not scale drawing. Written dimensions govern
2. All dimensions are in millimeters unless noted otherwise
3. All dimensions shall be verified on site before proceeding with the work. Hassell shall be notified in writing of any discrepancies.
4. This drawing must be read in conjunction with all relevant contracts, specifications and drawings

This drawing is an uncontrolled copy. Unless noted otherwise © Copyright of this drawing is vested in Hassell Ltd.

REV	DESCRIPTION	DATE
A	FOR COORDINATION	09/02/2024
B	FOR COORDINATION	01/03/2024
C	DRAFT DETAIL DESIGN	30/04/2024
D	DETAIL DESIGN	08/06/2024
E	FOR HERITAGE APPROVAL	15/07/2024
F	FOR HERITAGE APPROVAL	13/09/2024

**CLIENT**  
DEVELOPMENT VICTORIA

**PROJECT**  
LAAK BOORNAP PUBLIC GARDEN  
MELBOURNE ARTS PRECINCT  
TRANSFORMATION

**STATUS**  
DETAIL DESIGN

**DRAWING TITLE**  
ZONE 01 - EXISTING, DEMOLITION,  
SALVAGED AND RE-USE PLAN

**REVIEWED**  
SQ

**APPROVED**  
BD

**DRAWING NO.**  
L\_1001

**SCALE @ A0**  
1 : 100

**PROJECT NO.**  
013922

**REV NO.**  
F



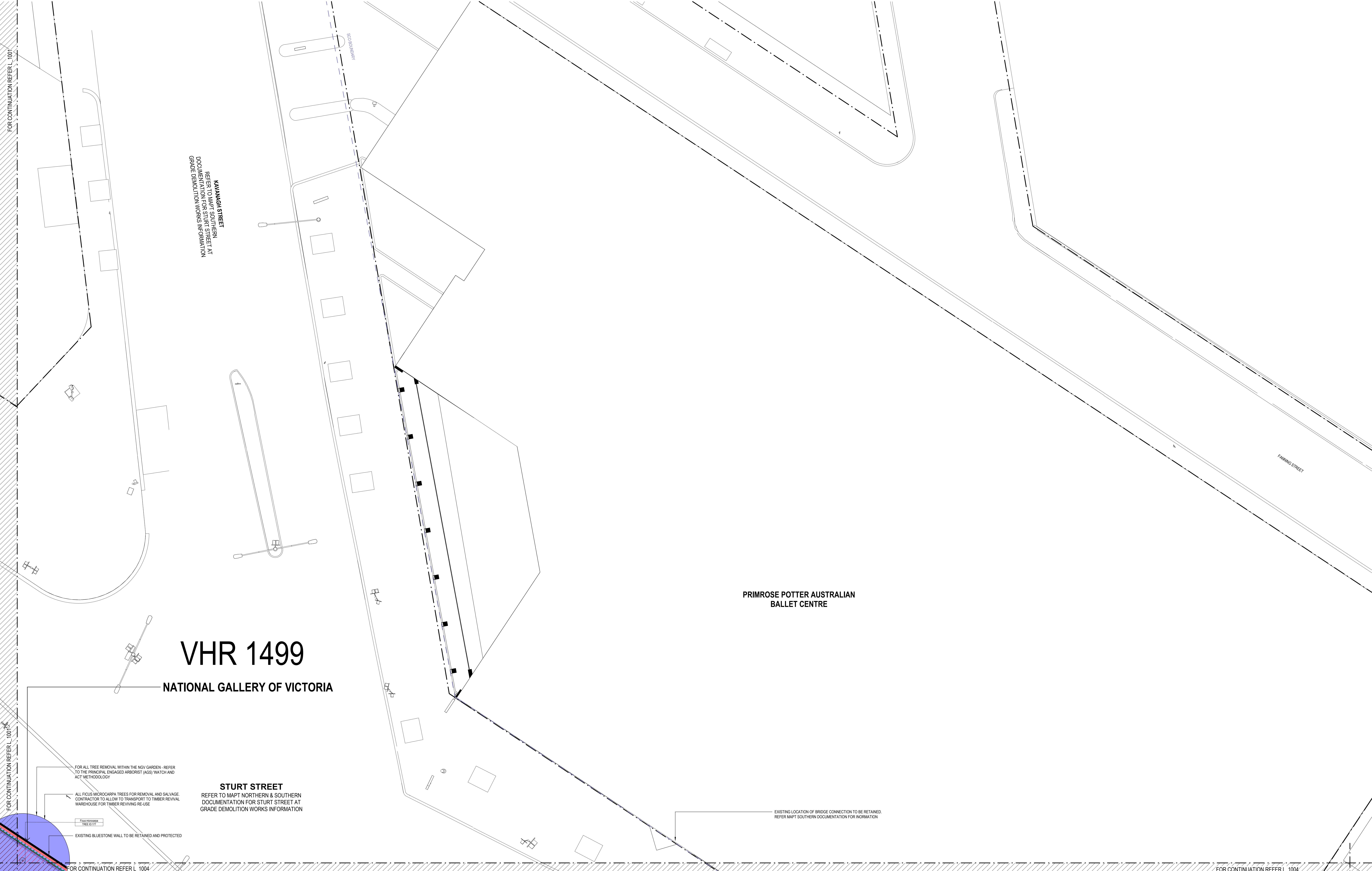

FOR CONTINUATION REFER L\_1001

KAMWAGH STREET  
REFER TO MAPT SOUTHERN  
DOCUMENTATION FOR STURT STREET AT  
GRADE DEMOLITION WORKS INFORMATION

VHR 1499  
NATIONAL GALLERY OF VICTORIA

STURT STREET  
REFER TO MAPT NORTHERN & SOUTHERN  
DOCUMENTATION FOR STURT STREET AT  
GRADE DEMOLITION WORKS INFORMATION

PRIMROSE POTTER AUSTRALIAN  
BALLET CENTRE

FAWING STREET

FOR CONTINUATION REFER L\_1002

FOR ALL TREE REMOVAL WITHIN THE NGV GARDEN - REFER  
TO THE PRINCIPAL ENGAGED ARBORIST (AGS) WATCH AND  
AGT METHODOLOGY

ALL FIGUS MICROCARPA TREES FOR REMOVAL AND SALVAGE  
CONTRACTOR TO ALLOW TO TRANSPORT TO TIMBER REVIVAL  
WAREHOUSE FOR TIMBER REVIVING RE-USE

EXISTING BLUESTONE WALL TO BE RETAINED AND PROTECTED

EXISTING LOCATION OF BRIDGE CONNECTION TO BE RETAINED.  
REFER MAPT SOUTHERN DOCUMENTATION FOR INFORMATION

FOR CONTINUATION REFER L\_1004

FOR CONTINUATION REFER L\_1004

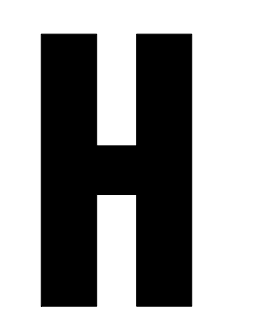

**LEAD CONSULTANT**  
**Hassell**  
Hassell LTD ABN 24 007 711 435  
61 Little Collins Street  
Melbourne VIC 3000 Australia  
T +61 3 8102 3000  
melbourne@hassell.com.au  
Architect Directors VIC:  
Mark Loughran 18222  
Brenden Kelly 20550  
Liz Westgarth 00113

**CONSULTANT TEAM**  
**SO-IL** **wsp** **Super Bloom** **PHILIP CHUN** **VIPAC**  
**NORTHROP** **WATERPROOFING** **STEVENS VAN DER WERF** **PURCELL** **MGAC**  
**G & M Connellan Consultants** **JAMES HITCHMOUGH** **Nigel Dunnett**

**CLIENT**  
**DEVELOPMENT VICTORIA**

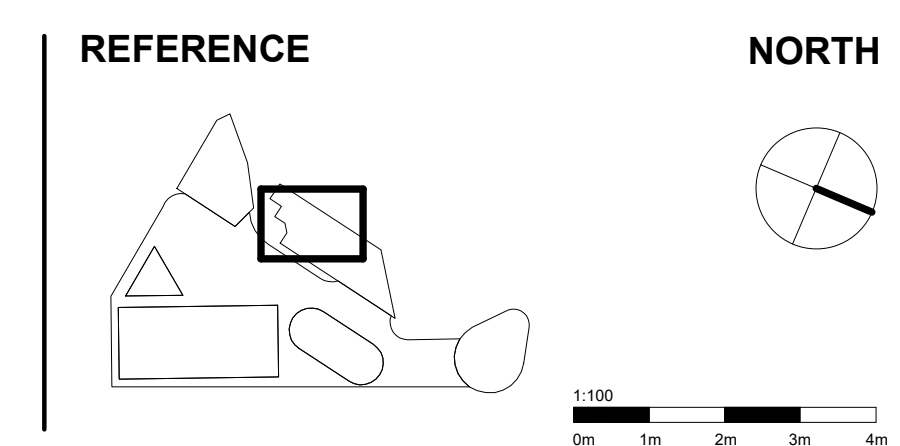

**NOTES**

1. Do not scale drawing. Written dimensions govern
2. All dimensions are in millimeters unless noted otherwise
3. All dimensions shall be verified on site before proceeding with the work. Hassell shall be notified in writing of any discrepancies.
4. This drawing must be read in conjunction with all relevant contracts, specifications and drawings.

This drawing is an uncontrolled copy. Unless noted otherwise  
© Copyright of this drawing is vested in Hassell Ltd.

REV	DESCRIPTION	DATE
A	FOR COORDINATION	09/02/2024
B	FOR COORDINATION	01/03/2024
C	DRAFT DETAIL DESIGN	30/04/2024
D	DETAIL DESIGN	06/06/2024
E	FOR HERITAGE APPROVAL	15/07/2024

**CLIENT**  
DEVELOPMENT VICTORIA

**PROJECT**  
LAAK BOORNAP PUBLIC GARDEN  
MELBOURNE ARTS PRECINCT  
TRANSFORMATION

**STATUS**  
DETAIL DESIGN

**DRAWING TITLE**  
ZONE 02 - EXISTING, DEMOLITION,  
SALVAGED AND RE-USE PLAN

**REVIEWED**  
SQ

**APPROVED**  
BD

**DRAWING NO.**  
L\_1002

**SCALE @ A0**  
1 : 100

**PROJECT NO.**  
013922

**REV NO.**  
E







**STURT STREET**  
REFER TO MAPT NORTHERN & SOUTHERN  
DOCUMENTATION FOR STURT STREET AT GRADE  
DEMOLITION WORKS INFORMATION

ALL FIGUS MICROCARPA TREES FOR REMOVAL AND SALVAGE.  
CONTRACTOR TO ALLOW TO TRANSPORT TO TIMBER REVAL  
WAREHOUSE FOR RE-USE

FOR ALL TREE REMOVAL WITHIN THE NGV GARDEN - REFER  
TO THE PRINCIPAL ENGAGED ARBORIST (AGS) WATCH AND  
ACT METHODOLOGY

**PRIMROSE POTTER AUSTRALIAN  
BALLET CENTRE**

**NATIONAL GALLERY OF  
VICTORIA GARDEN**

EXISTING PUBLIC GARDEN, INCLUDING GARDEN BEDS,  
LAWN, RETAINING WALLS, PATHWAYS, PAVING TO BE  
DEMOLISHED TO THE TOP OF THE EXISTING CONCRETE  
ROOF SLAB BELOW (UNLESS OTHERWISE NOTED)

**THEATRES BUILDING BARRE  
OUTDOOR AREA**

EXISTING PUBLIC GARDEN, INCLUDING GARDEN  
BEDS, LAWN, RETAINING WALLS, PATHWAYS,  
PAVING TO BE DEMOLISHED TO THE TOP OF  
THE EXISTING CONCRETE ROOF SLAB BELOW  
(UNLESS OTHERWISE NOTED)

**VHR 1499**

**NATIONAL GALLERY OF VICTORIA**

**VHR 1500**

**VICTORIAN ARTS CENTRE**

**THEATRES BUILDING**

**GARDEN  
RESTAURANT**

**MOAT**

EXISTING SCULPTURE TO BE SALVAGED,  
PROTECTED & STORED DURING CONSTRUCTION

EXISTING SCULPTURE TO BE SALVAGED,  
PROTECTED & STORED DURING CONSTRUCTION

EXISTING TREE TO BE REMOVED AND MAINTAINED BY PRINCIPAL ENGAGED  
SPECIALIST CONSULTANT. FUTURE REPLANTING BY THE CONTRACTOR

EXISTING HANDRAIL & BLUESTONE CAPPING BELOW TO BE RETAINED AND PROTECTED

EXISTING ARTWORK PLINTH TO BE SALVAGED, PROTECTED AND RETURNED TO ASSET OWNER (NGV)

EXISTING MOVEMENT JOINT BETWEEN NGV BLUESTONE  
WALL AND NGV BLUESTONE STAIR WALL TO BE RETAINED  
& PROTECTED DURING CONSTRUCTION

EXISTING BLUESTONE WALL TO BE RETAINED - BALUSTRADE ON TOP TO BE CAREFULLY  
REMOVED. IF BLUESTONE CAPPING IS TO BE REMOVED TO FACILITATE REMOVAL OF BALUSTRADE  
ADVISE SUPERINTENDENT BEFORE PROCEEDING

EXISTING STAIRCASE & SURROUNDING RETAINING WALLS TO BE RETAINED AND PROTECTED

EXISTING GARDEN BED WALLS TO BE DEMOLISHED AND BLUESTONE CAPPING AND CLADDING  
CAREFULLY SALVAGED FOR REUSE AND REINSTATEMENT WITHIN THE PRECINCT

EXISTING FENCING TO BE DEMOLISHED

EXISTING VENT STRUCTURE TO BE RETAINED AND PROTECTED FOR REFURBISHMENT

EXISTING STAIRCASE & SURROUNDING RETAINING WALLS TO BE RETAINED AND PROTECTED

EXISTING STAIRCASE & SURROUNDING RETAINING WALLS TO BE RETAINED AND PROTECTED

EXISTING FENCING TO BE DEMOLISHED

EXISTING STAIRCASE & SURROUNDING RETAINING WALLS AND HANDRAILS TO BE RETAINED  
AND PROTECTED

EXISTING VENT STRUCTURE TO BE RETAINED AND PROTECTED FOR REFURBISHMENT

EXISTING SCULPTURE TO BE CAREFULLY SALVAGED, PROTECTED & STORED DURING CONSTRUCTION.  
STAGING AND STORAGE TO BE COORDINATED WITH ASSET OWNER, NGV

EXISTING BLUESTONE WALL TO BE RETAINED AND PROTECTED

EXISTING GARDEN BED WALLS TO BE DEMOLISHED

EXISTING FENCING TO BE DEMOLISHED

TITLE BOUNDARY

FOR CONTINUATION REFER L\_1003

FOR CONTINUATION REFER L\_1005

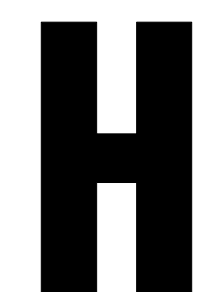

**LEAD CONSULTANT**

**Hassell**

Hassell LTD ABN 24 007 711 435  
61 Little Collins Street  
Melbourne VIC 3000 Australia  
T +61 3 8102 3000  
melbourne@hassell.com.au  
Architect Directors VIC:  
Mark Loughran 2502  
Brendan Kelly 2502  
Liz Westgarth 00113

**CONSULTANT TEAM**



**CLIENT**



**REFERENCE**

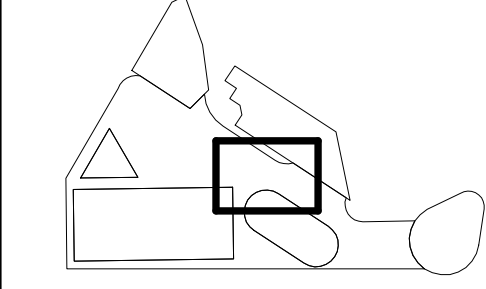

**NORTH**

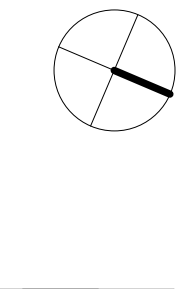

**NOTES**

1. Do not scale drawing. Written dimensions govern
  2. All dimensions are in millimeters unless noted otherwise
  3. All dimensions shall be verified on site before proceeding with the work. Hassell shall be notified in writing of any discrepancies
  4. This drawing must be read in conjunction with all relevant contracts, specifications and drawings
- This drawing is an uncontrolled copy. Unless noted otherwise  
© Copyright of this drawing is vested in Hassell Ltd.

**REV DESCRIPTION**

A	FOR COORDINATION
B	FOR COORDINATION
C	DRAFT DETAIL DESIGN
D	DETAIL DESIGN
E	FOR HERITAGE APPROVAL
F	FOR HERITAGE APPROVAL

**DATE**

09/02/2024
01/03/2024
30/04/2024
08/06/2024
15/07/2024
13/09/2024

**CLIENT**  
DEVELOPMENT VICTORIA

**PROJECT**  
LAAK BOORNAP PUBLIC GARDEN  
MELBOURNE ARTS PRECINCT  
TRANSFORMATION

**STATUS**  
DETAIL DESIGN

**DRAWING TITLE**  
ZONE 04 - EXISTING, DEMOLITION,  
SALVAGED AND RE-USE PLAN

**REVIEWED**  
SQ

**APPROVED**  
BD

**DRAWING NO.**  
L\_1004

**SCALE @ A0**  
1 : 100

**PROJECT NO.**  
013922

**REV NO.**  
F



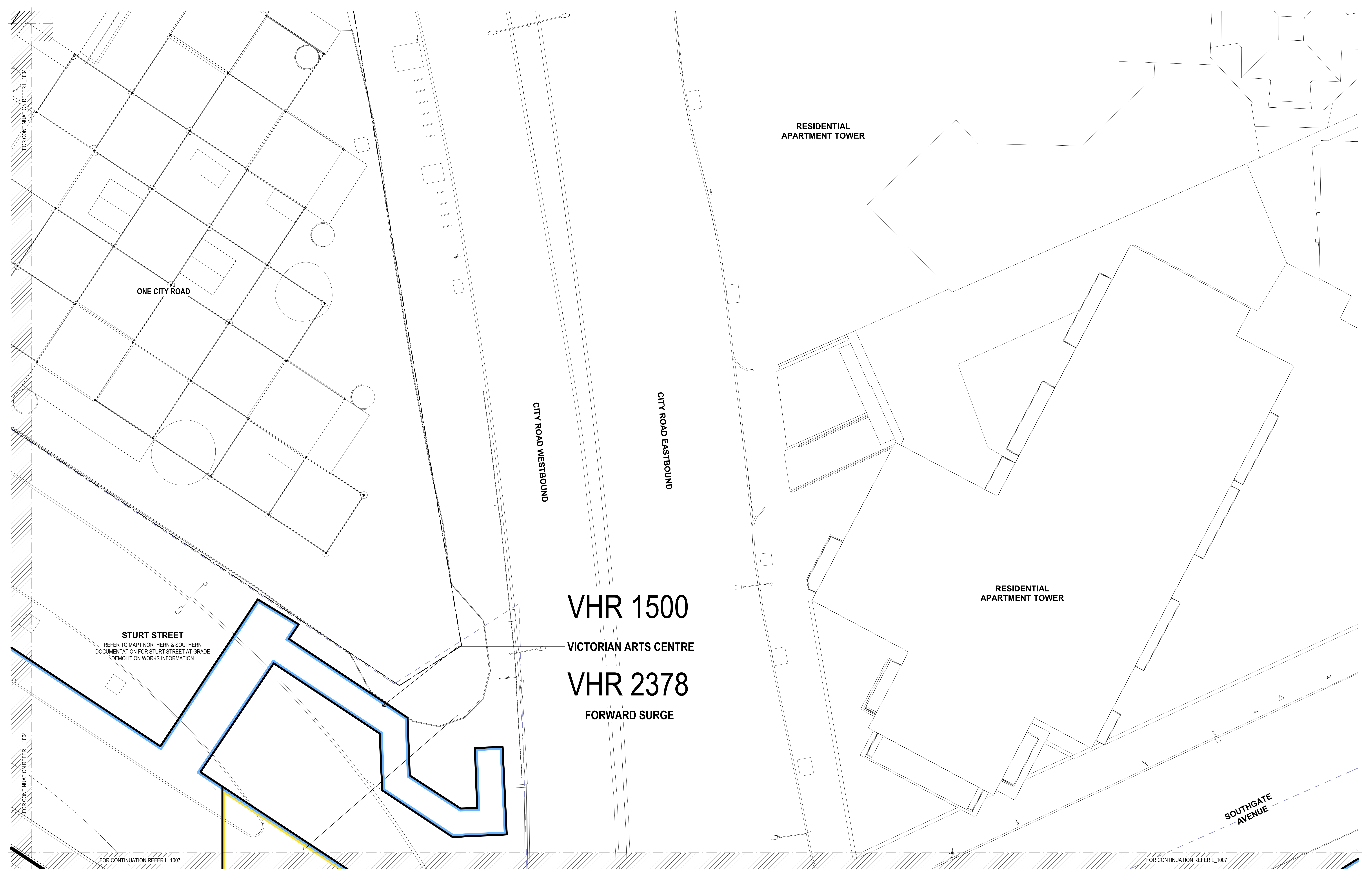

**LEAD CONSULTANT**

**Hassell**

Hassell LTD ABN 24 007 711 435  
61 Little Collins Street  
Melbourne Vic 3000 Australia  
T +61 3 8102 3000  
melbourn@hassell.com.au  
Architect Directors VIC:  
Mark Loughran 18222  
Brenden Kelly 23262  
Liz Weiragath 00113

**CONSULTANT TEAM**

**SO-IL** **wsp** **Super Bloom** **PHILIP CHUN** **VIPAC**

**NORTHROP** **WATERPROOFING** **STEVENS WARRING** **PURCELL** **MGAC**

**G & M Connellan Consultants** **JAMES HITCMOUGH** **Nigel Dunnett**

**CLIENT**

**DEVELOPMENT VICTORIA**

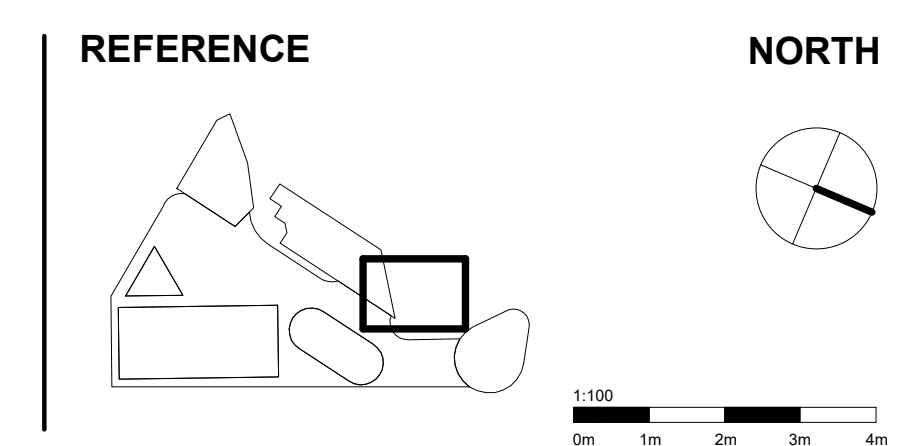

**NOTES**

1. Do not scale drawing. Written dimensions govern
2. All dimensions are in millimeters unless noted otherwise
3. All dimensions shall be verified on site before proceeding with the work. Hassell shall be notified in writing of any discrepancies.
4. This drawing must be read in conjunction with all relevant contracts, specifications and drawings.

This drawing is an uncontrolled copy. Unless noted otherwise  
© Copyright of this drawing is vested in Hassell Ltd.

REV	DESCRIPTION	DATE
A	FOR COORDINATION	09/02/2024
B	FOR COORDINATION	01/03/2024
C	DRAFT DETAIL DESIGN	30/04/2024
D	DETAIL DESIGN	06/06/2024
E	FOR HERITAGE APPROVAL	15/07/2024

**CLIENT**  
DEVELOPMENT VICTORIA

**PROJECT**  
LAAK BOORNAP PUBLIC GARDEN  
MELBOURNE ARTS PRECINCT  
TRANSFORMATION

**STATUS**  
DETAIL DESIGN

**DRAWING TITLE**  
ZONE 05 - EXISTING, DEMOLITION,  
SALVAGED AND RE-USE PLAN

**REVIEWED**  
SQ

**APPROVED**  
BD

**DRAWING NO.**  
L\_1005

**SCALE @ A0**  
1 : 100

**PROJECT NO.**  
013922

**REV NO.**  
E



EXISTING STAIRCASE, HANDRAILS & SURROUNDING RETAINING WALLS TO BE RETAINED AND PROTECTED

EXISTING ARTWORK TO BE SALVAGED AND PROTECTED DURING CONSTRUCTION. STAGING AND STORAGE TO BE COORDINATED WITH ASSET OWNER, NGV

EXISTING GARDEN AND SOIL DEMOLISHED

EXISTING GARDEN BED WALLS TO BE DEMOLISHED. EXISTING SIGNIFICANT PAVEMENT INSTALLED TO BASE OF WALLS TO BE PROTECTED AND RETAINED IN PLACE WITH MINIMAL DISTURPTION

EXISTING BALUSTRADE TO BE DEMOLISHED

EXTENT OF EXISTING SIGNIFICANT COBBLESTONES (PINK GRANITE & BASALT) TO BE CAREFULLY REMOVED, SALVAGED AND STORED FOR RE-USE AND ADAPTATION WITHIN THE PRECINCT.

NATIONAL GALLERY OF VICTORIA INTERNATIONAL

MOUSEHOLE ENTRANCE

EXISTING BALUSTRADE TO BE DEMOLISHED

EXISTING GARDEN BED WALLS, GARDENBED AND SOIL WITHIN TO BE DEMOLISHED. EXISTING SIGNIFICANT PAVEMENT INSTALLED TO BASE OF WALLS TO BE PROTECTED AND RETAINED IN PLACE WITH MINIMAL DISTURPTION

EXISTING STEPS TO BE DEMOLISHED

EXISTING STAIRCASE, HANDRAILS & SURROUNDING RETAINING WALLS TO BE RETAINED AND PROTECTED

PLANTING, SOIL MEDIA AND DRAINAGE IN CENTRE OF EXISTING STAIRCASE TO BE REMOVED

VHR 1499

NATIONAL GALLERY OF VICTORIA

EXISTING GARDEN BED WALLS TO BE DEMOLISHED

EXTENT OF EXISTING SIGNIFICANT COBBLESTONES (PINK GRANITE & BASALT) TO BE CAREFULLY REMOVED, SALVAGED AND STORED FOR RE-USE AND ADAPTATION WITHIN THE PRECINCT

THE LINK  
EXISTING PUBLIC GARDEN PAVING TO BE RETAINED AND PROTECTED

VHR 1500

VICTORIAN ARTS CENTRE

THEATRES BUILDING

MOAT

NAUTILUS

VHR 2359

ST KILDA ROAD

ST KILDA ROAD

TITLE BOUNDARY

SCD BOUNDARY



LEAD CONSULTANT

Hassell

Hassell LTD ABN 24 007 711 435  
61 Little Collins Street  
Melbourne VIC 3000 Australia  
T +61 3 8102 3000  
melbourne@hassell.com.au  
Architect Directors VIC:  
Mark Loughran 18202  
Brendan Kelly 23560  
Liz Weingarth 00113

CONSULTANT TEAM



S & M Connellan Consultants  
JAMES HITCHMOUGH Nigel Dunnett

CLIENT



REFERENCE

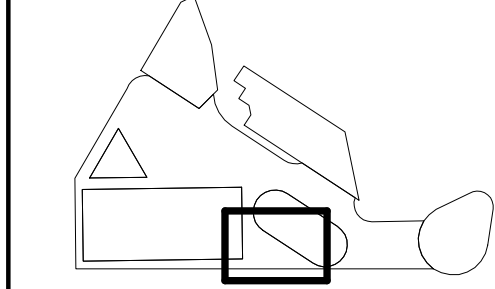

NORTH

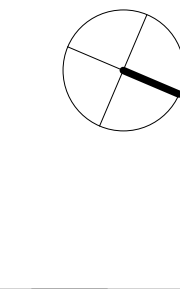

NOTES

1. Do not scale drawing. Written dimensions govern
  2. All dimensions are in millimeters unless noted otherwise
  3. All dimensions shall be verified on site before proceeding with the work. Hassell shall be notified in writing of any discrepancies.
  4. This drawing must be read in conjunction with all relevant contracts, specifications and drawings.
- This drawing is an uncontrolled copy. Unless noted otherwise  
© Copyright of this drawing is vested in Hassell Ltd.

REV DESCRIPTION

A	FOR COORDINATION
B	FOR COORDINATION
C	DRAFT DETAIL DESIGN
D	DETAIL DESIGN
E	FOR HERITAGE APPROVAL
F	FOR HERITAGE APPROVAL

DATE

09/03/2024
01/03/2024
30/04/2024
08/06/2024
15/07/2024
13/09/2024

CLIENT DEVELOPMENT VICTORIA

PROJECT  
LAAK BOORNAP PUBLIC GARDEN  
MELBOURNE ARTS PRECINCT  
TRANSFORMATION

STATUS  
DETAIL DESIGN

DRAWING TITLE  
ZONE 06 - EXISTING, DEMOLITION,  
SALVAGED AND RE-USE PLAN

REVIEWED  
SQ

APPROVED  
BD

DRAWING NO.  
L\_1006

SCALE @ A0  
1 : 100

PROJECT NO.  
013922

REV NO.  
F