

# LYDIARD STREET, BALLARAT HERITAGE GATES RENEWAL LOCALITY PLAN AND DRAWING INDEX

(DATE)

(SIGNATURE)

(BLOCK LETTERS)

Certified By:

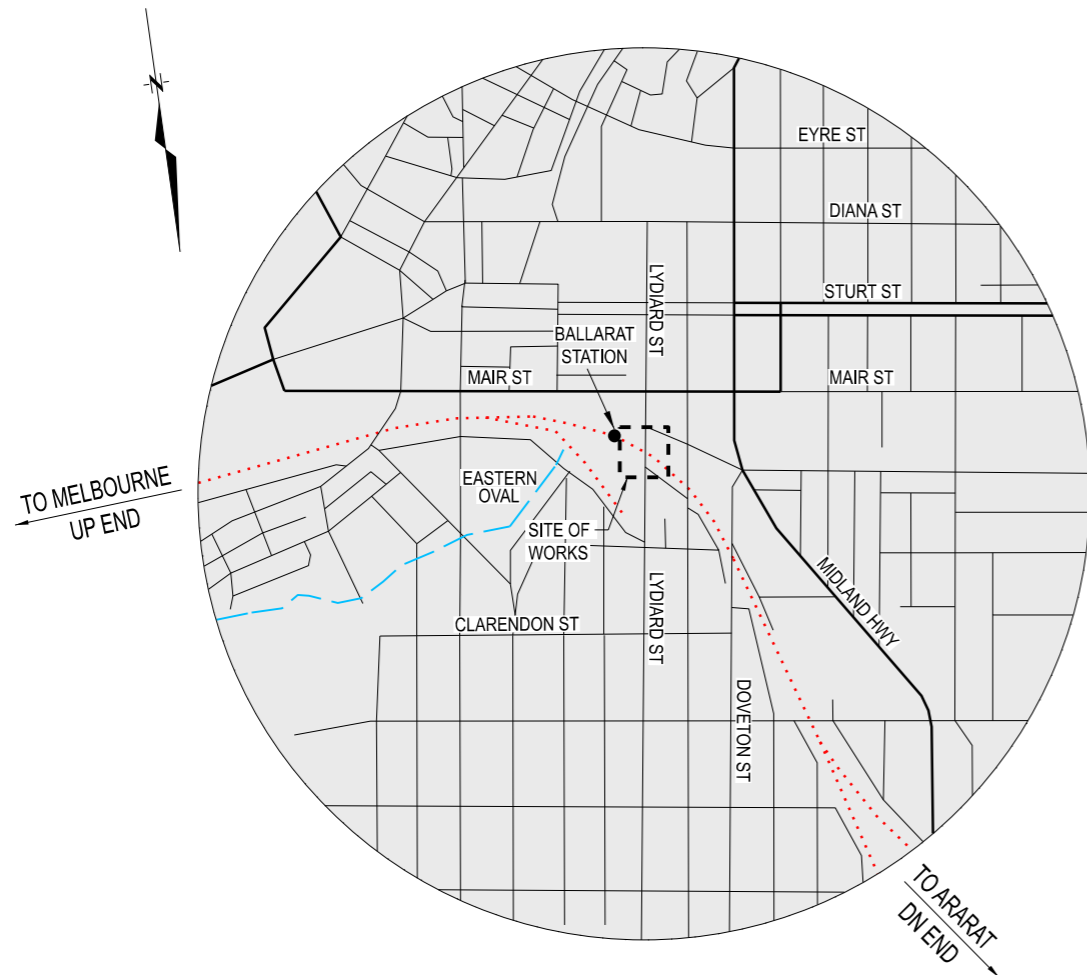

## DRAWING NUMBERS

## TITLE

1731_C0001	LOCALITY PLAN AND DRAWING INDEX
1731_C0002	GENERAL NOTES AND LEGEND
1731_C0011	GENERAL ARRANGEMENT PLAN
1731_C0012	HERITAGE OVERLAY ARRANGEMENT PLAN
1731_C0015	TYPICAL CROSS SECTIONS - SHEET 1
1731_C0016	TYPICAL CROSS SECTIONS - SHEET 2
1731_C0017	TYPICAL CROSS SECTIONS - SHEET 3
1731_C0021	TYPICAL DETAILS - SHEET 1
1731_C0022	TYPICAL DETAILS - SHEET 2

FINAL DESIGN

NOT FOR CONSTRUCTION

2/07/2024 10:44:47 AM

Revised By	In Serv	Rev.	Date	Description	Designed	Checked	Ind. Review	Approved
KINSLEY GROUP		C	02/07/24	FINAL DESIGN - ISSUED FOR REVIEW	M JOHNSTONE	A SIM	D ZHANG	A SIM
KINSLEY GROUP		B	14/06/24	FINAL DESIGN - ISSUED FOR REVIEW	M JOHNSTONE	A SIM	D ZHANG	A SIM
KINSLEY GROUP		A	22/03/24	PRELIMINARY DESIGN - ISSUED FOR REVIEW	M JOHNSTONE	A SIM	D ZHANG	A SIM

Consultant

**KINSLEY GROUP**

www.kinsleygroup.com.au

Franchisee / Lessee

This drawing has been prepared by, or compiled from information provided by, persons other than PTV. To the maximum extent permissible by law, PTV takes no responsibility for, and makes no representations in relation to, the completeness, accuracy or quality of any information contained in this drawing. Each user of this drawing releases PTV from all and any loss, damage, cost, expense or liability in relation to the use of, or any reliance on, this drawing or the information contained in it.

All written dimensions take precedence over scaled dimensions.

This drawing is provided only for the information of the person or organisation to whom PTV provides it. It may not be provided to, or used by, any other person without PTV's prior written consent.

**CIVIL STRUCTURAL**

**BALLARAT**

HERITAGE GATES RENEWAL  
LYDIARD STREET - 118.923km

LOCALITY PLAN AND DRAWING INDEX

Up Location East. North. ID#	Down Location East. North. ID#	Datum MGA Z54
------------------------------	--------------------------------	---------------

**PUBLIC TRANSPORT VICTORIA**

File Name 1731\_C0001.dgn

Sheet No. **01 of 01**

In Serv.

Scale N.T.S. Sheet Size A3

Drawn By M JOHNSTONE	Designed By M JOHNSTONE
Checked By A SIM	Ind. Review D ZHANG
Approved A SIM	Approval Date 02/07/24
Drawing Number <b>1731_C0001</b>	Revision <b>C</b>

(DATE)  
 (SIGNATURE)  
 (BLOCK LETTERS)  
 Certified By:  
 10:44:48 AM  
 2/07/2024

**GENERAL NOTES**

- G1. THESE DRAWINGS SHALL BE READ IN CONJUNCTION WITH ALL DRAWINGS AND SPECIFICATIONS AND WITH SUCH OTHER WRITTEN INSTRUCTIONS AS MAY BE ISSUED DURING THE COURSE OF THE CONTRACT. ALL DISCREPANCIES SHALL BE REFERRED TO THE SUPERINTENDENT FOR DECISION BEFORE PROCEEDING WITH THE WORK.
  - G2. ALL DIMENSIONS RELEVANT TO SETTING OUT AND OFF-SITE WORK SHALL BE VERIFIED BY THE CONTRACTOR BEFORE CONSTRUCTION AND FABRICATION COMMENCES. THE ENGINEER'S DRAWINGS SHALL NOT BE SCALED.
  - G3. WORKMANSHIP AND MATERIALS SHALL BE IN ACCORDANCE WITH THE SPECIFICATION, BUILDING CODE OF AUSTRALIA, CURRENT S.A.A. CODES INCLUDING ALL AMENDMENTS, BUILDING REGULATIONS, AND THE REQUIREMENTS OF ANY OTHER RELEVANT STATUTORY AUTHORITIES, EXCEPT WHERE VARIED BY THE CONTRACT DOCUMENTS.
  - G4. THE APPROVAL OF A SUBSTITUTION SHALL BE SOUGHT FROM THE ENGINEER BUT IS NOT AN AUTHORISATION FOR A VARIATION. ANY VARIATION INVOLVED MUST BE TAKEN UP WITH THE SUPERINTENDENT BEFORE THE WORK COMMENCES.
  - G5. ALL DIMENSIONS ARE IN MILLIMETRES UNLESS STATED OTHERWISE. ALL LEVELS ARE EXPRESSED IN METRES.
  - G6. CONTRACT WORKS SHALL NOT COMMENCE UNTIL APPROVED BY RELEVANT AUTHORITIES.
  - G7. THESE DRAWINGS SHALL NOT BE USED FOR CONSTRUCTION UNTIL ISSUED AS "FOR CONSTRUCTION" BY THIS OFFICE.
  - G8. THE CONTRACTOR RETAINS RESPONSIBILITY OF THE WORKS EVEN IF THE ENGINEER HAS INSPECTED THE WORKS DURING CONSTRUCTION.
  - G9. THE DESIGN, CERTIFICATION, CONSTRUCTION AND PERFORMANCE OF FORMWORK AND FALSE WORK SHALL BE THE RESPONSIBILITY OF THE CONTRACTOR, AND SHALL BE CARRIED OUT IN ACCORDANCE WITH THE RELEVANT CODES.
  - G10. DURING CONSTRUCTION THE CONTRACTOR SHALL BE RESPONSIBLE FOR MAINTAINING THE STRUCTURE IN A STABLE CONDITION AND ENSURING NO PART SHALL BE OVER STRESSED UNDER CONSTRUCTION ACTIVITIES. THE CONTRACTOR SHALL DESIGN AND INSTALL TEMPORARY BRACING AS REQUIRED TO KEEP THE WORKS AND EXCAVATION STABLE AT ALL TIMES. WHEN REQUESTED, THE CONTRACTOR SHALL PROVIDE CALCULATIONS TO JUSTIFY THE ADEQUACY OF THE STRUCTURE TO SAFELY WITHSTAND ANY IMPOSED LOADS AND/OR CONSTRUCTION PROCEDURE.
  - G11. IF THE CONTRACTOR INTENDS TO VARY THE SCOPE OR METHOD OF WORKS OR MATERIALS USED THE CONTRACTOR SHALL SUBMIT FULL DETAILS OF THE PROPOSAL TO V/LINE AND THE DESIGN ENGINEER FOR DESIGN CHECK.
  - G12. PRIOR TO ANY EXCAVATION, THE CONTRACTOR SHALL CHECK WITH ALL RELEVANT AUTHORITIES AND OBTAIN ALL NECESSARY PERMITS AND BY SITE EXPLORATION IF NECESSARY FOR THE LOCATION OF ANY EXISTING SERVICES WHICH MAY AFFECT THE WORKS. IF SERVICES ARE FOUND TO EXIST, THEN THE CONTRACTOR SHALL NOTIFY THE SUPERINTENDENT AND OBTAIN INSTRUCTIONS PRIOR TO PROCEEDING.
- STEELWORK**
- S1. ALL WORKMANSHIP AND MATERIALS SHALL BE IN ACCORDANCE WITH AS 4100 AND AS 1554.
  - S2. UNLESS NOTED OTHERWISE:
    - ALL WELDS SHALL BE 6mm CONTINUOUS FILLET WELDS FROM E48XX ELECTRODES, OR EQUIVALENT.
    - ALL WELDS SHALL BE CATEGORY SP.
    - ALL BUTT WELDS SHALL BE COMPLETE PENETRATION BUTT WELDS.
  - S3. THE BOLTING PROCEDURE IS DESIGNATED AS FOLLOWS:
    - 4.6/S - REFERS TO COMMERCIAL BOLTS OF STRENGTH GRADE 4.6 TO AS 1111 TIGHTENED USING STANDARD WRENCH TO A SNUG TIGHT CONDITION.
    - 8.8/S - REFERS TO HIGH STRENGTH BOLTS OF STRENGTH GRADE 8.8 TO AS 1252 TIGHTENED USING A STANDARD WRENCH TO SNUG TIGHT CONDITION.
    - 8.8/TF - REFERS TO HIGH STRENGTH BOLTS OF STRENGTH GRADE 8.8 TO AS 1252, FULLY TENSIONED TO AS 4100, DESIGNED AS A FRICTION TYPE JOINT.
    - 8.8/TB - REFERS TO HIGH STRENGTH BOLTS OF STRENGTH GRADE 8.8 TO AS 1252, FULLY TENSIONED TO AS 4100, DESIGNED AS A BEARING TYPE JOINT.

- S4. ALL BOLTS SHALL BE OF SUCH LENGTH THAT AT LEAST ONE AND A HALF FULL THREAD IS EXPOSED BEYOND THE NUT AFTER THE NUT IS TIGHTENED. A MINIMUM OF ONE WASHER SHALL BE USED UNDER THE NUT IN ALL SITUATIONS. IF TIGHTENING IS CARRIED OUT AT THE HEAD, AN ADDITIONAL WASHER SHALL BE USED UNDER THE HEAD. FOR SLOTTED HOLES USE HARDENED WASHERS UNDER THE NUT AND BOLT HEAD.
- S5. ALL STEEL WORK, INCLUDING MEMBERS AND FIXINGS, SHALL BE HOT DIPPED GALVANISED. COATINGS DAMAGED DURING TRANSPORT AND ERECTION OR BY WELDING SHALL BE MADE GOOD AFTER BEING WIRE-BRUSHED CLEAN.
- S6. HOT DIP GALVANISING SHALL BE COMPLETED FOLLOWING THE COMPLETION OF WELDING WORKS UNLESS OTHERWISE STATED SPECIFICALLY ON THE DESIGN DRAWINGS "WELDING WORKS TO BE COMPLETED ONSITE".
- S7. HOT DIP GALVANISING SHALL BE IN ACCORDANCE WITH RELEVANT AUSTRALIAN STANDARDS AS 1214, AS 1559, AS 4680, AS 4791 AND AS 4792. REPAINT / REPAIR OF DAMAGED GALVANISED SURFACES (eg. SITE WELDS) SHALL BE PAINTED WITH 2 COATS OF APPROVED ZINC RICH PAINT. THE CONTINUOUS AVERAGE ZINC COATING MASS SHALL BE AS FOLLOWS:

COMPONENT	MINIMUM AVERAGE COATING
STEEL 5mm THICK AND OVER	600g/m <sup>2</sup>
STEEL 2mm TO 5mm THICK	450g/m <sup>2</sup>

- S8. COATINGS DAMAGED DURING TRANSPORT AND ERECTION OR BY WELDING SHALL BE MADE GOOD AFTER BEING WIRE-BRUSHED CLEAN, AND RECOATED IN ACCORDANCE WITH NOTE S7.
- S9. DURING FABRICATION REGULAR INSPECTIONS SHALL BE CARRIED OUT BY THE INSPECTOR TO ENSURE THE REQUIRED QUALITY CONTROL IS ADHERED TO.
- S10. UNLESS NOTED OTHERWISE ON THE DRAWINGS, ALL STEEL SHALL BE OF THE FOLLOWING GRADE IN ACCORDANCE WITH THE FOLLOWING AUSTRALIAN STANDARDS:

TYPE OF STEEL	GRADE
UNIVERSAL BEAMS, COLUMNS AND PARALLEL CHANNELS TO AS 3679.1	300 PLUS
WELDED BEAMS TO AS 3679.2	300 PLUS
COLD FORMED SHS AND CHS	350
ALL OTHER STEELWORK	250

- S12. ALL WORKMANSHIP AND MATERIALS SHALL CONFORM TO CONSTRUCTION CATEGORY 3 (CC3) IN ACCORDANCE WITH AS 5131.
- S13. WELD TYPES ARE DESIGNATED AS FOLLOWS:
  - CFW - CONTINUOUS FILLET WELD
  - CPBW - COMPLETE PENETRATION BUTT WELD
  - PPBW - PARTIAL PENETRATION BUTT WELD
  - FSBW - FULL STRENGTH BUTT WELD
- S14. WELDS SHALL CONFORM TO AS 1554 AND WELDING ELECTRODES TO AS 1553. WELDING SHALL BE PERFORMED BY AN EXPERIENCED OPERATOR. THE INSPECTION / TESTING OF ALL WELDS SHALL BE CARRIED OUT BY QUALIFIED PERSONNEL IN ACCORDANCE WITH AS 5131, AS 2214 AND NOTES ON THE DRAWINGS.

**REINFORCEMENT**

- R1. REINFORCEMENT SHOWN ON THE DRAWINGS IS REPRESENTED DIAGRAMMATICALLY AND NOT NECESSARILY SHOWN IN TRUE PROJECTION.
- R2. REINFORCEMENT SYMBOLS :
  - N GRADE 500 DEFORMED REINFORCING BARS, DUCTILITY CLASS N TO AS 4671.
  - R GRADE 25D PLAIN REINFORCING BARS TO AS 1302.
  - W HARD DRAWN STEEL REINFORCING WIRE, GRADE 500 DUCTILITY CLASS L TO AS 4671.
  - TM HARD DRAWN STEEL TRENCH MESH, GRADE 500 DUCTILITY CLASS L TO AS 4671
  - RL RECTANGULAR RIB MESH, GRADE 500 DUCTILITY CLASS L TO AS 4671
  - SL SQUARE RIB MESH, GRADE 500 DUCTILITY CLASS L TO AS 4671

THE NUMBER FOLLOWING THE BAR SYMBOL IS THE NOMINAL BAR DIAMETER IN MILLIMETRES.
- R3. REINFORCEMENT ABBREVIATIONS :
  - EF EACH FACE
  - NF NEAR FACE
  - FF FAR FACE
  - T TOP
  - B OR BTM BOTTOM
  - C CENTRAL
  - LV LENGTH VARIES
- R4. MINIMUM LAPS IN MESH SHALL BE THE LARGER SPACING OF TRANSVERSE WIRES UNLESS SHOWN OTHERWISE.
- R5. MESH SHALL NOT BE LAID ON THE GROUND AND PULLED INTO POSITION THROUGH THE CONCRETE.
- R6. CONCRETE SHALL NOT BE POURED UNTIL FINAL APPROVAL FOR REINFORCEMENT INSPECTION IS OBTAINED.
- R7. SPLICES IN REINFORCEMENT SHALL BE MADE ONLY IN THE POSITION SHOWN ON THE DRAWINGS OR AS OTHERWISE APPROVED BY THE ENGINEER. WHERE THE LAP LENGTH IS NOT SHOWN IT SHALL BE SUFFICIENT TO DEVELOP THE FULL STRENGTH OF THE REINFORCEMENT. BAR LAPS IN MILLIMETRES ARE SHOWN BELOW UNLESS NOTED OTHERWISE.

BAR	MINIMUM LAP LENGTH
N12	350
N16	550
N20	750
N24	1000
N28	1250
N32	1550
N36	1850

THE MINIMUM LAP LENGTH SHOWN SHALL BE INCREASED BY 25% FOR HORIZONTAL BARS WITH 300mm OR MORE CONCRETE CAST BELOW THE BAR.

**CONCRETE**

- C1. ALL WORKMANSHIP AND MATERIALS SHALL BE IN ACCORDANCE WITH AS 3600 EXPOSURE CLASSIFICATION B1.
- C2. CONCRETE SHALL BE SUPPLIED FROM AN APPROVED SOURCE AND COMPLY WITH THE REQUIREMENTS OF THE FOLLOWING STANDARDS, UNLESS NOTED OTHERWISE:
  - AS 3600 CONCRETE STRUCTURES
  - AS 4671 STEEL REINFORCING MATERIALS
  - AS 3972 PORTLAND CEMENT
  - AS 1379 READY-MIXED CONCRETE
  - AS 2758.1 CONCRETE AGGREGATES
- C3. UNLESS NOTED OTHERWISE ALL CEMENT SHALL BE "GP" GENERAL PURPOSE CEMENT AND COMPLIED WITH AS 3972. RAPID HARDENING CEMENT CONTAINING SUPERSULPHATE AND CHLORIDE AND HIGH ALUMINA CEMENT SHALL NOT BE USED. FLY ASH AND SILICA FUME SHALL ONLY BE USED IN QUANTITIES ALLOWED BY "GB" CEMENT DESIGN CONCRETE MIX.
- C4. MINIMUM CONCRETE COMPRESSIVE STRENGTH AT 28 DAYS (f<sub>c</sub>) SHALL BE 40MPa.
- C5. ALL SUPPLIED CONCRETE SHALL HAVE A MAXIMUM NOMINAL AGGREGATE SIZE OF 20mm.
- C6. THE FINISHED CONCRETE SHALL BE A DENSE HOMOGENOUS MASS, COMPLETELY FILLING THE FORMWORK THOROUGHLY EMBEDDING THE REINFORCEMENT AND FREE OF HONEY COMBING.
- C7. ALL CONCRETE INTERFACES SHALL BE ROUGHENED TO ENSURE A SATISFACTORY BOND BETWEEN ADJACENT CONCRETE SURFACES U.N.O. ALL CONCRETE SURFACES SHALL BE CLEAN AND FREE OF LAITANCE.
- C9. ALL CONCRETE SHALL BE THOROUGHLY COMPACTED USING VIBRATION EQUIPMENT.
- C10. MINIMUM CLEAR CONCRETE COVER TO ALL REINFORCEMENT SHALL BE 50mm UNLESS CAST AGAINST THE GROUND WHERE THE CLEAR COVER SHALL BE 80mm UNLESS OTHERWISE NOTED.
- C11. EXPOSED EDGES OF CONCRETE SHALL BE PROVIDED WITH 20x20 CHAMFERS UNLESS NOTED OTHERWISE.
- C12. ALL EXTERNAL FINISHES SHALL COMPLY WITH AT LEAST CLASS 2 FINISH TO AS3610.1

**FINAL DESIGN**  
**NOT FOR CONSTRUCTION**

 www.kinsleygroup.com.au Franchisee / Lessee 								This drawing has been prepared by, or compiled from information provided by, persons other than PTV. To the maximum extent permissible by law, PTV takes no responsibility for, and makes no representations in relation to, the completeness, accuracy or quality of any information contained in this drawing. Each user of this drawing releases PTV from all and any loss, damage, cost, expense or liability in relation to the use of, or any reliance on, this drawing or the information contained in it.  All written dimensions take precedence over scaled dimensions.  This drawing is provided only for the information of the person or organisation to whom PTV provides it. It may not be provided to, or used by, any other person without PTV's prior written consent.				<b>CIVIL STRUCTURAL</b> <b>BALLARAT</b> HERITAGE GATES RENEWAL LYDIARD STREET - 118.923km GENERAL NOTES AND SPECIFICATIONS			 File Name 1731_C0002.dgn Sheet No. <b>01 of 01</b> In Serv. Scale N.T.S. Sheet Size A3		Drawn By M JOHNSTONE Checked By A SIM Approved A SIM Drawing Number <b>1731_C0002</b>		Designed By M JOHNSTONE Ind. Review D ZHANG Approval Date 02/07/24 Revision <b>C</b>	
KINSLEY GROUP	C	02/07/24	FINAL DESIGN - ISSUED FOR REVIEW	M JOHNSTONE	A SIM	D ZHANG	A SIM													
KINSLEY GROUP	B	14/06/24	FINAL DESIGN - ISSUED FOR REVIEW	M JOHNSTONE	A SIM	D ZHANG	A SIM													
KINSLEY GROUP	A	22/03/24	PRELIMINARY DESIGN - ISSUED FOR REVIEW	M JOHNSTONE	A SIM	D ZHANG	A SIM													
Revised By	In Serv	Rev.	Date	Description	Designed	Checked	Ind. Review	Approved												

(DATE)

(SIGNATURE)

(BLOCK LETTERS)

Certified By:

**WARNING**

BEWARE OF UNDERGROUND SERVICES  
THE LOCATIONS OF UNDERGROUND SERVICES ARE APPROXIMATE ONLY AND THEIR EXACT POSITION SHOULD BE PROVEN ON SITE. NO GUARANTEE IS GIVEN THAT ALL EXISTING SERVICES ARE SHOWN.



SIGN 1



SIGN 2

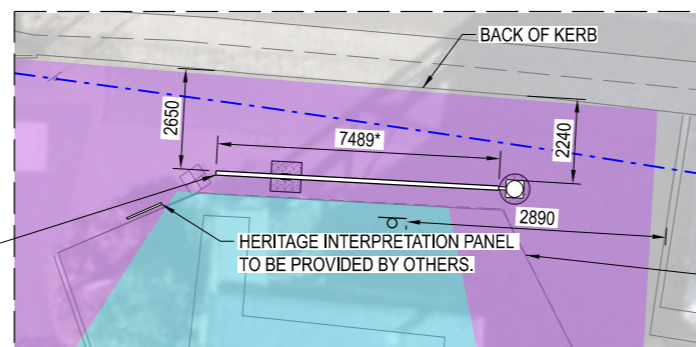

RESTORED 4No. PANEL HERITAGE GATE ASSEMBLY TO BE RELOCATED AND POSITIONED ON NEW SUPPORT STRUCTURE OUTSIDE HERITAGE VICTORIA SITE BOUNDARY.

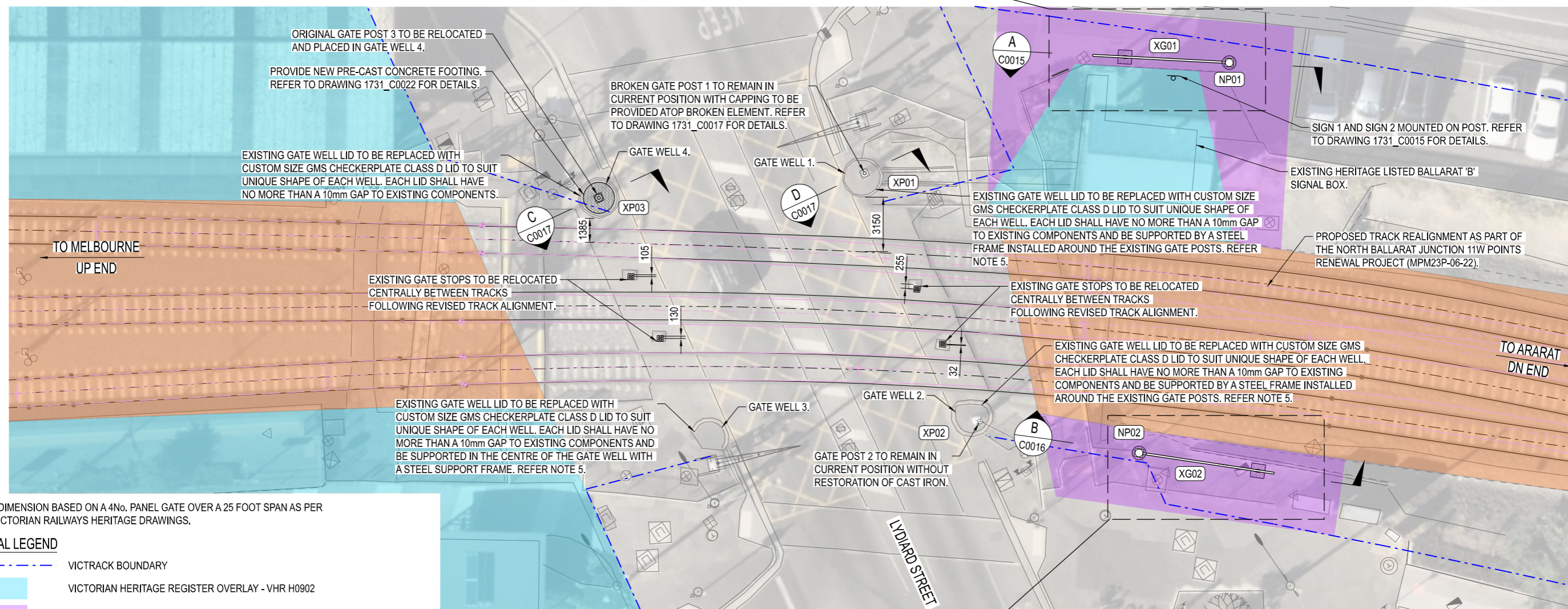

ORIGINAL GATE POST 3 TO BE RELOCATED AND PLACED IN GATE WELL 4.

PROVIDE NEW PRE-CAST CONCRETE FOOTING. REFER TO DRAWING 1731\_C0022 FOR DETAILS.

EXISTING GATE WELL LID TO BE REPLACED WITH CUSTOM SIZE GMS CHECKERPLATE CLASS D LID TO SUIT UNIQUE SHAPE OF EACH WELL. EACH LID SHALL HAVE NO MORE THAN A 10mm GAP TO EXISTING COMPONENTS.

BROKEN GATE POST 1 TO REMAIN IN CURRENT POSITION WITH CAPPING TO BE PROVIDED ATOP BROKEN ELEMENT. REFER TO DRAWING 1731\_C0017 FOR DETAILS.

EXISTING GATE WELL LID TO BE REPLACED WITH CUSTOM SIZE GMS CHECKERPLATE CLASS D LID TO SUIT UNIQUE SHAPE OF EACH WELL. EACH LID SHALL HAVE NO MORE THAN A 10mm GAP TO EXISTING COMPONENTS AND BE SUPPORTED BY A STEEL FRAME INSTALLED AROUND THE EXISTING GATE POSTS. REFER NOTE 5.

SIGN 1 AND SIGN 2 MOUNTED ON POST. REFER TO DRAWING 1731\_C0015 FOR DETAILS.

EXISTING HERITAGE LISTED BALLARAT 'B' SIGNAL BOX.

PROPOSED TRACK REALIGNMENT AS PART OF THE NORTH BALLARAT JUNCTION 11W POINTS RENEWAL PROJECT (MPM23P-06-22).

EXISTING GATE STOPS TO BE RELOCATED CENTRALLY BETWEEN TRACKS FOLLOWING REVISED TRACK ALIGNMENT.

EXISTING GATE STOPS TO BE RELOCATED CENTRALLY BETWEEN TRACKS FOLLOWING REVISED TRACK ALIGNMENT.

EXISTING GATE WELL LID TO BE REPLACED WITH CUSTOM SIZE GMS CHECKERPLATE CLASS D LID TO SUIT UNIQUE SHAPE OF EACH WELL. EACH LID SHALL HAVE NO MORE THAN A 10mm GAP TO EXISTING COMPONENTS AND BE SUPPORTED BY A STEEL FRAME INSTALLED AROUND THE EXISTING GATE POSTS. REFER NOTE 5.

EXISTING GATE WELL LID TO BE REPLACED WITH CUSTOM SIZE GMS CHECKERPLATE CLASS D LID TO SUIT UNIQUE SHAPE OF EACH WELL. EACH LID SHALL HAVE NO MORE THAN A 10mm GAP TO EXISTING COMPONENTS AND BE SUPPORTED IN THE CENTRE OF THE GATE WELL WITH A STEEL SUPPORT FRAME. REFER NOTE 5.

GATE POST 2 TO REMAIN IN CURRENT POSITION WITHOUT RESTORATION OF CAST IRON.

\* DIMENSION BASED ON A 4No. PANEL GATE OVER A 25 FOOT SPAN AS PER VICTORIAN RAILWAYS HERITAGE DRAWINGS.

**GENERAL LEGEND**

- VICTRACK BOUNDARY
- VICTORIAN HERITAGE REGISTER OVERLAY - VHR H0902
- PROPOSED ADDITION TO VICTORIAN HERITAGE REGISTER OVERLAY - VHR H0902
- OPERATING CORRIDOR
- NORTH BALLARAT JUNCTION TRACK ALIGNMENT
- XP01 EXISTING GATE POST #1
- NP01 INTRODUCED GATE POST #1
- XG01 REINSTATED TIMBER GATE #1

RESTORED 4No. PANEL HERITAGE GATE ASSEMBLY TO BE RELOCATED AND POSITIONED ON NEW SUPPORT STRUCTURE OUTSIDE HERITAGE VICTORIA SITE BOUNDARY.

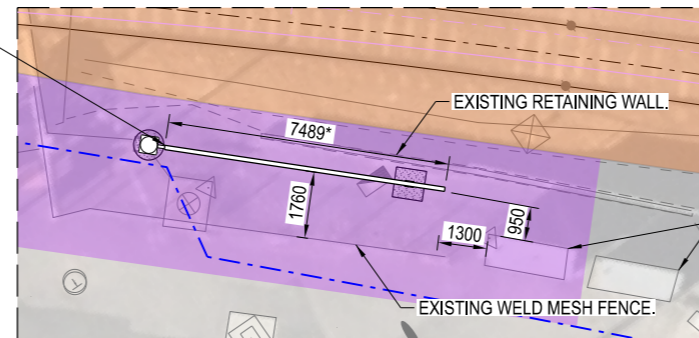

**NOTES**

- REFER TO DRAWING 1731\_C0002 FOR GENERAL NOTES AND SPECIFICATIONS.
- ALL DIMENSIONS ARE IN MILLIMETRES UNLESS NOTED OTHERWISE.
- ALL EXISTING WELLS TO BE CLEANED UP AND EXISTING DRAINAGE TO BE FREE OF DEBRIS AND LEAVES.
- REAR STAYS ARE NOT PROPOSED TO BE REINSTATED.
- STEEL SUPPORT FRAME DIMENSIONS AND DETAILS SHALL BE CONFIRMED FOR EACH GATE WELL ON-SITE BY THE CONSTRUCTION CONTRACTOR AND SHOP DRAWINGS OF THE STEEL SUPPORT FRAME SUBMITTED TO KINSLEY GROUP FOR REVIEW AND APPROVAL.

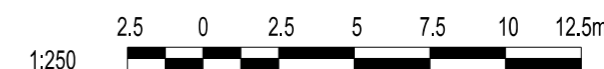

**FINAL DESIGN**  
**NOT FOR CONSTRUCTION**

4:48:59 PM  
4/07/2024

Revised By	In Serv	Rev.	Date	Description	Designed	Checked	Ind. Review	Approved
KINSLEY GROUP		C	02/07/24	FINAL DESIGN - ISSUED FOR REVIEW	M JOHNSTONE	A SIM	D ZHANG	A SIM
KINSLEY GROUP		B	14/06/24	FINAL DESIGN - ISSUED FOR REVIEW	M JOHNSTONE	A SIM	D ZHANG	A SIM
KINSLEY GROUP		A	22/03/24	PRELIMINARY DESIGN - ISSUED FOR REVIEW	M JOHNSTONE	A SIM	D ZHANG	A SIM

Consultant  
**KINSLEY GROUP**  
www.kinsleygroup.com.au  
Franchisee / Lessee  
**V/Line**

This drawing has been prepared by, or compiled from information provided by, persons other than PTV. To the maximum extent permissible by law, PTV takes no responsibility for, and makes no representations in relation to, the completeness, accuracy or quality of any information contained in this drawing. Each user of this drawing releases PTV from all and any loss, damage, cost, expense or liability in relation to the use of, or any reliance on, this drawing or the information contained in it.

All written dimensions take precedence over scaled dimensions.

This drawing is provided only for the information of the person or organisation to whom PTV provides it. It may not be provided to, or used by, any other person without PTV's prior written consent.

**CIVIL STRUCTURAL**  
**BALLARAT**  
HERITAGE GATES RENEWAL  
LYDIARD STREET - 118.923km  
GENERAL ARRANGEMENT PLAN

Up Location East. North. ID#	Down Location East. North. ID#	Datum MGA Z54
------------------------------	--------------------------------	---------------

**PUBLIC TRANSPORT VICTORIA** **PTV**

File Name 1731\_C0011.dgn  
Sheet No. 01 of 01  
In Serv.  
Scale 1:250 Sheet Size A3

Drawn By M JOHNSTONE	Designed By M JOHNSTONE
Checked By A SIM	Ind. Review D ZHANG
Approved A SIM	Approval Date 02/07/24
Drawing Number 1731_C0011	Revision C

(DATE)

(SIGNATURE)

(BLOCK LETTERS)

Certified By:

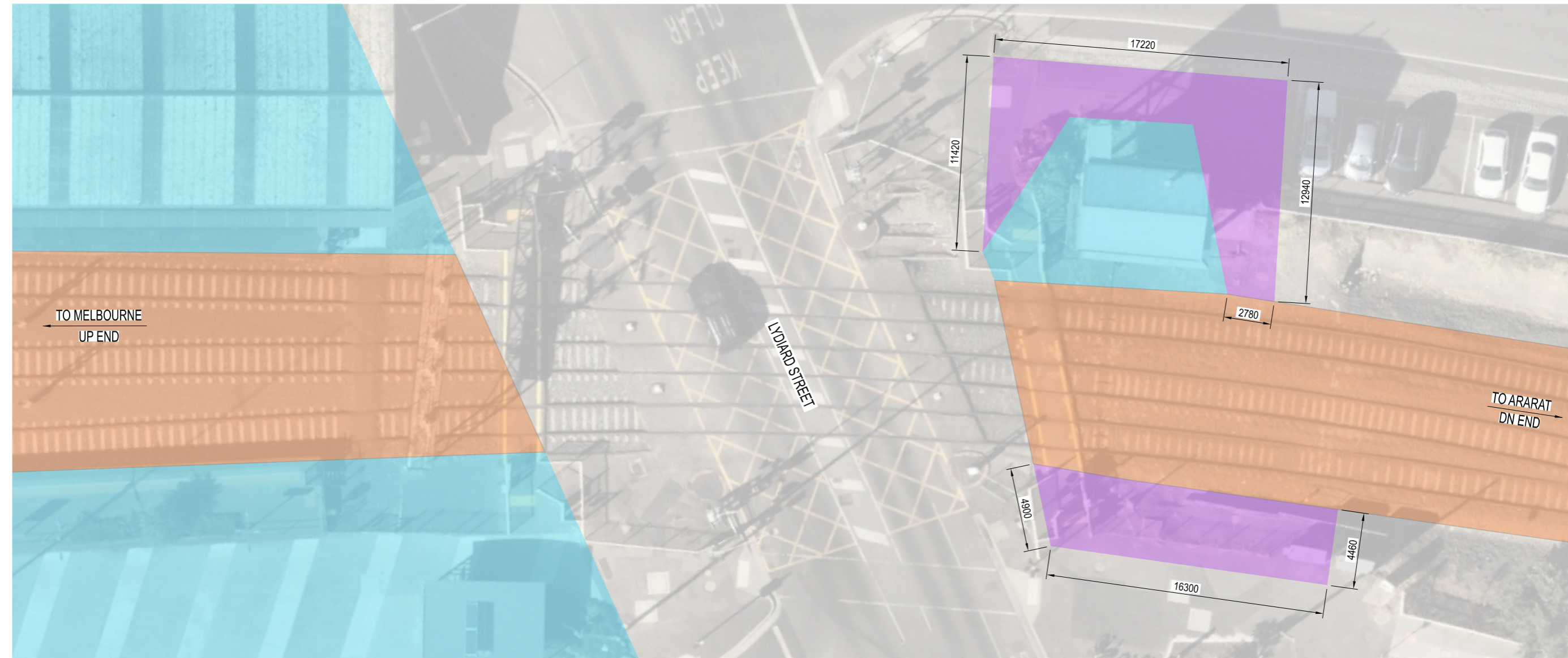

GENERAL LEGEND

- VICTORIAN HERITAGE REGISTER OVERLAY - VHR H0902
- PROPOSED ADDITION TO VICTORIAN HERITAGE REGISTER OVERLAY - VHR H0902
- OPERATING CORRIDOR



FINAL DESIGN

NOT FOR CONSTRUCTION

10:44:52 AM  
2/07/2024

Revised By	In Serv	Rev.	Date	Description	Designed	Checked	Ind. Review	Approved
KINSLEY GROUP		B	02/07/24	FINAL DESIGN - ISSUED FOR REVIEW	M JOHNSTONE	A SIM	D ZHANG	A SIM
KINSLEY GROUP		A	14/06/24	FINAL DESIGN - ISSUED FOR REVIEW	M JOHNSTONE	A SIM	D ZHANG	A SIM

Consultant

KINSLEY GROUP

www.kinsleygroup.com.au

Franchisee / Lessee

This drawing has been prepared by, or compiled from information provided by, persons other than PTV. To the maximum extent permissible by law, PTV takes no responsibility for, and makes no representations in relation to, the completeness, accuracy or quality of any information contained in this drawing. Each user of this drawing releases PTV from all and any loss, damage, cost, expense or liability in relation to the use of, or any reliance on, this drawing or the information contained in it.

All written dimensions take precedence over scaled dimensions.

This drawing is provided only for the information of the person or organisation to whom PTV provides it. It may not be provided to, or used by, any other person without PTV's prior written consent.

**CIVIL STRUCTURAL**  
**BALLARAT**  
HERITAGE GATES RENEWAL  
LYDIARD STREET - 118.923km  
HERITAGE OVERLAY ARRANGEMENT PLAN

Up Location East. North. ID#	Down Location East. North. ID#	Datum MGA Z54
------------------------------	--------------------------------	---------------

**PUBLIC TRANSPORT VICTORIA**

File Name 1731\_C0012.dgn

Sheet No. **01 of 01**

In Serv.

Scale 1:250 Sheet Size A3

Drawn By M JOHNSTONE	Designed By M JOHNSTONE
Checked By A SIM	Ind. Review D ZHANG
Approved A SIM	Approval Date 02/07/24
Drawing Number <b>1731_C0012</b>	Revision <b>B</b>

(DATE)

(SIGNATURE)

(BLOCK LETTERS)

Certified By:

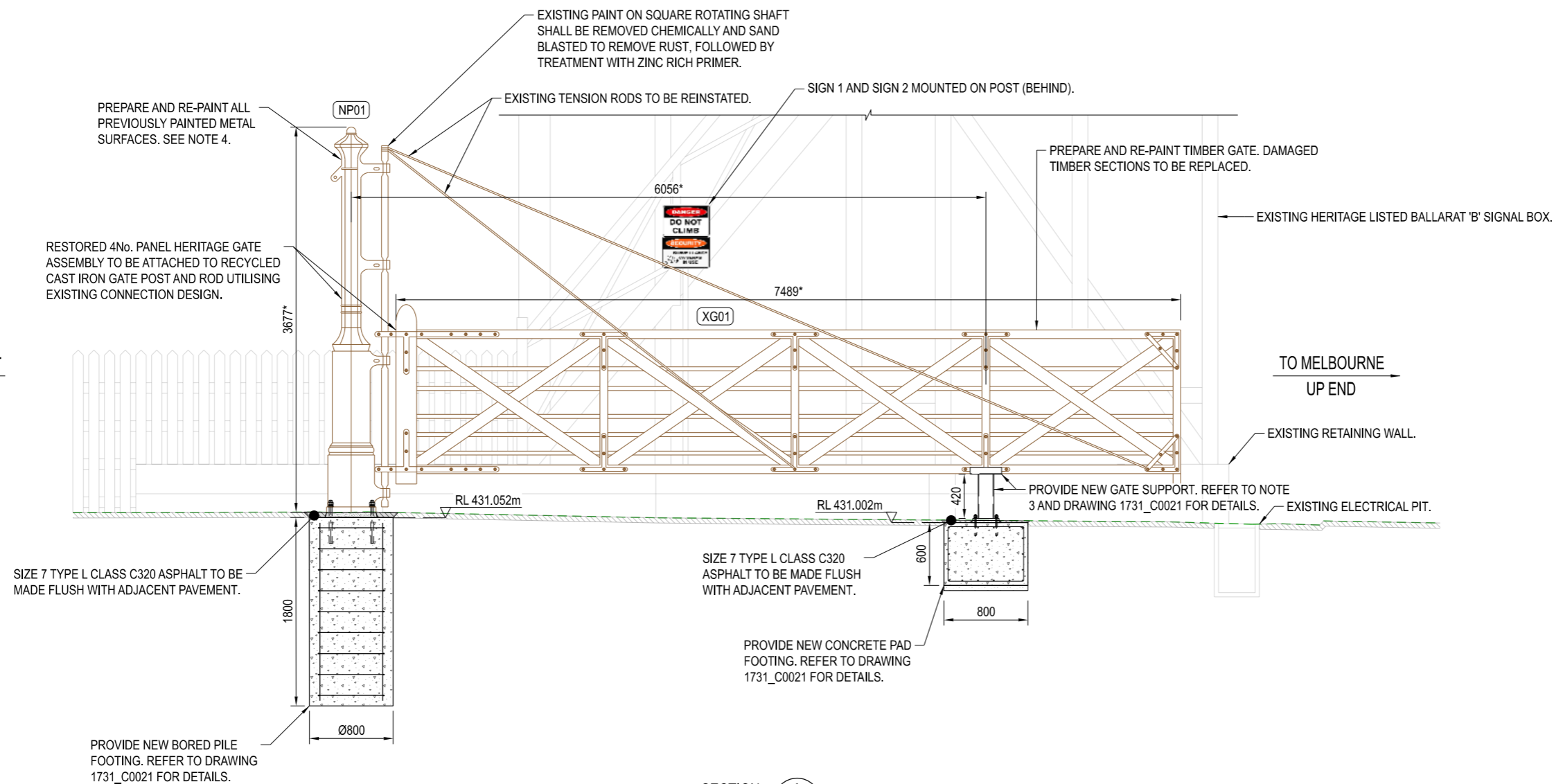

SECTION A  
1: 50  
C0011

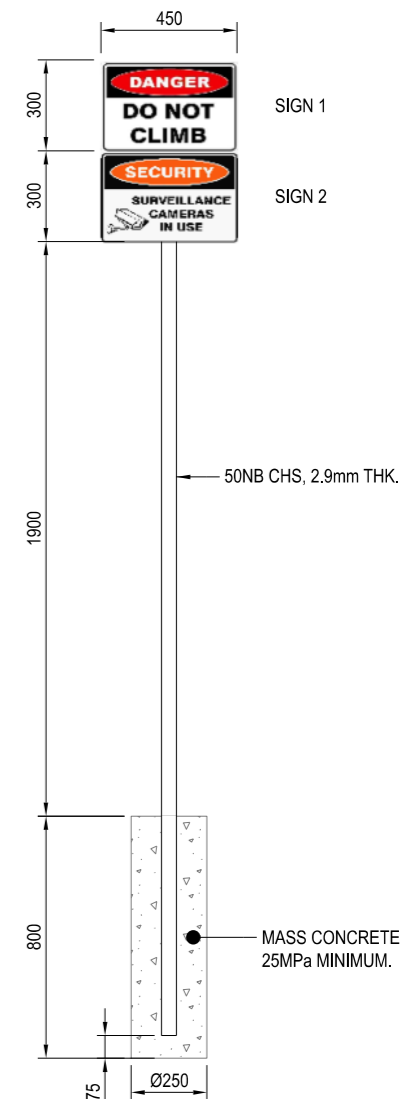

SIGNPOST DETAILS  
SCALE 1:25

\* DIMENSION BASED ON A 4No. PANEL GATE OVER A 25 FOOT SPAN WITH LARGE GATE COLUMN AS PER VICTORIAN RAILWAYS HERITAGE DRAWINGS.

NOTES

- REFER TO DRAWING 1731\_C0002 FOR GENERAL NOTES AND SPECIFICATIONS.
- ALL DIMENSIONS ARE IN MILLIMETRES UNLESS NOTED OTHERWISE.
- CONSTRUCTION TO ENSURE GATE IS AT NO POINT CANTILEVERED WITHOUT PROPOSED GATE SUPPORT OR TEMPORARY PROPPING.
- METAL ELEMENTS SHALL BE PAINTED WHITE TO MATCH THE EXISTING HERITAGE COLOUR AT THE SITE EXCLUDING THE SQUARE ROTATING SHAFT. A RELEVANT ARCHITECTURAL PAINT REPRESENTATIVE SHALL CONFIRM THE COLOUR AND SHEEN LEVEL PRIOR TO PAINTING.



FINAL DESIGN  
NOT FOR CONSTRUCTION

4:55:49 PM  
4/07/2024

Revised By	In Serv	Rev.	Date	Description	Designed	Checked	Ind. Review	Approved
KINSLEY GROUP		C	02/07/24	FINAL DESIGN - ISSUED FOR REVIEW	M JOHNSTONE	A SIM	D ZHANG	A SIM
KINSLEY GROUP		B	14/06/24	FINAL DESIGN - ISSUED FOR REVIEW	M JOHNSTONE	A SIM	D ZHANG	A SIM
KINSLEY GROUP		A	22/03/24	PRELIMINARY DESIGN - ISSUED FOR REVIEW	M JOHNSTONE	A SIM	D ZHANG	A SIM

Consultant  
**KINSLEY GROUP**  
www.kinsleygroup.com.au  
Franchisee / Lessee  
**V/Line**

This drawing has been prepared by, or compiled from information provided by, persons other than PTV. To the maximum extent permissible by law, PTV takes no responsibility for, and makes no representations in relation to, the completeness, accuracy or quality of any information contained in this drawing. Each user of this drawing releases PTV from all and any loss, damage, cost, expense or liability in relation to the use of, or any reliance on, this drawing or the information contained in it.  
All written dimensions take precedence over scaled dimensions.  
This drawing is provided only for the information of the person or organisation to whom PTV provides it. It may not be provided to, or used by, any other person without PTV's prior written consent.

**CIVIL STRUCTURAL**  
**BALLARAT**  
HERITAGE GATES RENEWAL  
LYDIARD STREET - 118.923km  
TYPICAL CROSS SECTIONS - SHEET 1

Up Location East. North. ID#	Down Location East. North. ID#	Datum MGA Z54
------------------------------	--------------------------------	---------------

**PUBLIC TRANSPORT VICTORIA** **PTV**

File Name 1731\_C0015.dgn  
Sheet No. 01 of 01  
In Serv.  
Scale VARIES Sheet Size A3

Drawn By M JOHNSTONE	Designed By M JOHNSTONE
Checked By A SIM	Ind. Review D ZHANG
Approved A SIM	Approval Date 02/07/24
Drawing Number 1731_C0015	Revision C

(DATE)

(SIGNATURE)

(BLOCK LETTERS)

Certified By:

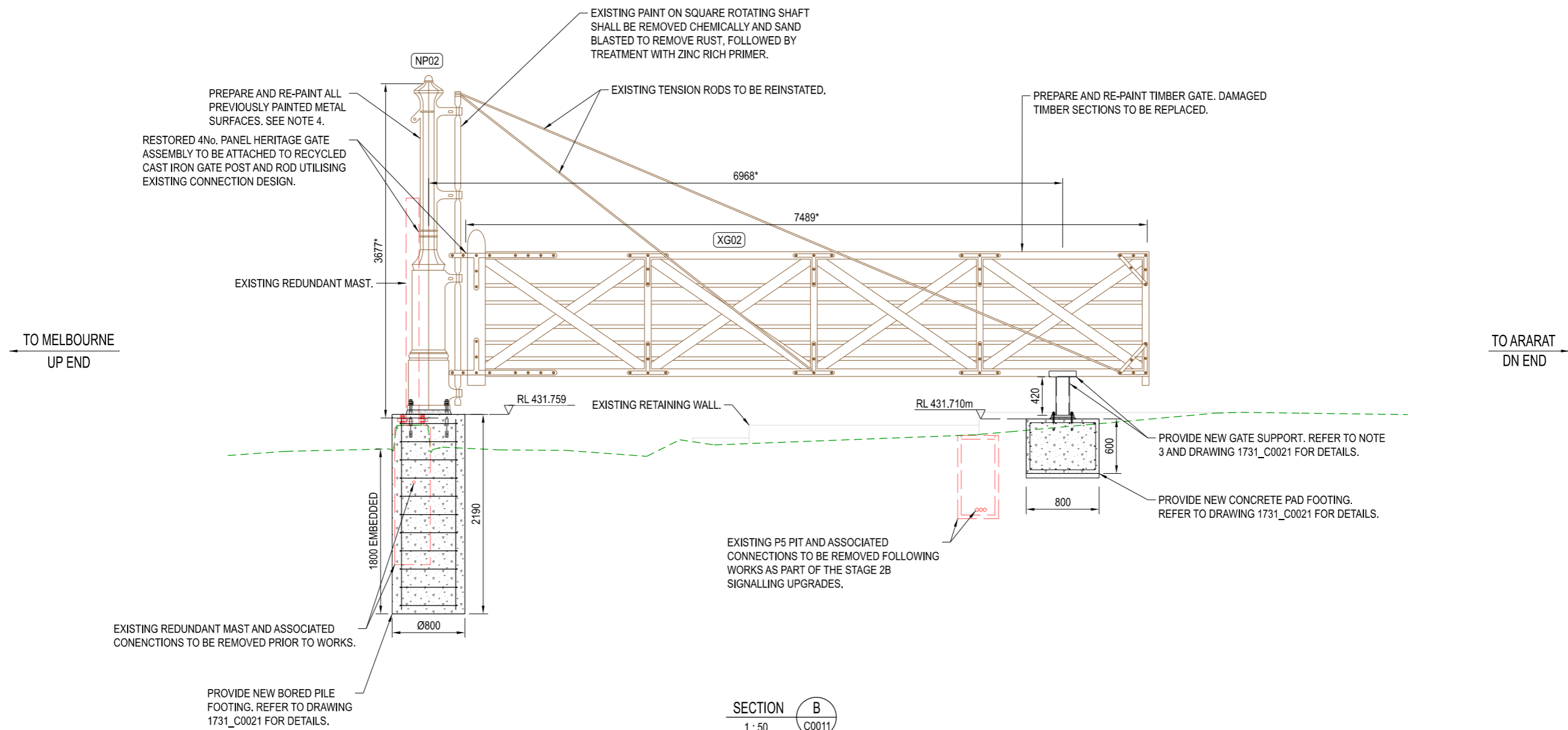

\* DIMENSION BASED ON A 4No. PANEL GATE OVER A 25 FOOT SPAN WITH LARGE GATE COLUMN AS PER VICTORIAN RAILWAYS HERITAGE DRAWINGS.

**NOTES**

- REFER TO DRAWING 1731\_C0002 FOR GENERAL NOTES AND SPECIFICATIONS.
- ALL DIMENSIONS ARE IN MILLIMETRES UNLESS NOTED OTHERWISE.
- CONSTRUCTION TO ENSURE GATE IS AT NO POINT CANTILEVERED WITHOUT PROPOSED GATE SUPPORT OR TEMPORARY PROPPING.
- METAL ELEMENTS SHALL BE PAINTED WHITE TO MATCH THE EXISTING HERITAGE COLOUR AT THE SITE. A RELEVANT ARCHITECTURAL PAINT REPRESENTATIVE SHALL CONFIRM THE COLOUR AND SHEEN LEVEL PRIOR TO PAINTING.



FINAL DESIGN

NOT FOR CONSTRUCTION

Revised By	In Serv	Rev.	Date	Description	Designed	Checked	Ind. Review	Approved
KINSLEY GROUP		C	02/07/24	FINAL DESIGN - ISSUED FOR REVIEW	M JOHNSTONE	A SIM	D ZHANG	A SIM
KINSLEY GROUP		B	14/06/24	FINAL DESIGN - ISSUED FOR REVIEW	M JOHNSTONE	A SIM	D ZHANG	A SIM
KINSLEY GROUP		A	22/03/24	PRELIMINARY DESIGN - ISSUED FOR REVIEW	M JOHNSTONE	A SIM	D ZHANG	A SIM

Consultant

KINSLEY GROUP

www.kinsleygroup.com.au

Franchisee / Lessee

This drawing has been prepared by, or compiled from information provided by, persons other than PTV. To the maximum extent permissible by law, PTV takes no responsibility for, and makes no representations in relation to, the completeness, accuracy or quality of any information contained in this drawing. Each user of this drawing releases PTV from all and any loss, damage, cost, expense or liability in relation to the use of, or any reliance on, this drawing or the information contained in it.

All written dimensions take precedence over scaled dimensions.

This drawing is provided only for the information of the person or organisation to whom PTV provides it. It may not be provided to, or used by, any other person without PTV's prior written consent.

**CIVIL STRUCTURAL**

**BALLARAT**

HERITAGE GATES RENEWAL  
LYDIARD STREET - 118.923km  
TYPICAL CROSS SECTIONS - SHEET 2

Up Location East. North. ID#	Down Location East. North. ID#	Datum MGA Z54
------------------------------	--------------------------------	---------------

**PUBLIC TRANSPORT VICTORIA**

File Name 1731\_C0016.dgn

Sheet No. **01 of 01**

In Serv.

Scale 1:50 Sheet Size A3

Drawn By M JOHNSTONE	Designed By M JOHNSTONE
Checked By A SIM	Ind. Review D ZHANG
Approved A SIM	Approval Date 02/07/24
Drawing Number <b>1731_C0016</b>	Revision <b>C</b>

2:07/2024

(DATE)

(SIGNATURE)

(BLOCK LETTERS)

Certified By:

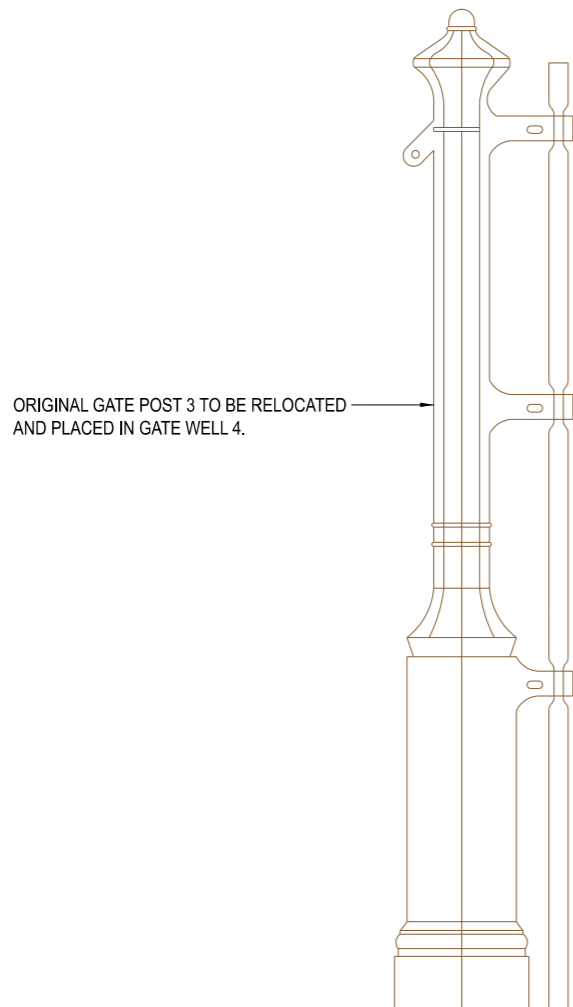

BROKEN ELEMENT TO BE ANGLE GRINDED TO CREATE FLAT SURFACE.

PROVIDE 10mm THK CUSTOM BESPOKE STEEL CAP TO SUIT WIDTH AND OUTLINE OF EXISTING GATE POST. SEE NOTE 2.

CAP TO BE ARC WELDED TO POST USING 2.5mm NICKEL RODS.

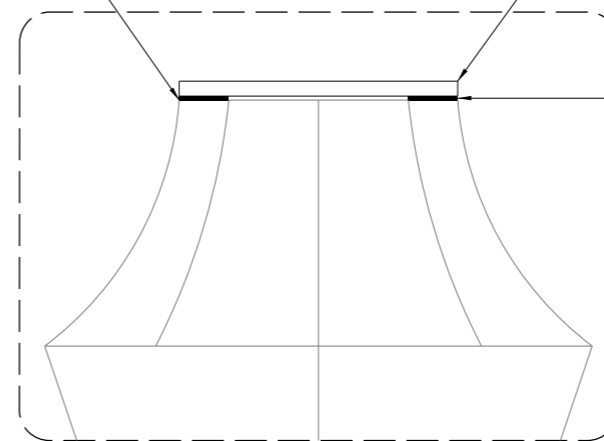

BROKEN GATE POST 1 TO REMAIN IN CURRENT POSITION. POST SHALL BE PREPARED AND RE-PAINTED.

STEEL SUPPORT FRAME TO BE PROVIDED AROUND GATE POST TO PROVIDE SUPPORT FOR PIT LID. STEEL FRAME DIMENSIONS AND DETAILS SHALL BE CONFIRMED ON-SITE BY THE CONSTRUCTION CONTRACTOR AND SHOP DRAWINGS SUBMITTED TO KINSLEY GROUP FOR REVIEW AND APPROVAL.

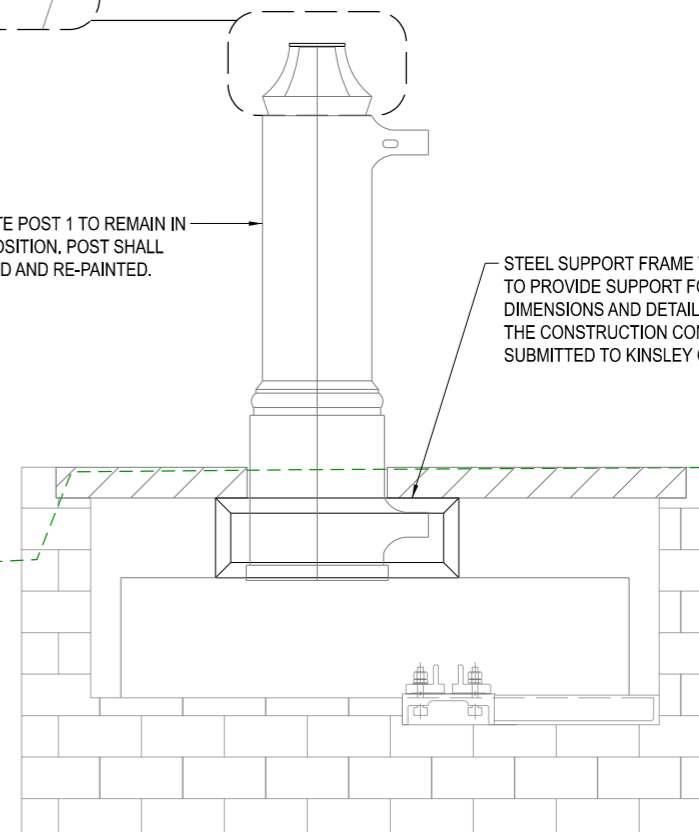

1  
C0022

PROVIDE NEW PRE-CAST CONCRETE FOOTING.

GATE WELL 4.

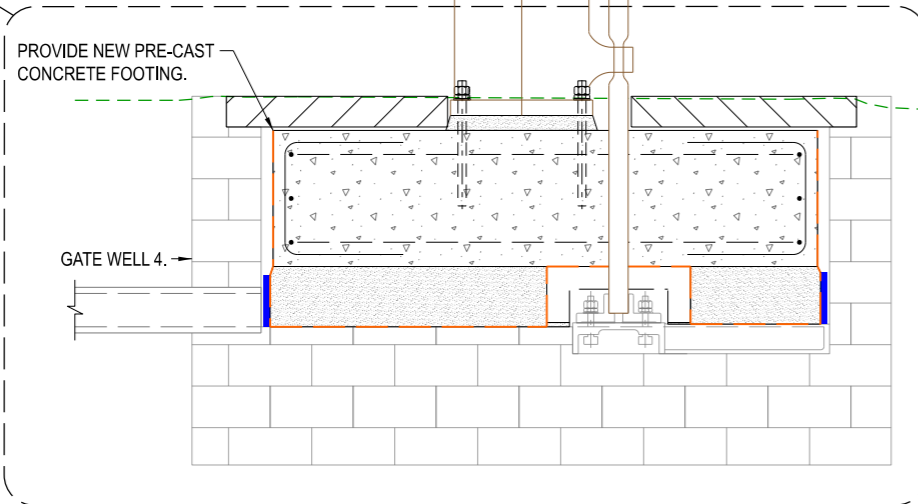

SECTION C  
1:25  
C0011

SECTION D  
1:25  
C0011

NOTES

- REFER TO DRAWING 1731\_C0002 FOR GENERAL NOTES AND SPECIFICATIONS.
- METAL ELEMENTS SHALL BE PAINTED WHITE TO MATCH THE EXISTING HERITAGE COLOUR AT THE SITE. A RELEVANT ARCHITECTURAL PAINT REPRESENTATIVE SHALL CONFIRM THE COLOUR AND SHEEN LEVEL PRIOR TO PAINTING.
- ALL EXISTING WELLS TO BE CLEANED UP AND EXISTING DRAINAGE TO BE FREE OF DEBRIS AND LEAVES.

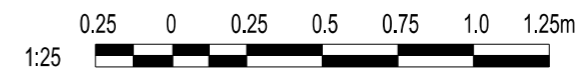

FINAL DESIGN

NOT FOR CONSTRUCTION

10:44:56 AM  
2/07/2024

Revised By	In Serv	Rev.	Date	Description	Designed	Checked	Ind. Review	Approved
KINSLEY GROUP		C	02/07/24	FINAL DESIGN - ISSUED FOR REVIEW	M JOHNSTONE	A SIM	D ZHANG	A SIM
KINSLEY GROUP		B	14/06/24	FINAL DESIGN - ISSUED FOR REVIEW	M JOHNSTONE	A SIM	D ZHANG	A SIM
KINSLEY GROUP		A	22/03/24	PRELIMINARY DESIGN - ISSUED FOR REVIEW	M JOHNSTONE	A SIM	D ZHANG	A SIM

Consultant  
**KINSLEY GROUP**  
 www.kinsleygroup.com.au  
 Franchisee / Lessee

This drawing has been prepared by, or compiled from information provided by, persons other than PTV. To the maximum extent permissible by law, PTV takes no responsibility for, and makes no representations in relation to, the completeness, accuracy or quality of any information contained in this drawing. Each user of this drawing releases PTV from all and any loss, damage, cost, expense or liability in relation to the use of, or any reliance on, this drawing or the information contained in it.

All written dimensions take precedence over scaled dimensions.

This drawing is provided only for the information of the person or organisation to whom PTV provides it. It may not be provided to, or used by, any other person without PTV's prior written consent.

**CIVIL STRUCTURAL**  
**BALLARAT**  
 HERITAGE GATES RENEWAL  
 LYDIARD STREET - 118.923km  
 TYPICAL CROSS SECTIONS - SHEET 3

Up Location East. North. ID#	Down Location East. North. ID#	Datum MGA Z54
------------------------------	--------------------------------	---------------

**PUBLIC TRANSPORT VICTORIA**

File Name 1731\_C0017.dgn  
 Sheet No. 01 of 01  
 In Serv.  
 Scale 1:25 Sheet Size A3

Drawn By M JOHNSTONE	Designed By M JOHNSTONE
Checked By A SIM	Ind. Review D ZHANG
Approved A SIM	Approval Date 02/07/24
Drawing Number 1731_C0017	Revision C

(DATE)

(SIGNATURE)

(BLOCK LETTERS)

Certified By:

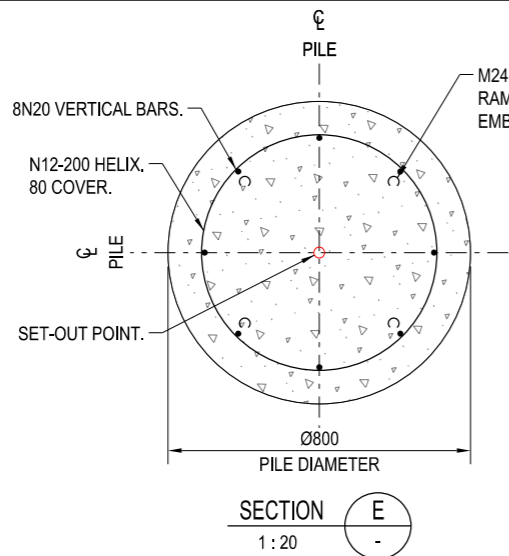

M24 BOLTS TO BE FIXED INTO FOOTING USING RAMSET CHEMSET 502 WITH MINIMUM EMBEDMENT DEPTH OF 250mm. REFER TO NOTE 5.

250mm x 150mm x 10mm THK. GALVANISED STEEL PLATE. REFER TO NOTE 4.

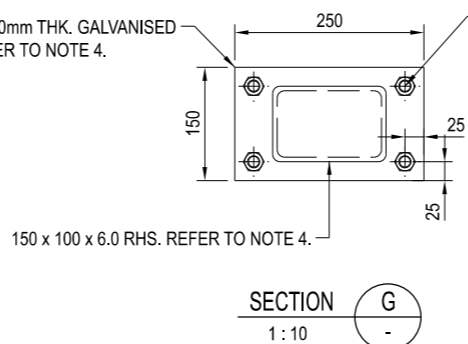

M16 BOLTS TO BE FIXED INTO FOOTING USING RAMSET CHEMSET 502 WITH MINIMUM EMBEDMENT DEPTH OF 125mm.

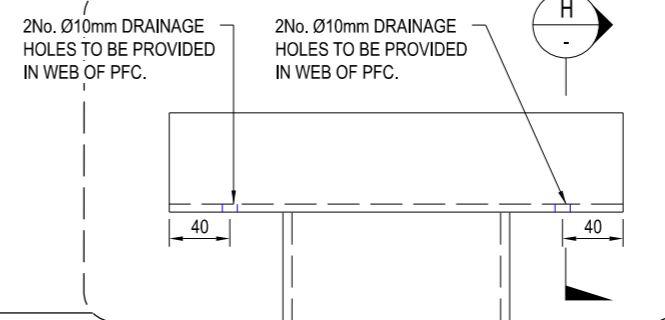

2No. Ø10mm DRAINAGE HOLES TO BE PROVIDED IN WEB OF PFC.

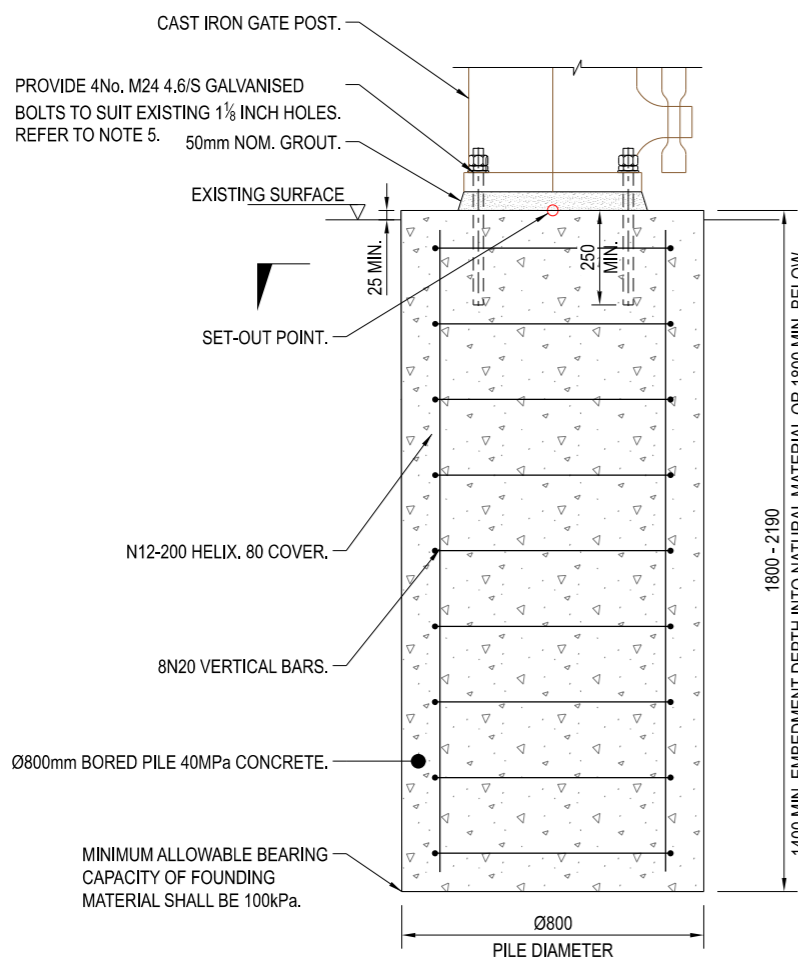

PROVIDE 4No. M24 4.6/S GALVANISED BOLTS TO SUIT EXISTING 1 1/8 INCH HOLES. REFER TO NOTE 5. 50mm NOM. GROUT.

EXISTING SURFACE

SET-OUT POINT.

N12-200 HELIX, 80 COVER.

8N20 VERTICAL BARS.

Ø800mm BORED PILE 40MPa CONCRETE.

MINIMUM ALLOWABLE BEARING CAPACITY OF FOUNDING MATERIAL SHALL BE 100kPa.

GATE POST FOOTING DETAILS



1800 - 2190  
1400 MIN. EMBEDMENT DEPTH INTO NATURAL MATERIAL OR 1800 MIN. BELOW EXISTING SURFACE LEVEL, WHICHEVER IS DEEPER.

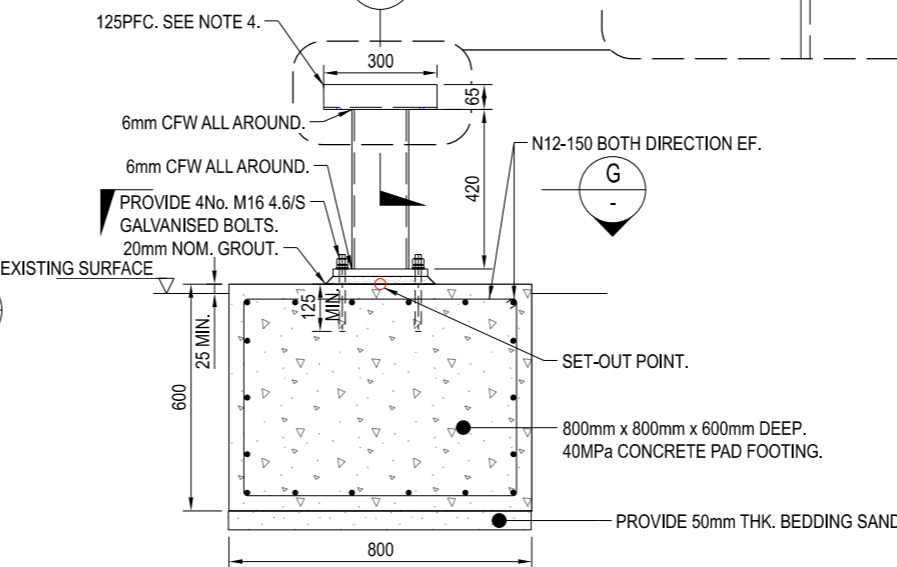

6mm CFW ALL AROUND.

6mm CFW ALL AROUND.

EXISTING SURFACE

PROVIDE 4No. M16 4.6/S GALVANISED BOLTS. 20mm NOM. GROUT.

125PFC. SEE NOTE 4.

600

25 MIN.

125 MIN.

420

300

65

40MPa CONCRETE PAD FOOTING.

800mm x 800mm x 600mm DEEP.

PROVIDE 50mm THK. BEDDING SAND.

800

25 MIN.

600

125

65

110

67\*

125PFC. SEE NOTE 4.

65

125

110

67\*

125

65

125

65

125

65

125

65

125

65

125

65

125

65

125

65

125

65

125

65

125

65

125

65

125

65

125

65

125

65

125

GATE SUPPORT FOOTING DETAILS

SCALE 1:20

PROVIDE F7 GRADE HARDWOOD PACKERS BETWEEN BOLTS TO FILL GAP IN BETWEEN PLATE AND BOTTOM RAIL. HARDWOOD SHALL BE TREATED IN ACCORDANCE WITH AS1604.1 - H3 TREATMENT.

125PFC. SEE NOTE 4.

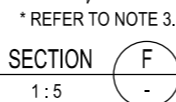

\* REFER TO NOTE 3.

**BORED PILE NOTES**

- B1. FOR GENERAL NOTES AND SPECIFICATIONS REFER TO DRAWING 1731\_C0002.
- B2. THE BASE OF THE EXCAVATION SHALL BE CLEARED OF ALL LOOSE AND DISTURBED MATERIAL PRIOR TO PLACING CONCRETE. CARE SHALL BE TAKEN TO PREVENT LOOSE SURFACE MATERIAL FROM FALLING INTO THE EXCAVATION.
- B3. THE PILE HOLES SHALL BE KEPT FREE OF WATER AT ALL TIMES BY BAILING OR PUMPING.
- B4. CONCRETE COMPRESSIVE STRENGTH AT 28 DAYS SHALL BE  $f_c = 40\text{MPa}$ .
- B5. BAR CHAIRS MUST BE SUFFICIENTLY ROBUST AND INSTALLED IN SUFFICIENT NUMBER TO RESIST THE WEIGHT OF PILE REINFORCEMENT AS IT BEARS AGAINST THE EXCAVATION. BAR CHAIRS SHALL POSSESS SUFFICIENT BASE AREA TO RESIST DEPRESSING INTO THE EXCAVATION THEREBY REDUCING CONCRETE COVER.
- B6. A GEOTECHNICAL ENGINEER SHALL INSPECT THE EXCAVATION BEFORE THE INTRODUCTION OF PILE REINFORCEMENT AND SHALL CONFIRM:
  - a. THE FOUNDING LEVELS ARE ACHIEVED.
  - b. THE PILE LOADINGS CAN BE ACHIEVED.
  - c. THE ALLOWABLE END BEARING PRESSURE IS ACHIEVED.
  - d. WHETHER TEMPORARY STEEL CASING IS REQUIRED.
- B7. ALL PILES ARE VERTICAL AND SHALL BE INSTALLED IN ACCORDANCE WITH AS 2159-2009 'PILING DESIGN & INSTALLATION' AND THE PROJECT SPECIFICATION.
- B8. PILE SET-OUT POINTS ARE TO CENTRE OF PILE AND TOP OF PILE.
- B9. NDD WORKS SHALL BE UNDERTAKEN PRIOR TO DRILLING TO ENSURE THE PILE WILL NOT CLASH WITH ANY EXISTING SERVICES.
- B10. CONCRETE SHALL BE PLACED AS SOON AS POSSIBLE AFTER BORING AND AFTER FOUNDING LEVEL AND MATERIAL HAS BEEN VERIFIED BY A QUALIFIED GEOTECHNICAL ENGINEER AND OBTAINED REQUIRED APPROVAL FROM THE PRINCIPAL IF NECESSARY. TEMPORARY LINING SHALL BE USED TO PREVENT ANY WATER LEAKAGE & SOIL COLLAPSE WHERE NECESSARY.
- B11. CONCRETE MUST BE PLACED THROUGH A TREMIE TUBE AND MUST NOT BE DROPPED FROM A HEIGHT GREATER THAN 1m THROUGH AIR. CONCRETE WHICH IS BEING DISCHARGED FROM A TREMIE MUST BE POSITIVELY GUIDED AWAY FROM THE PILE REINFORCEMENT SO THAT SEGREGATION IS NOT CAUSED BY THE FLOW OF CONCRETE IMPINGING ON THE REINFORCEMENT.
- B12. THE BORED PILE HAS BEEN CALCULATED BASED ON AN ASSUMED FILL DEPTH OF 400mm.

**NOTES**

1. REFER TO DRAWING 1731\_C0002 FOR GENERAL NOTES AND SPECIFICATIONS. SCALE 1:20
2. ALL DIMENSIONS ARE IN MILLIMETRES UNLESS NOTED OTHERWISE.
3. DIMENSIONS OF BOTTOM RAIL OF RESTORED GATE TO BE CONFIRMED PRIOR TO FABRICATION TO ENSURE FLUSH ALIGNMENT.
4. METAL ELEMENTS SHALL BE PAINTED WHITE TO MATCH THE EXISTING HERITAGE COLOUR AT THE SITE. A RELEVANT ARCHITECTURAL PAINT REPRESENTATIVE SHALL CONFIRM THE COLOUR AND SHEEN LEVEL PRIOR TO PAINTING.
5. HOLE SIZE TO BE CONFIRMED PRIOR TO FABRICATION.
6. NATURAL MATERIAL HAS BEEN ASSUMED TO CONSISTS OF SOFT CLAYS AND SILTS AND SHALL BE 1:5 VERIFIED ON-SITE BY CONSTRUCTION CONTRACTOR.

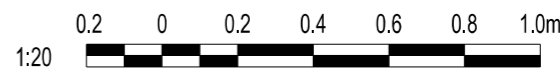

FINAL DESIGN  
NOT FOR CONSTRUCTION

Revised By	In Serv	Rev.	Date	Description	Designed	Checked	Ind. Review	Approved
KINSLEY GROUP		C	02/07/24	FINAL DESIGN - ISSUED FOR REVIEW	M JOHNSTONE	A SIM	D ZHANG	A SIM
KINSLEY GROUP		B	14/06/24	FINAL DESIGN - ISSUED FOR REVIEW	M JOHNSTONE	A SIM	D ZHANG	A SIM
KINSLEY GROUP		A	22/03/24	PRELIMINARY DESIGN - ISSUED FOR REVIEW	M JOHNSTONE	A SIM	D ZHANG	A SIM

Consultant  
**KINSLEY GROUP**  
www.kinsleygroup.com.au  
Franchisee / Lessee  
**V/Line**

This drawing has been prepared by, or compiled from information provided by, persons other than PTV. To the maximum extent permissible by law, PTV takes no responsibility for, and makes no representations in relation to, the completeness, accuracy or quality of any information contained in this drawing. Each user of this drawing releases PTV from all and any loss, damage, cost, expense or liability in relation to the use of, or any reliance on, this drawing or the information contained in it.

All written dimensions take precedence over scaled dimensions.

This drawing is provided only for the information of the person or organisation to whom PTV provides it. It may not be provided to, or used by, any other person without PTV's prior written consent.

**CIVIL STRUCTURAL**  
**BALLARAT**  
HERITAGE GATES RENEWAL  
LYDIARD STREET - 118.923km  
TYPICAL DETAILS - SHEET 1

Up Location East. North. ID#	Down Location East. North. ID#	Datum MGA Z54
------------------------------	--------------------------------	---------------

**PUBLIC TRANSPORT VICTORIA** **PTV**

File Name 1731\_C0021.dgn  
Sheet No. 01 of 01  
In Serv.  
Scale VARIES Sheet Size A3

Drawn By M JOHNSTONE	Designed By M JOHNSTONE
Checked By A SIM	Ind. Review D ZHANG
Approved A SIM	Approval Date 02/07/24
Drawing Number 1731_C0021	Revision C

10:45:09 AM  
2/07/2024



(DATE)

(SIGNATURE)

(BLOCK LETTERS)

Certified By:

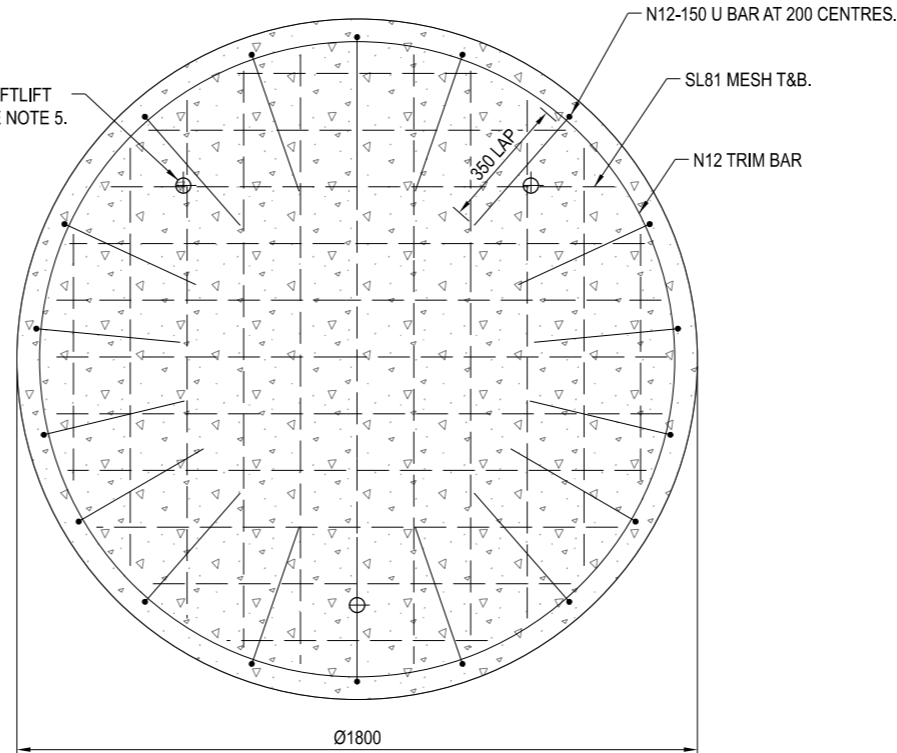

SECTION I  
1 : 20

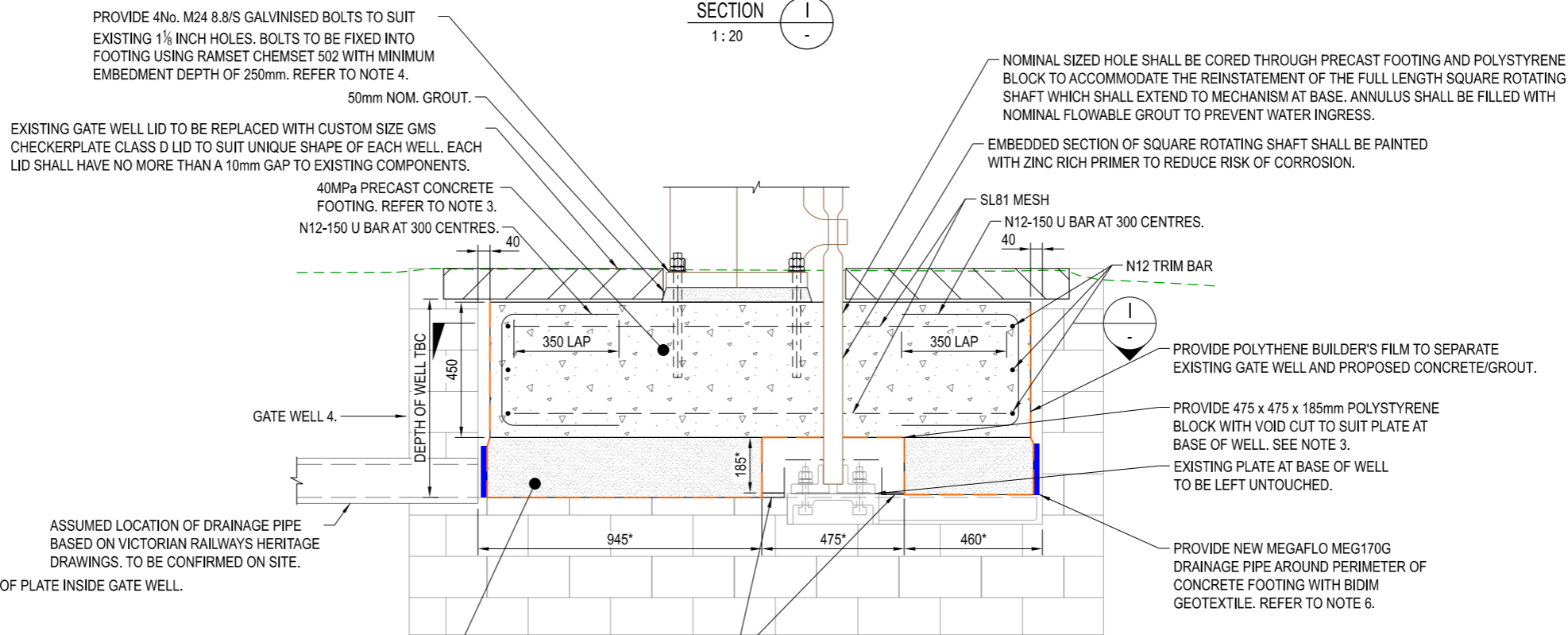

DETAIL 1  
1 : 20  
C0017

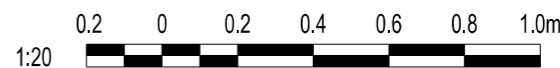

**FINAL DESIGN**  
**NOT FOR CONSTRUCTION**

**NOTES**

- REFER TO DRAWING 1731\_C0002 FOR GENERAL NOTES AND SPECIFICATIONS.
- ALL DIMENSIONS ARE IN MILLIMETRES UNLESS NOTED OTHERWISE.
- EXISTING DIMENSIONS OF GATE WELL TO BE CONFIRMED PRIOR TO FABRICATION OF CONCRETE FOOTING TO ENSURE PROPOSED DESIGN DIMENSIONS SUIT.
- HOLE SIZE TO BE CONFIRMED PRIOR TO FABRICATION.
- LIFTING ANCHORS TO BE DESIGNED BY THE FABRICATOR TO SUIT LIFTING AND TRANSPORTATION REQUIREMENTS. ESTIMATED UNIT WEIGHT IS 3 TONNES.
- MEGAFLO STRIP DRAIN SHALL NOT EXTEND ABOVE BASE OF PRECAST CONCRETE BLOCK.
- ALL EXISTING WELLS TO BE CLEANED UP AND EXISTING DRAINAGE TO BE FREE OF DEBRIS AND LEAVES.

FILL BASE OF WELL WITH CONBEXTRA DEEP POUR GROUT TO TOP OF POLYSTYRENE BLOCK.  
THIN LAYER OF GROUT MAY BE PROVISIONED UNDER POLYSTYRENE BLOCK TO ENSURE FLAT SURFACE.

Revised By	In Serv	Rev.	Date	Description	Designed	Checked	Ind. Review	Approved
KINSLEY GROUP		C	02/07/24	FINAL DESIGN - ISSUED FOR REVIEW	M JOHNSTONE	A SIM	D ZHANG	A SIM
KINSLEY GROUP		B	14/06/24	FINAL DESIGN - ISSUED FOR REVIEW	M JOHNSTONE	A SIM	D ZHANG	A SIM
KINSLEY GROUP		A	22/03/24	PRELIMINARY DESIGN - ISSUED FOR REVIEW	M JOHNSTONE	A SIM	D ZHANG	A SIM

Consultant  
**KINSLEY GROUP**  
www.kinsleygroup.com.au  
Franchisee / Lessee  
**V/Line**

This drawing has been prepared by, or compiled from information provided by, persons other than PTV. To the maximum extent permissible by law, PTV takes no responsibility for, and makes no representations in relation to, the completeness, accuracy or quality of any information contained in this drawing. Each user of this drawing releases PTV from all and any loss, damage, cost, expense or liability in relation to the use of, or any reliance on, this drawing or the information contained in it.  
All written dimensions take precedence over scaled dimensions.  
This drawing is provided only for the information of the person or organisation to whom PTV provides it. It may not be provided to, or used by, any other person without PTV's prior written consent.

**CIVIL STRUCTURAL**  
**BALLARAT**  
HERITAGE GATES RENEWAL  
LYDIARD STREET - 118.923km  
TYPICAL DETAILS - SHEET 2

Up Location East. North. ID#	Down Location East. North. ID#	Datum MGA Z54
---------------------------------------	---	------------------

**PUBLIC TRANSPORT VICTORIA** **PTV**

File Name 1731\_C0022.dgn  
Sheet No. 01 of 01  
In Serv.  
Scale 1:20  
Sheet Size A3

Drawn By M JOHNSTONE	Designed By M JOHNSTONE
Checked By A SIM	Ind. Review D ZHANG
Approved A SIM	Approval Date 02/07/24
Drawing Number <b>1731_C0022</b>	Revision <b>C</b>

10:45:11 AM  
2/07/2024